

November 9, 1972

Mr. Joseph R. Silva
Gentry-Hawaiiana Associates, J.V.
146 Hekili Street
Kailua, Oahu 96734

Dear Mr. Silva:

The petition by Gentry-Hawaiiana Associates, J.V. (A72-325) to amend the land use district boundaries from the Agricultural District to the Urban District at Kukuau 2nd, South Hilo, Hawaii, was approved in concept on an incremental zoning basis, and approximately 167 acres, as recommended by staff, identifiable by Tax Map Key 2-5-46: portions of 1 and 3, were reclassified into the Urban District by the Land Use Commission at its meeting on November 3, 1972; and upon demonstration of substantial performance by the petitioner within 3 years, the remaining estimated 123 acres will be considered for reclassification into the Urban District.

Prior to taking action on this petition, the enclosed memorandum was presented to the Commission.

For your information, we are enclosing herewith a copy of Section 2.33, "Performance Time", of the Rules and Regulations of the Commission.

Very truly yours,

TATSUO FUJIMOTO
Executive Officer

Encls.

cc: Hawaii Planning Dept.
Dept. of Water Supply, Hawaii
Hawaii District Office, Dept. of Tax.
Property Technical Services, Dept. of Tax.
Tax Maps Branch, Dept. of Tax.
Chairman of the Board, DLNR
Planning Office, DLNR
Facilities & Aux. Svcs. Br., DOE
Director, Dept. of Transp.
Planning Branch, DAGS
Planning Branch, DPED
Land Use Commissioners
Paul Tajima

TRUE NORTH
1" = 400'

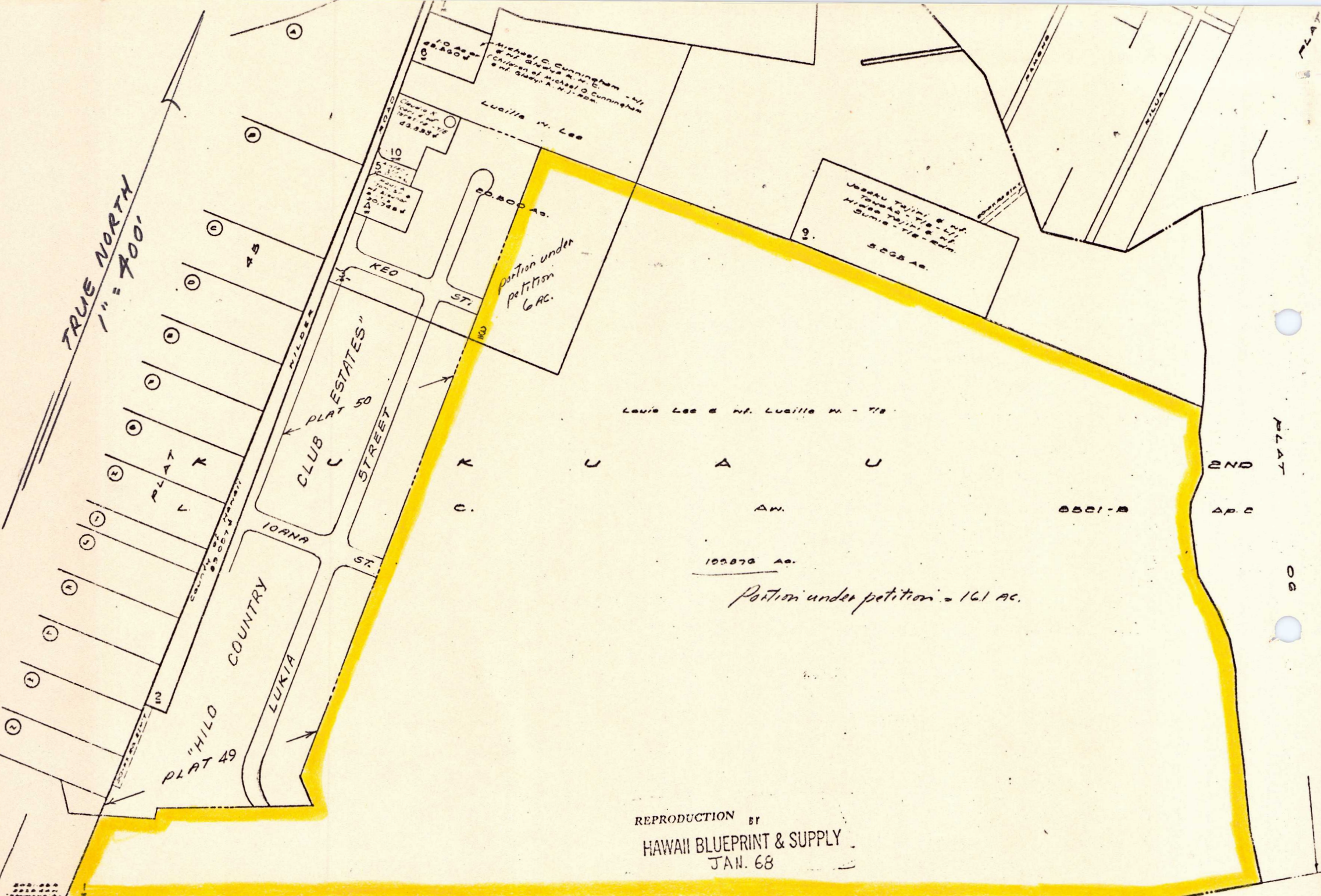

portion under
petition
6 AC.

portion under petition = 161 AC.

REPRODUCTION BY
HAWAII BLUEPRINT & SUPPLY
JAN. 68

K U ZONE K U A SEC U 4 1ST
LD. CT. APP. 1208

FOR PROPERTY ASSESSMENT PURPOSES
SUBJECT TO CHANGE