

OFFICE OF

Facilities and Operations

Kūlanihāko‘i High School

Project Status Update

Land Use Commission Meeting
Kīhei Community Center
Thursday, Feb. 9, 2023

Keith Hayashi

Superintendent

(808) 784-6161, keith.hayashi@k12.hi.us

Curt Otaguro

Deputy Superintendent

(808) 784-6161, curt.otaguro@k12.hi.us



Kūlanihāko'i High School - Aerial View





Kūlanihāko'i High School - Aerial View





Kūlanihāko'i High School - Aerial View





Kūlanihāko‘i High School - Aerial View





Kūlanihāko‘i High School - Construction



Construction begins on new buildings and key facilities (Jan. 2021)



Kūlanihāko'i High School - Construction



Classroom Bldg. B exterior walls and foundations under construction (Apr. 2021)



Kūlanihāko‘i High School - Construction



Bldg. B construction continues (July 2021)



Kūlanihāko‘i High School - Construction





Kūlanihāko‘i High School - Construction



Beams with roof decking on Classroom Building B (Mar. 2022)



Kūlanihāko‘i High School - Construction





Kūlanihāko‘i High School - Construction



Setting CMU blocks at Bldg. C (May 2021)



Kūlanihāko‘i High School - Construction





Kūlanihāko‘i High School - Construction





Kūlanihāko'i High School - Construction





Kūlanihāko‘i High School - Construction





Kūlanihāko‘i High School - Construction



Building D – Library & Dining Hall (Jan. 2023)



Kūlanihāko'i High School - Construction



Hot Water Heaters at Bldg H - PE Locker Rooms & beginning of outdoor court
(June 2022)



Kūlanihāko‘i High School - Construction



01 16 2023

Bldg H – PE Locker Rooms with fenced courts off to left (Jan 2023)



Kūlanihāko‘i High School - Rainfall 01/27/23





Kūlanihāko‘i High School - Rainfall 01/27/23





Kūlanihāko'i High School - Rainfall 01/27/23





Kūlanihāko'i High School - Rainfall 01/27/23





Kūlanihāko'i High School - Rainfall 01/27/23





Kūlanihāko‘i High School - Rainfall 01/27/23



Waipuilani Gulch
south of site

01 27 2023



Kūlanihāko'i High School - Rainfall 01/27/23



Waipuilani Gulch
south of site

01 27 2023



Kūlanihāko'i High - Pi'ilani Hwy Roundabout





Kūlanihāko‘i High - Pedestrian Overpass

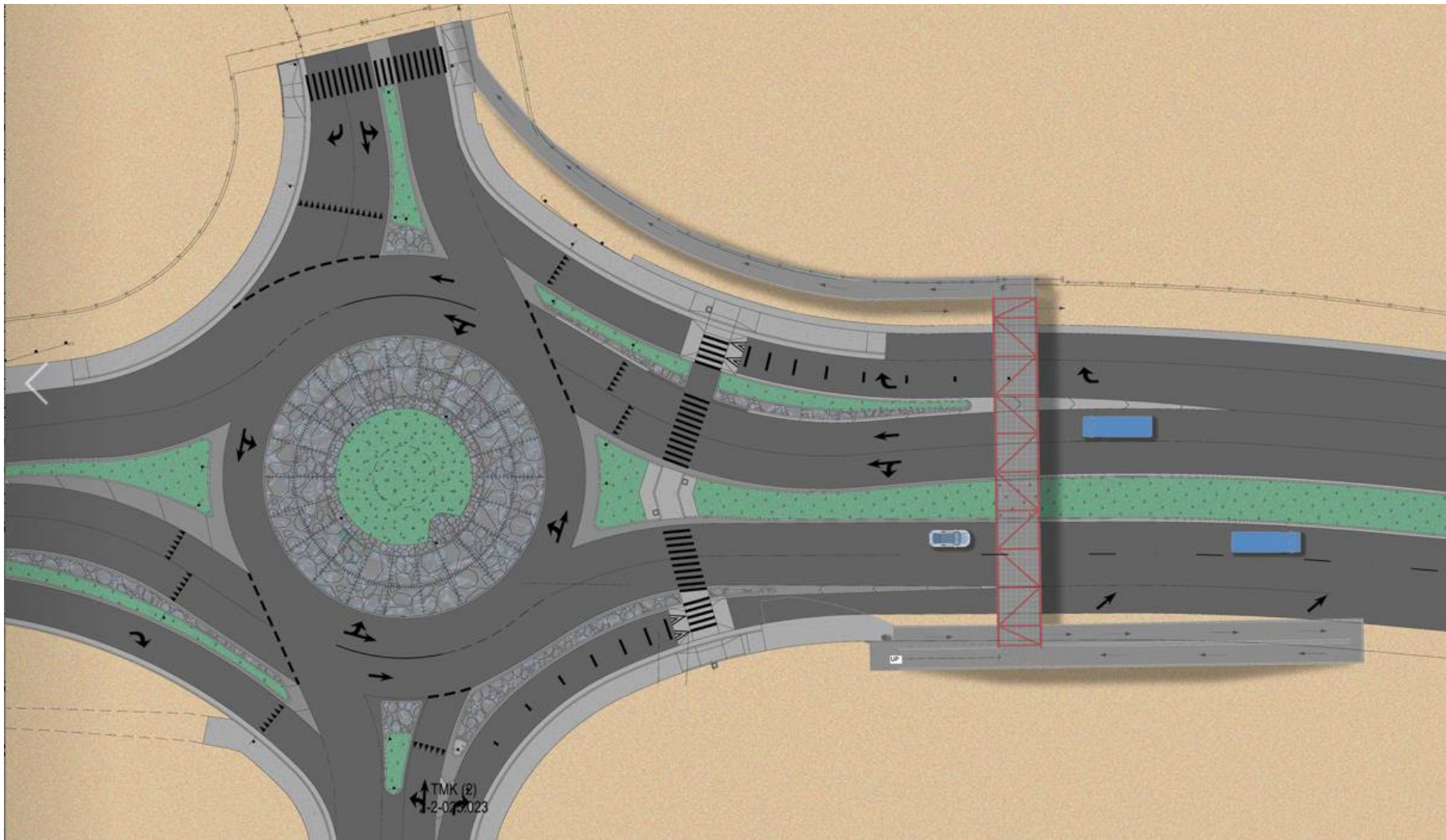



Kūlanihāko‘i High - Pedestrian Overpass

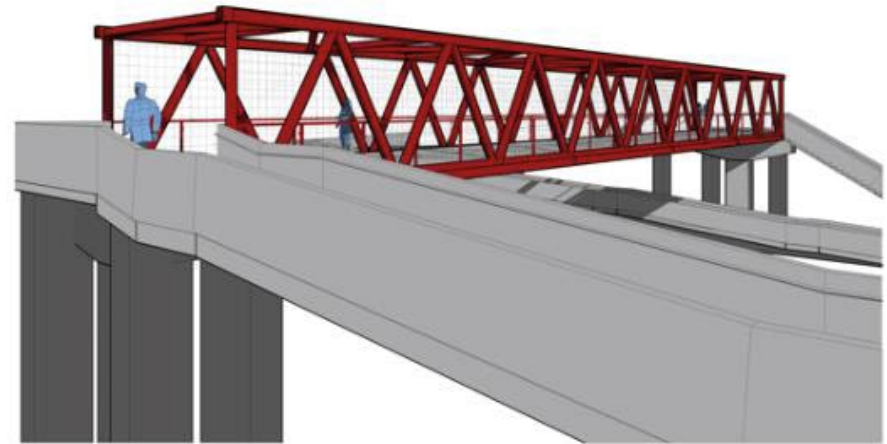
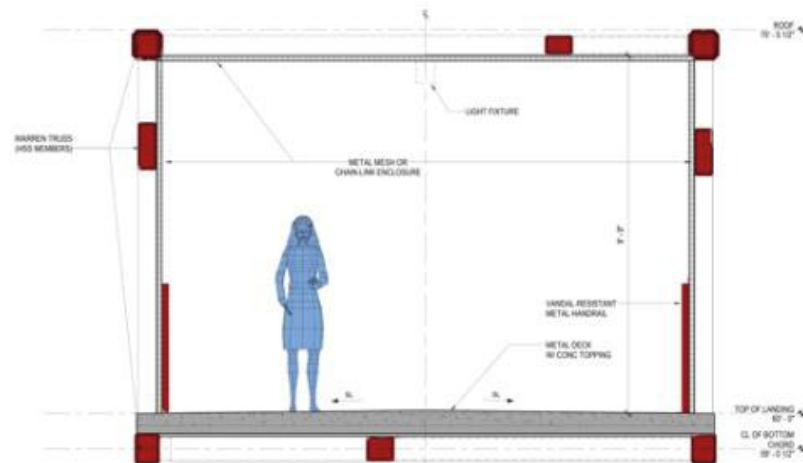
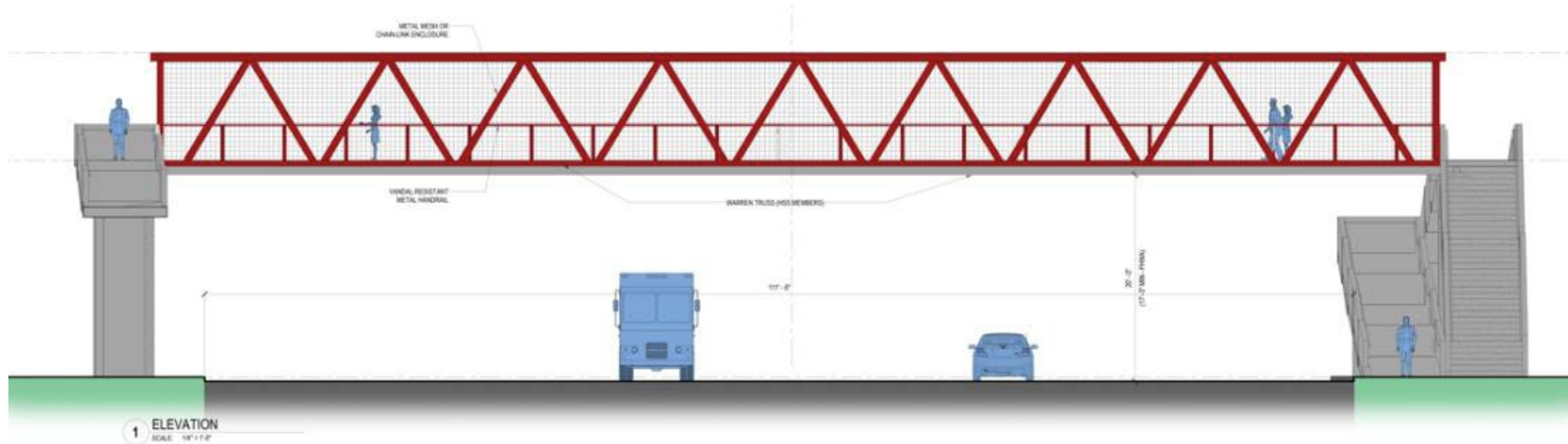



Kūlanihāko'i High - Pedestrian Overpass

Makai side structure (stairs and ramp)

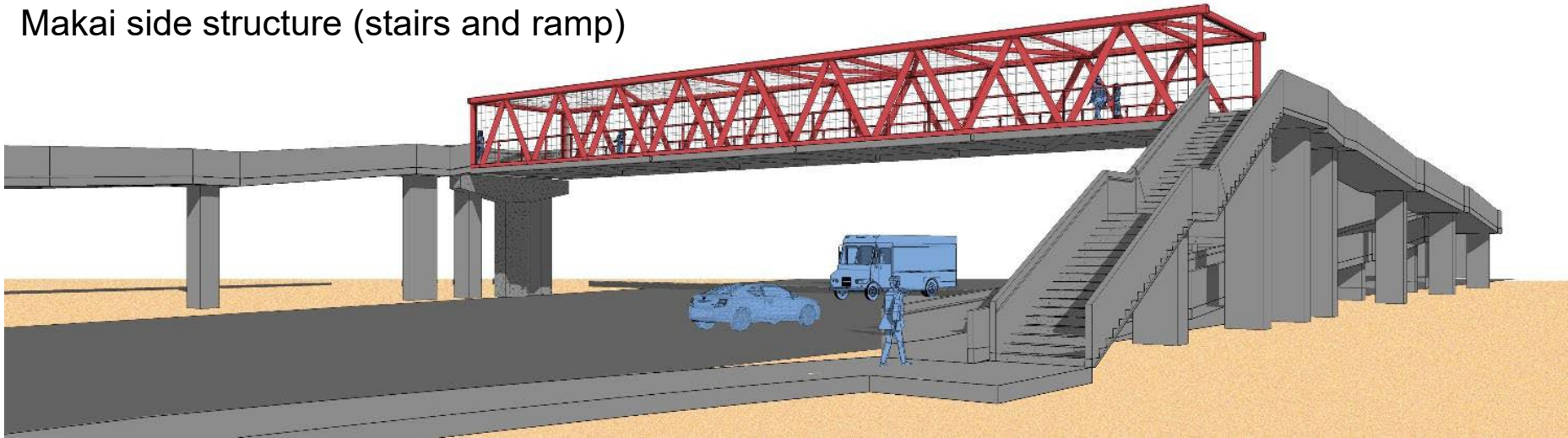

Mauka side structure (ramp)





Questions?



Mahalo