

STATE OF HAWAII

DEPARTMENT OF PLANNING AND ECONOMIC DEVELOPMENT
LAND USE COMMISSION

P. O. BOX 2359 • HONOLULU, HAWAII 96804

JOHN A. BURNS
Governor

SHELLEY M. MARK
Director Department
of Planning and Economic
Development

~~GORO INABA~~

~~WILBERT H. O. CHOI~~

Commission Chairman

~~EDDIE TANGEN~~

~~Goro Inaba~~

Vice Chairman

TATSUO FUJIMOTO

~~RAMON DURAN, AIA, ACLA~~

Executive Officer

September 9, 1971

TO WHOM IT MAY CONCERN:

At its meeting on September 2, 1971, the Land Use Commission considered petition A71-287 initiated by the Commission and voted to affirm the zoning of the following parcels that were rezoned during the 1969 five-year boundary review, which are located within the County of Hawaii.

COMMISSION MEMBERS

Alexander J. Napier

Shelley M. Mark

Sunao Kido

~~Eddie Tangen~~

Leslie E. L. Wung

Tanji Yamamura

Stanley S. Sakahashi

The two areas described below are subject to this action:

Retain in the Conservation District - 52 acres at Puu Kohola Heiau, Hawaii

<u>Tax Map Key</u>	<u>Owner</u>	<u>Acres</u>
6-2-02: 9		
6-2-02: 10		
6-2-02: 6 (portion)	Queen's Medical	Total of approximately
6-2-01: 64 (portion)	Center	45 Acres
6-1-03: 25 & 30	State of Hawaii	Total of approximately
		7 Acres

Retain in the Urban District - 112.5 Acres at Kahului, Hawaii

<u>Tax Map Key</u>	<u>Owner</u>	<u>Acres</u>
7-5-19: 1	Aloha Maui, Inc. James P. Ferry & wf. Anthony R. Paul & wf.	81.1 Acres
7-5-19: 5	Joseph Gomes	31.4 Acres

Should you have any questions regarding the above action, please feel free to write us.

Very truly yours,

TATSUO FUJIMOTO
Executive Officer

Enc. - Maps

A71-287 44

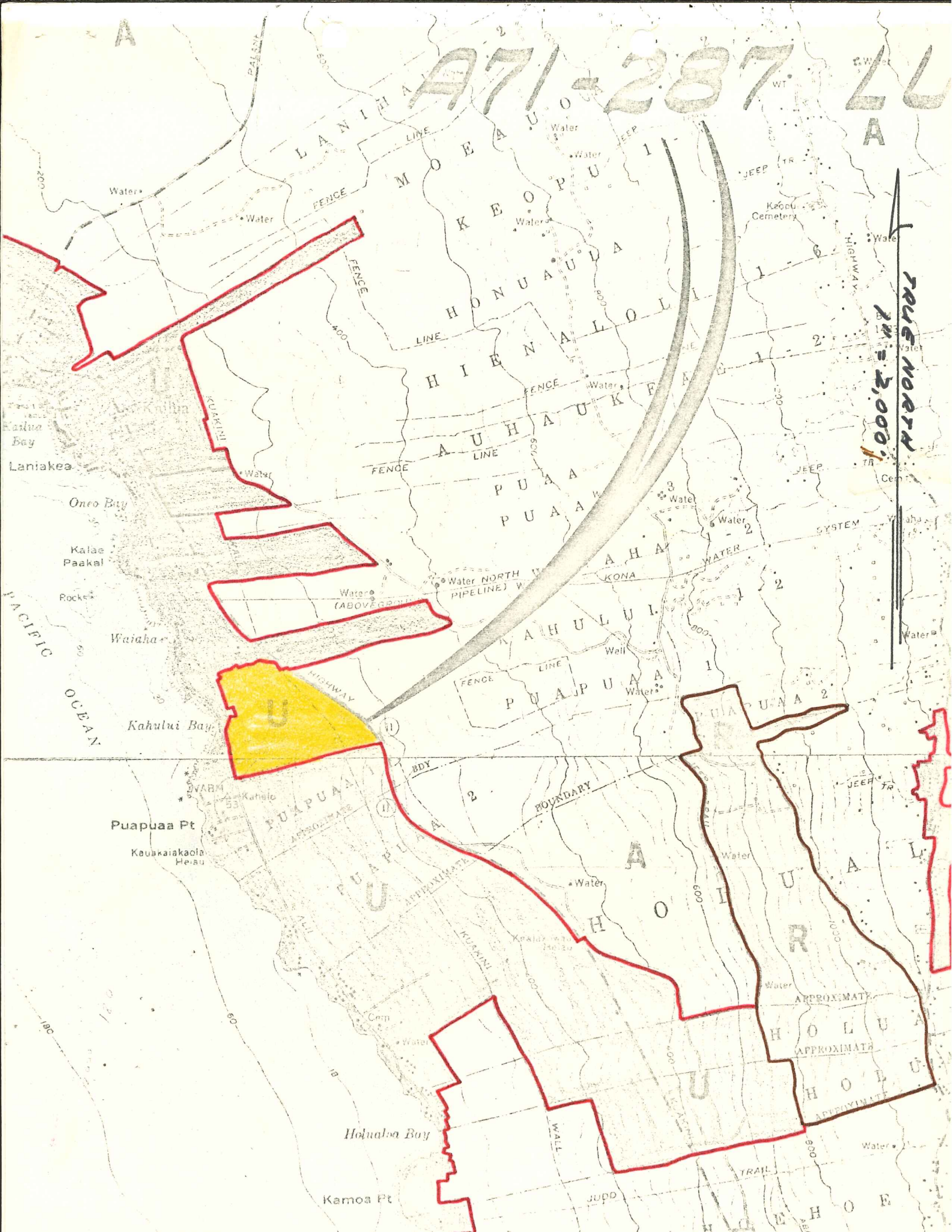

SCALE NORTH
2,000'

PACIFIC OCEAN

LANIHALE
MOEAO
K E O P U
H O N U A U L A
H I E N A L O L I
A U H A U K F
P U A A
P U A A

Kailua Bay
Laniakea
Ono Bay
Kalae Paakai
Rocks
Waiaha
Kahului Bay

U

Puapua Pt
Kauakaiaoa Heiau

NAHULULI
P U A P U A A
H O I U A L
H O L U A
H O L U
KAMO A P T

Holualoa Bay

Kamo Pt

AT 02
31 100 AC. (within P 52)

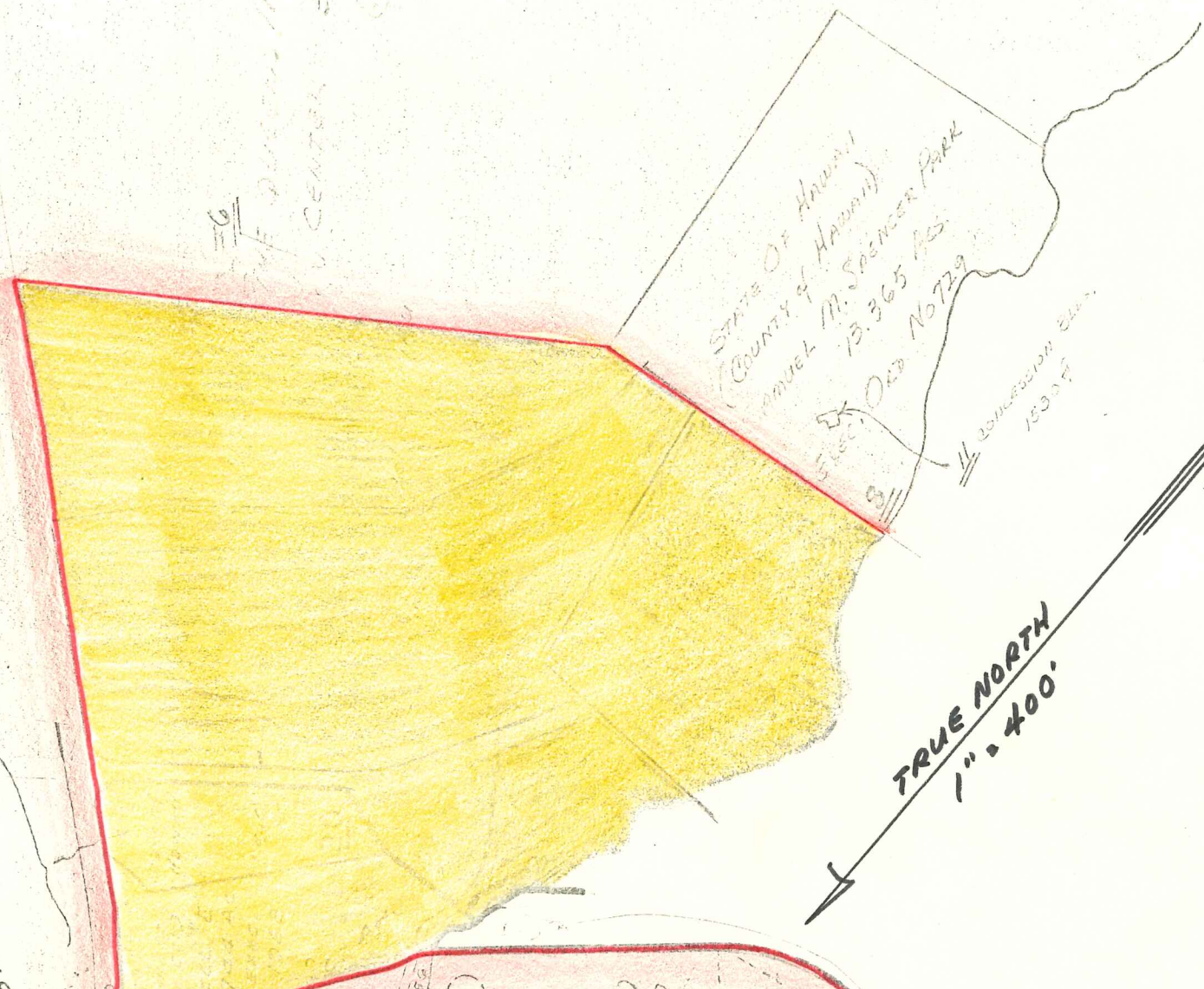

STATE CENTER 273.73
(346.742)

STATE OF HAWAII
COUNTY OF HAWAII
MUEL M. SCIENCER PARK
13.365 AC
ELEC. ORD No 729

TRUE NORTH
1" = 400'

STATE OF HAWAII
DEPT. OF TRANS.
HARBOR DIV.
ELEC. ORD
(24.01 AC.)
(FILLED AREA)

1904
(22.0 AC)(P1)
(FILLED AREA)

HARBOR PROJECT

STATE OF HAWAII
DEPT. OF TRANS.
HARBOR DIV.
ELEC. ORD
(24.01 AC.)
(FILLED AREA)

3
753
6 AC.
ACS.

6-1-03