

TOP

Advance Sheet  
No Correction

**PROPOSED LAND USE DISTRICT BOUNDARIES**

--- (C) **PROPOSED**  
 --- (C) **EXISTING**

DISTRICT MAP <b>H-59</b>	STATE OF HAWAII LAND USE COMMISSION DEPT. OF PLANNING & ECONOMIC DEVELOPMENT	DISTRICTS U = URBAN R = RURAL A = AGRICULTURAL C = CONSERVATION
	<b>APRIL 1969</b>	

PAPAALOA QUADRANGLE  
HAWAII—ISLAND AND COUNTY OF HAWAII  
7.5 MINUTE SERIES (TOPOGRAPHIC)  
NW 1/4 HONOLULU 15 QUADRANGLE

UNITED STATES  
DEPARTMENT OF THE INTERIOR  
GEOLOGICAL SURVEY

Exhibit 38  
Proposed and final district  
line 1969 Papaalooa

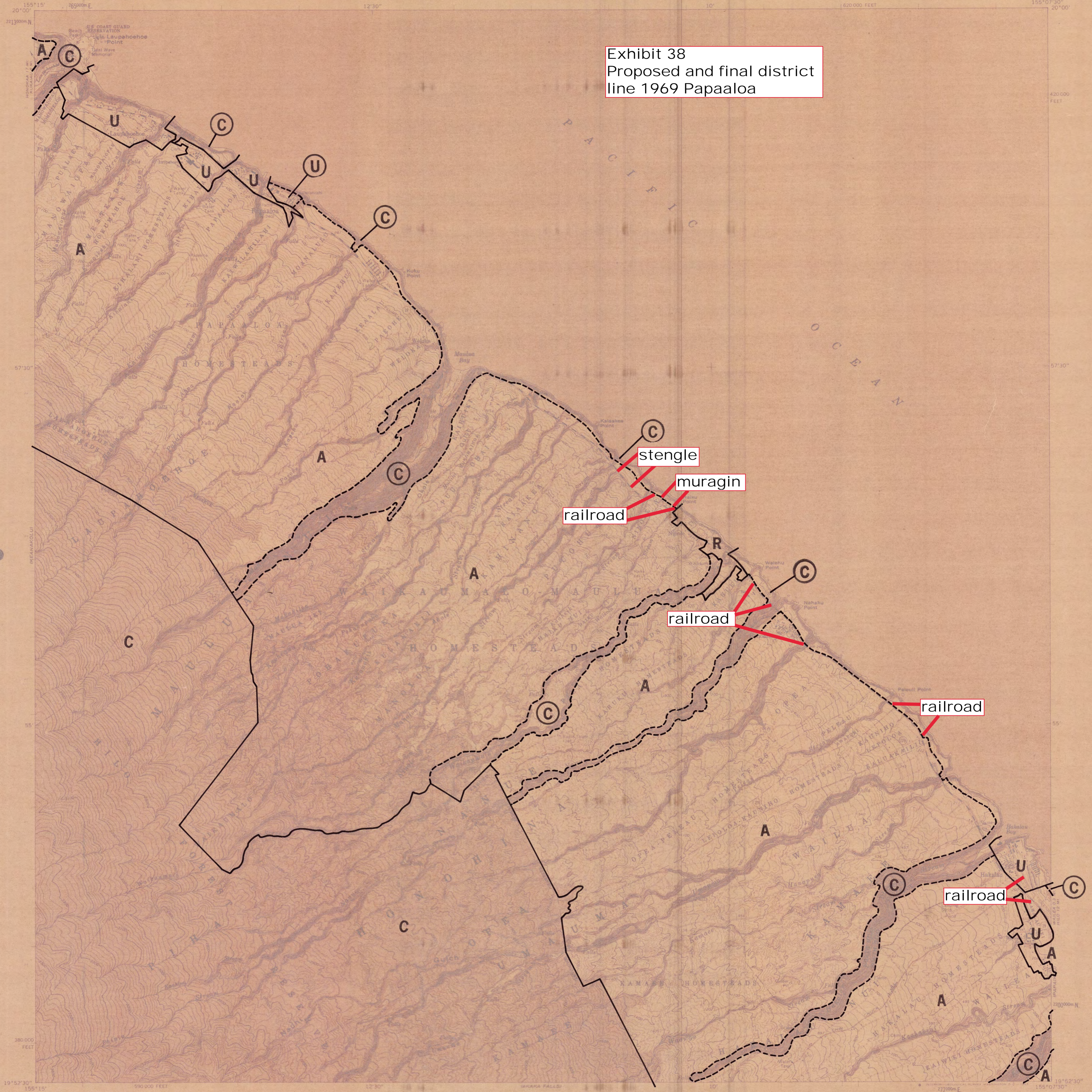

Mapped, edited, and published by the Geological Survey  
Control by USGS and USC&GS  
Topography by photogrammetric methods from aerial  
photographs taken 1954 and 1965. Field checked 1966  
Polyconic projection. Old Hawaiian datum  
10,000-foot grid based on Hawaiian coordinate system, zone 1  
1000-meter Universal Transverse Mercator grid ticks,  
zone 5, shown in blue

APPROXIMATE MEAN  
DECLINATION, 1966

SCALE 1:24,000

CONTOUR INTERVAL 20 FEET  
DATUM IS MEAN SEA LEVEL  
SHORELINE SHOWN REPRESENTS THE APPROXIMATE LINE OF MEAN HIGH WATER  
THE AVERAGE RANGE OF TIDE IS APPROXIMATELY 2 FEET

ROAD CLASSIFICATION  
 Medium-duty ——— Light-duty ———  
 Unimproved dirt ———  
 State Route —○—

**H-59**

PAPAALOOA, HAWAII  
1964 HONOLULU 15 QUADRANGLE  
N 1952.5—W 15507.5/7.5  
1966

FOR SALE BY U.S. GEOLOGICAL SURVEY, DENVER, COLORADO 80225, OR WASHINGTON, D.C. 20242  
A FOLDER DESCRIBING TOPOGRAPHIC MAPS AND SYMBOLS IS AVAILABLE ON REQUEST

H-59

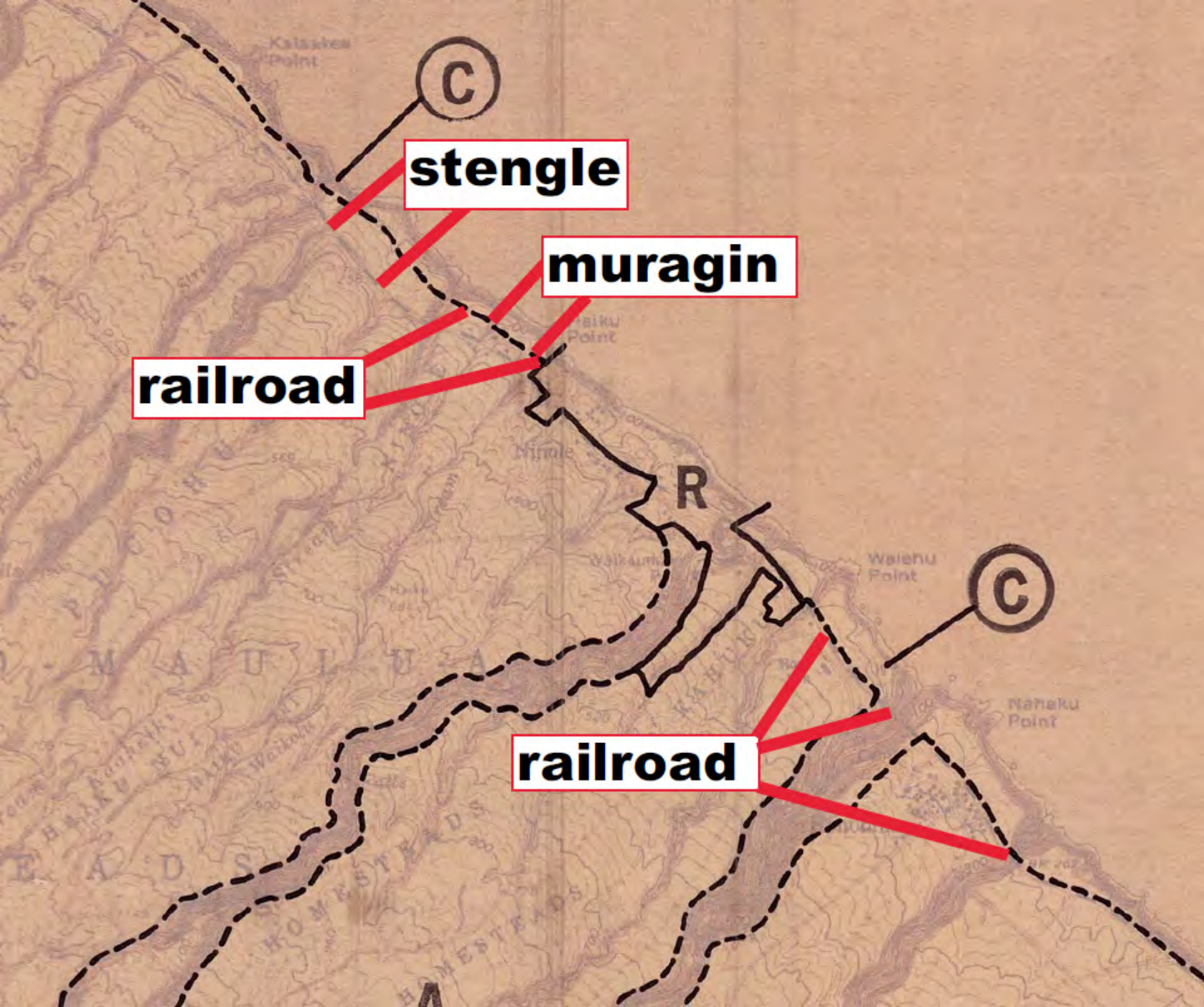

C

stengle

muragin

railroad

R

C

railroad

Hakalau to Kolekole Gulch

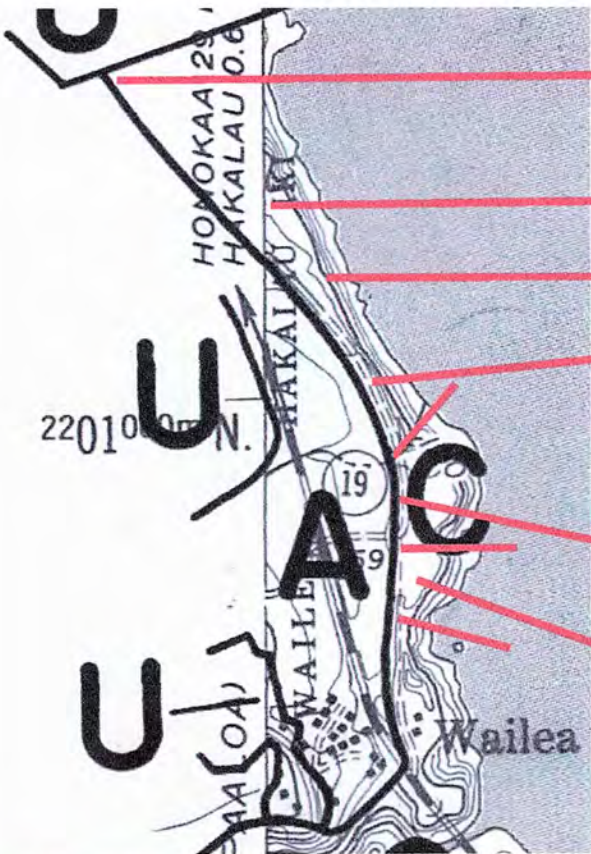

**conservation district  
aprox. 800 ft. inland**

**cons. overlaid 13.35  
acres of cane field**

**top of cliff line**

**former railroad**

**Petitioners' Property**

3.4 acres of cane field - district line 330 ft. inland of the "ridge top" and 430 ft. inland of the high wash of the waves

**lot :013 cane field  
aprox. 1.3 acres**

**total cane field overlaid  
between Hakalau and  
Kolekole approx. 18.05  
acres**



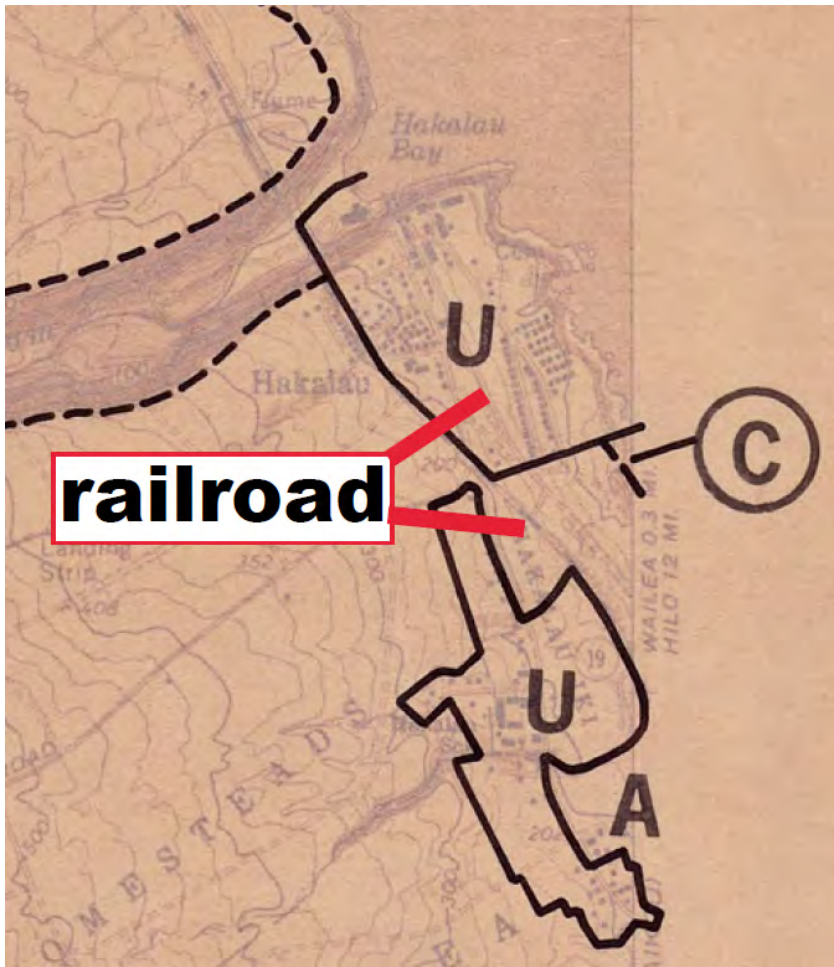

Source, Exhibit 38, Papaaloa Map H-59 1969 Proposed

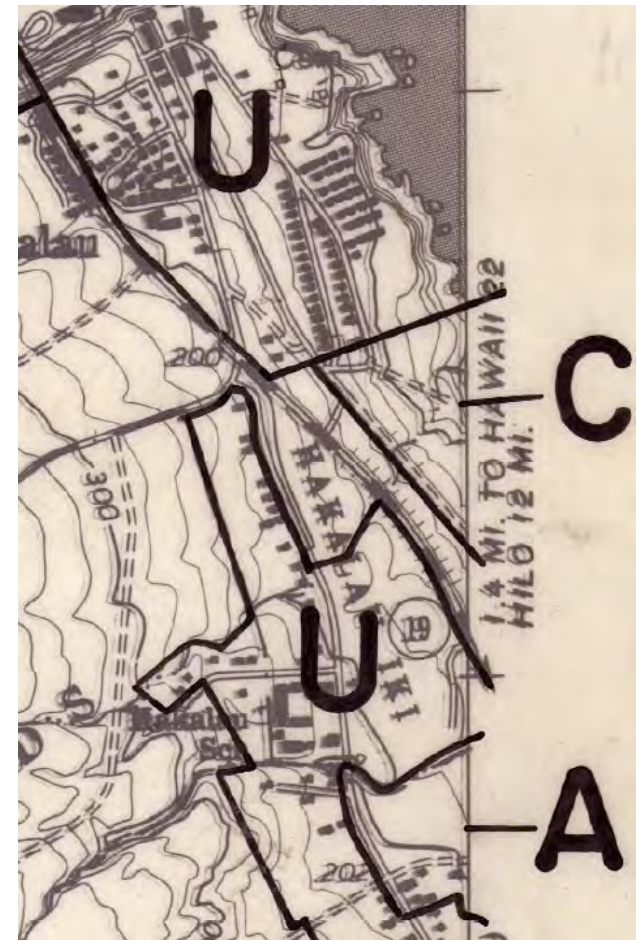

Source, Exhibit 40, 1974 Map H-59

Note: how the district line moved on the 1969 map vs. the 1974 map (see next page)

1           But that's, I think, different than what  
2 the Churches have argued, which is they actually  
3 used the -- they used the cliff boundary here, and  
4 past interpretations have been incorrect.  
5           **MS. KATO:** I'm not sure what they used in  
6 1969. I understand that the -- I believe the maps  
7 were from a later time.  
8           **COMMISSIONER SCHEUER:** Okay.  
9           **MS. KATO:** The maps that were later drawn  
10 based on the report.  
11           **COMMISSIONER SCHEUER:** Yeah. You're  
12 correct. I have nothing further.

Source, Exhibit 5, Hearing Transcript, page 107 (emphasis added)

While the maps were drawn later during the period between 1969 and 1974 lots of errors occurred. The Proposed and Adopted 1969 district line did generally follow the railroad on Map H-59. Then in 1999 the district line was moved makai following DR99-21. Mysteriously, on the 1969 map, when the district line was drawn on to the map it was no longer following the railroad as it led southward from Hilo, but by 1974 the line had moved back to the railroad as it led southward out of Hakalau.

The former railroad bisected Muragin's property. The 1969 district line on the 1969 map located on the railroad land. The district line on the 1974 map, shown (below left), is not where the district line was in 1974 or 1969 (below right). The district line on the 1974 district map was redrawn in 1999 following DR99-21 (Stengle). The former railroad also bisected Stengle's land but its location, on the map below, is unknown.

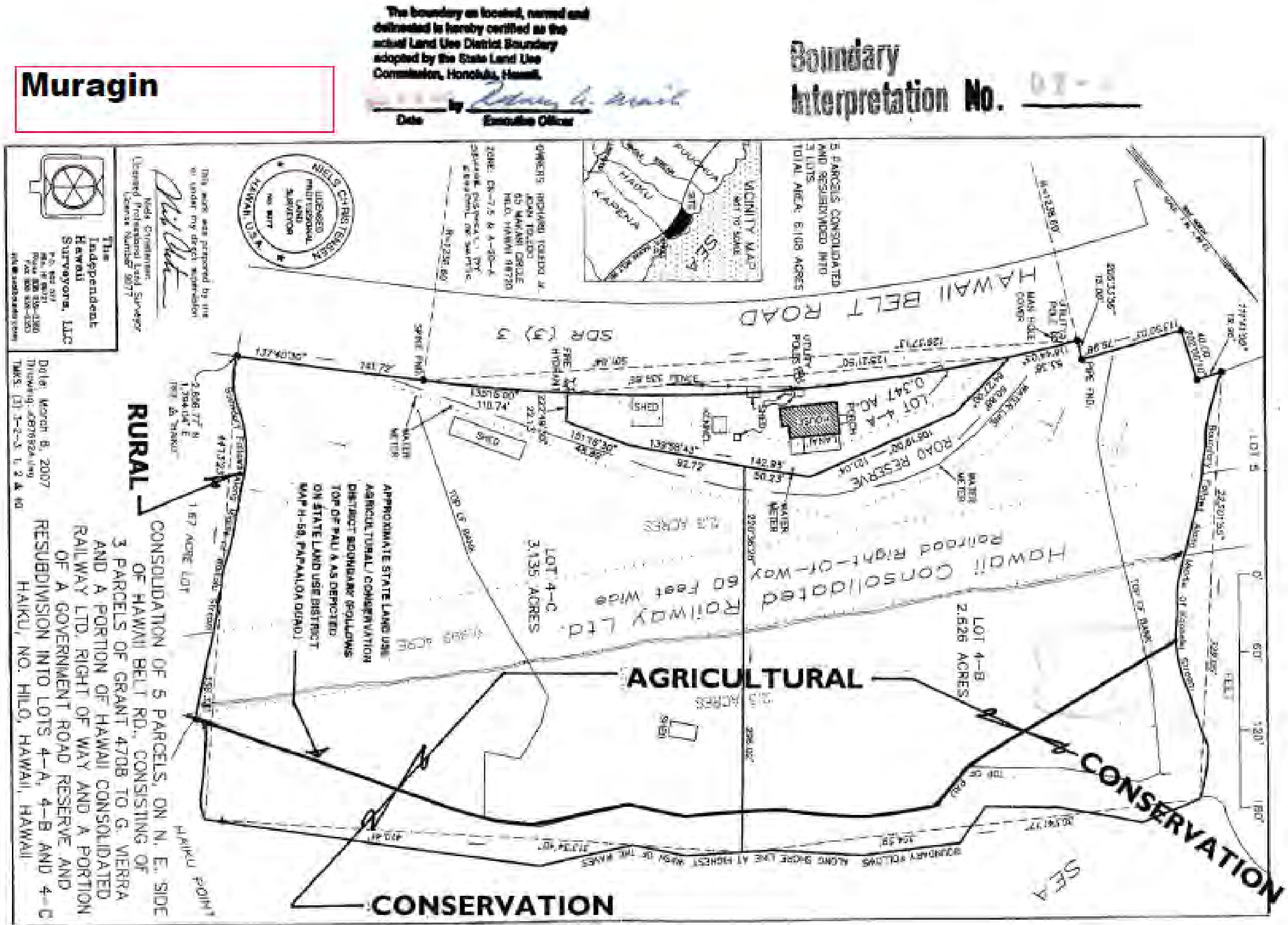

1969 Proposed and final district line (full map exhibit 38)

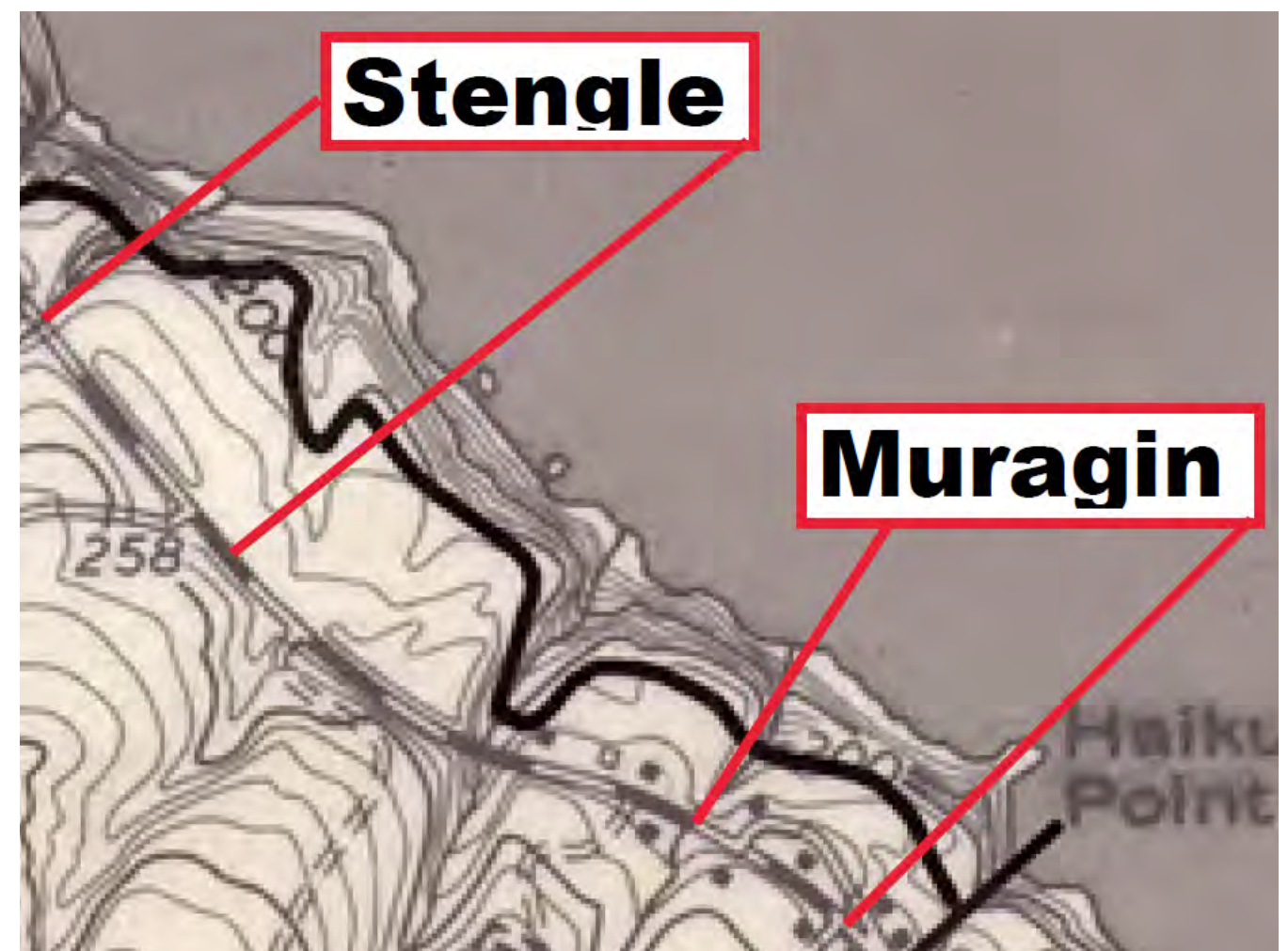

1974 district line map redrawn in 1999 (full map exhibit 39)