

| LAND USE DISTRICT BOUNDARIES | | |
|------------------------------|---|---|
| DISTRICT MAP H-65 | STATE OF HAWAII LAND USE COMMISSION DEPT. OF PLANNING & ECONOMIC DEVELOPMENT EFFECTIVE DATE: DEC 20 1974 | DISTRICTS U = URBAN R = RURAL A = AGRICULTURAL C = CONSERVATION |

PAPAIKOU QUADRANGLE
HAWAII—ISLAND AND COUNTY OF HAWAII
7.5 MINUTE SERIES (TOPOGRAPHIC)
E/2 HONOLULU 15' QUADRANGLE
670 000 FEET

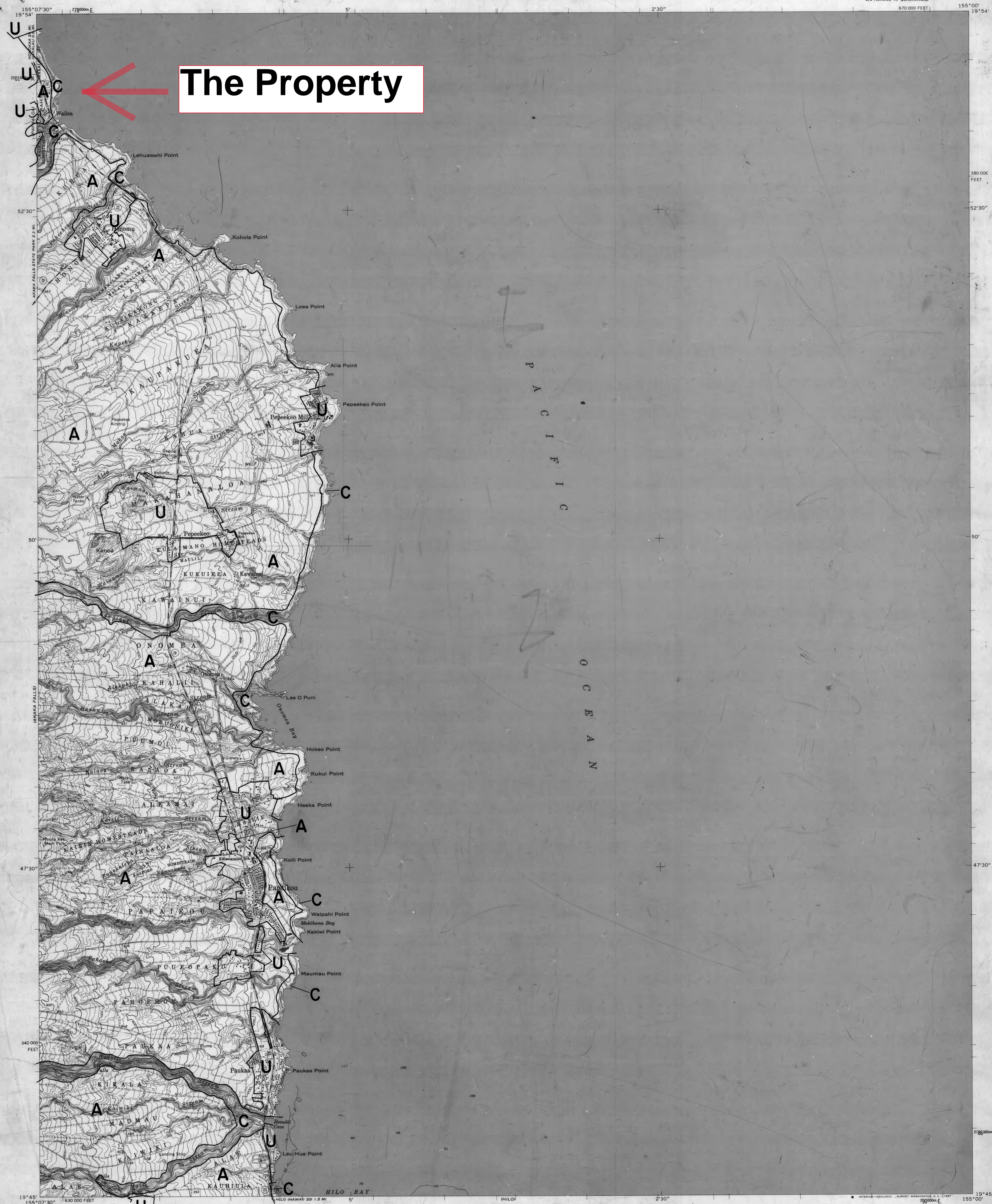

The Property

| BOUNDARY AMENDMENTS | | | |
|-------------------------------|--------------------------------|---------------------------|---------|
| DOCKET NO. | DATE | OWNER | REMARKS |
| A72-338 U to A | JAN 19, 1973 | MAIWA KEA SUGAR | |
| A72-340 U to A | JAN 19, 1973 | PEPEKEO SUGAR CO. | |
| A72-341 A to U | JAN 19, 1973 | PEPEKEO SUGAR CO. | |
| A79-455 A to U | DEC 18, 1979 | KEA SUGAR | |
| A83-556 A to C to U | MAY 18, 1984 | HONOLULU PARTNERSHIP | |
| SLU 87-8 A to U | JUL 29, 1988 | CECILIA LUIZ | |
| SLU 88-5 A to U & U to A | MAR 21, 1989 | AIEA & AIEAO INCORPORATED | |
| A92-676 HILO ONE INCORPORATED | A to U 07/02/93; Rec. 08/10/93 | | |

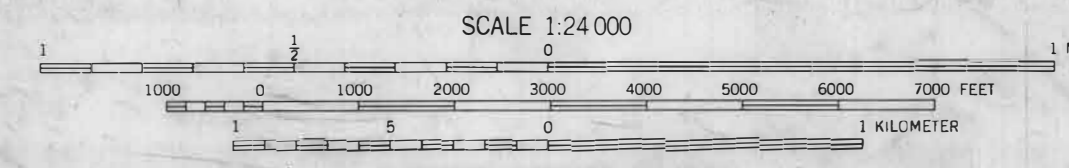

CONTOUR INTERVAL 20 FEET
DATUM IS MEAN SEA LEVEL
DEPTH CURVES AND SOUNDINGS IN FEET—DATUM IS MEAN LOWER LOW WATER
SHORELINE SHOWN REPRESENTS THE APPROXIMATE LINE OF MEAN HIGH WATER
THE MEAN RANGE OF TIDE IS APPROXIMATELY 2 FEET

THIS MAP COMPLIES WITH NATIONAL MAP ACCURACY STANDARDS
FOR SALE BY U.S. GEOLOGICAL SURVEY, DENVER, COLORADO 80225, OR WASHINGTON, D.C. 20242

ROAD CLASSIFICATION
Medium-duty ——— Light duty ———
Unimproved dirt ———
State Route ○

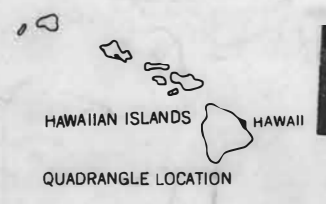

PAPAIKOU, HAWAII
E/2 HONOLULU 15' QUADRANGLE
N1945—W15500/9X7.5

H-65