

LAND USE COMMISSION
STATE OF HAWAII

Nov 7 1 25 PM '94

November 4, 1994



KIAHUNA GOLF CLUB
(SPORTS SHINKO GROUP)

2545 KIAHUNA
PLANTATION DRIVE
KOLOA, KAUAI
HAWAII 96756
808-742-9595
FAX 808-742-7445

Ms. Esther Ueda
Executive Officer
Land Use Commission
State of Hawaii
Old Federal Building, Rm. 104
335 Merchant Street
Honolulu, Hawaii 96813

ORIGINAL

Re: 1994 Annual Report/LUC Docket No.
A76-418/Moana Corporation

Dear Ms. Ueda:

In compliance with Condition 9 of the Decision and Order entered in Docket Number A76-418 on July 7, 1977, as amended by Order Granting Motion to Amend Conditions dated December 13, 1979, Sports Shinko (Kauai) Co., Ltd. ("Sports Shinko") hereby submits the 1994 Annual Report covering the period from July 7, 1993 to present for its portion of the original Moana Corporation petition area.

Progress of the Project

Since the 1992 Annual Report was filed on July 6, 1992, Sports Shinko has not proceeded with any application for the necessary permits and there has been no progress in its project. Still, Sports Shinko finds that it is quite difficult to justify the financial feasibility of the project under the current economic conditions on Kauai. Accordingly, Sports Shinko is deferring the time schedule of the entire plan referred to as Sports Shinko's Kiahuna Master Plan for at least one year (Please see Exhibit I of the enclosed 1992 Annual Report). Regretfully, Sports Shinko is bound to await a better time to carry out a profitable venture.

Conditions of the Decision and Order

Because there is no change in the status of our project since 1992, please refer to the "Conditions of Decision and Order" in the enclosed copy of the 1992 Annual Report.

Ms. Esther Ueda
November 4, 1994.
Page 2

Sports Shinko sincerely hopes that the Commission grant this submission as a fulfillment of the 1994 Annual Report requirement. If you have any questions, please do not hesitate to contact us.

Very truly yours,



Takuya Tsujimoto
Assistant Secretary
Sports Shinko (Kauai) Co., Ltd.

Enclosure

cc: Office of State Planning
Kauai County Planning Department
Taizo Sato, Sports Shinko Co., Ltd.
Mikiya Saito, Sports Shinko (Kauai) Co., Ltd.

July 6, 1992

Ms. Esther Ueda
Executive Officer
Land Use Commission
Room 104
Old Federal Building
335 Merchant Street
Honolulu, Hawaii 96813



KIAHUNA GOLF CLUB
(SPORTS SHINKO GROUP)

2545 KIAHUNA
PLANTATION DRIVE
KOLOA, KAUAI
HAWAII 96756
808-742-9595
FAX 808-742-7445

Re: 1992 Annual Report/LUC Docket
No. A76-418/Moana Corporation

Dear Ms. Ueda:

Sports Shinko (Kauai) Co., Ltd. ("Sports Shinko"), together with Sports Shinko (Kauai) Development Co., Ltd., submits the following 1992 annual report to the Land Use Commission (the "Commission"), in compliance with Condition 9 of the Decision and Order entered in Docket Number A76-418 on July 7, 1977, as amended by Order Granting Motion to Amend Conditions, dated December 13, 1979.

Progress of the Project

In April 1992, Sports Shinko developed its master plan, referred to as Sports Shinko's Kiahuna Master Plan ("SSKMP"), for the portion of original referenced Moana Corporation petition area, which is currently owned by Sports Shinko. The SSKMP including a map and supplemental information on the ownership, location, and contact persons for the remaining portions of the original petition area, was prepared by a Kauai-based engineering company, The Keith Companies, and was submitted to the County of Kauai Planning Department on April 29, 1992. The same was also submitted to the Commission with a Sports Shinko's letter dated April 28, 1992.

As shown in the SSKMP Timetable for Development, Sports Shinko plans to develop 560 multi-family residential units and 158 single-family residential lots in phases by the year 2001. Assuming that economic conditions improve in coming years and that the governmental approvals are obtained according to the timetable, Sports Shinko plans to begin grading of Phase I for 40 multi-family residential units sometime in 1995.

In April, 1991, Sports Shinko requested the County of Kauai Planning Department to refine the Zoning Boundary for TMKs: 2-8-14: 8 & 35 to accommodate the future 88 single-family residential lots within the Residential (R-4) Zoning area. Sports Shinko received a letter from the Planning Department, dated May 5, 1992, with an acknowledgement that "such a request is appropriate" and "the general configuration of the proposed R-4 and Open zoning is acceptable subject to further refinement during subdivision."

Ms. Esther Ueda
July 6, 1992.
Page 2

Since Sports Shinko submitted the SSKMP and completed the annual report requirement for 1991, no approval has been obtained either from the State or County, except for the above acknowledgement received from the County, and there is no regulatory approvals pending before any governmental agencies at this time. Also, Sports Shinko may not proceed with any application for the permits necessary for its project during the next one year, due to economic conditions beyond its control and difficulty in justifying the financial feasibility of the project.

Conditions of the Decision and Order

As it was explained in the 1991 annual report, Sports Shinko is the successor in interest to a great portion of the original petition area, but it is not the original petitioner. Therefore, it has to rely on information received from its predecessors.

Based on the 1990 annual report, dated September 1 and 14, 1990, submitted by the law firm of Case & Lynch on behalf of Kiahuna Land Co., the Decision and Order filed on July 7, 1977, as amended by Order Granting Motion to Amend Conditions, dated December 13, 1979, contained nine conditions and Condition 1 through 8 had been complied as follows:

Condition 1-4.

For the purpose of relieving the housing impact which will result from the proposed development, and in lieu of the 140 home sites to be provided by the Applicant, the Applicant will contribute the sum of \$2,000,000 to the County of Kauai to be used for the implementation of a County housing program.

Status. "Satisfied as of October 1, 1987" "Petitioner made payments amounting to \$9,000,000.00 to Kauai County by check in installments of \$10,000.00 during the three year period from 1984-87. The balance of the contribution was paid by check in October, 1987."

Condition 5.

That the Petitioner make the recreational and other amenities of the development such as the golf course, golf clubhouse, swimming facilities, tennis courts, and theater and cultural center available for the public use at reasonable usage fees.

Ms. Esther Ueda
July 6, 1992.
Page 3

Status. "Satisfied as of October, 1987: 18-hole golf course with cart barn and club house constructed."

Condition 6.

That the Petitioner dedicate to the County of Kauai approximately 20 acres of land makai of Poipu Beach Road and abutting Poipu Beach Park for expansion of the park.

Status. "Satisfied as of October 1, 1987"

Condition 7.

That prior to application for rezoning and before any grading of the subject property begins, Petitioner commission and complete a comprehensive archeological and biological study with actual inventories of archeological sites and flora and fauna on the subject property, and that the Petitioner preserve any archeological sites which the Bernice P. Bishop Museum believes to be significant and worthy of preservation and protect and preserve the present habitats of any blind, eyeless, big-eyed, hunting spiders and blind terrestrial sandhoppers which the Bernice P. Bishop Museum believes to be worthy of preservation.

Status. "Satisfied prior to construction of golf course." "The archaeological and biological study was prepared by Francis Ching in 1980."

Condition 8.

That to whatever extent possible within the confines of union requirements and applicable legal prohibitions against discrimination in employment, the Petitioner hire Kauai contractors so long as they are reasonably competitive with other contractors, and employ residents of Kauai in the temporary construction and permanent hotel related jobs.

Status. "Satisfied" "Petitioner constructed with Leal Construction, Greenscape, Inc., and Conrad Murashige for construction work relating to the golf course and golf club house. Petitioner constructed with K. Shioi for construction of shopping

Ms. Esther Ueda
July 6, 1992.
Page 4

center. Each contractor employed Kauai residents. Petitioner did not employ any Kauai residents for hotel positions as Petitioner was not involved in construction of a hotel."

To the best knowledge of Sports Shinko, Condition 1 through 8 had been satisfied by the original petitioner, Moana Corporation, and its successor, Kiahuna Land Company as explained in the foregoing. However, Condition 9 still remains unsatisfied.

Condition 9.

That the Petitioner substantially complete within five years from the date of the granting of rezoning of the subject site by the County of Kauai, being March 23, 1979, all off-site improvements, landscaping and all of the single family residential home sites, at least 300 multi-family residential units, and appropriate portion of the convenience complex and the recreational and other amenities planned for the development, and that the Petitioner reports to the Commission annually on the progress of the development and his compliance with these conditions.

Status. as stated in the 1990 annual report, "90 units completed and sold; 35,000sq. ft. shopping village constructed and road and utilites installed." As described in the above Progress of the Project, Sport Shinko formulated its master plan and timetable for the development of 560 multi-family residential units and 158 single family residential lots. However, Sports Shinko notes that such completion is subject to improvement of economic conditions.

Also, in respect to Condition 9, Sports Shinko is aware of approvals pending before the County of Kauai Planning Commission, such as the expansion of Poipu Shopping Village requested by Village Properties Inc. and construction of a comfort station proposed by Kiahuna Land Company. These applications for various permits were not submitted by Sports Shinko, and the information available to Sports Shinko regarding the status of these matters is too limited to include in its annual progress report.

Ms. Esther Ueda
July 6, 1992.
Page 5

Sports Shinko hopes that the foregoing submission satisfies the Commission's annual report requirement for 1992. Should you have any questions, please do not hesitate to contact the undersigned.

Very truly yours,

Sports Shinko (Kauai) Co., Ltd.

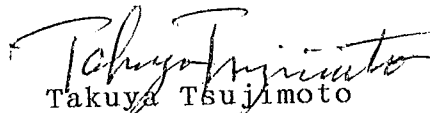
Takuya Tsujimoto
Assistant Secretary

Exhibits

- I. Sports Shinko's Kiahuna Master Plan Timetable for Development showing timetable and number of units, and TMK: 2-8-14.
- II. Letter from the County of Kauai Planning Department dated May 5, 1992 acknowledging the general refinement of Zoning Boundary for Residential (R-4) Zoning area.
- III. 1990 annual report letters, dated September 1 and 14, 1990, submitted by the law firm of Case & Lynch on behalf of Kiahuna Land Company.

Enclosures

cc: Office of State Planning

County of Kauai Planning Department

Mr. Taizo Sato, Senior General Manager
International Business Department
Sports Shinko Co., Ltd.

SPORTS SHINKO'S KIAHUNA MASTERPLAN TIMETABLE FOR DEVELOPMENT
April 1992

<u>TMK</u>	1992.....1994	1995	<u>YEAR</u>	1996	1997	1998.→.2001
	Master Plan Update					
STP Connection to A&B	Connection Plan Design, Approval & Construction					
2-8-14:34 92 MF Units	*Restroom Sewer Connect. Plans & Bldg. Permit *Restroom Legal Documents	*Site Plan Appr. *Inters. Lightng. *Abut Utilities Undergrounding Design Plans *Restroom Constr.	Phase I (40 MF) *Bldg., Grading & Constr. Permit *Utilities underground (w/in SS)	Phase II (40 MF) Bldg., Grading & Constr. Permit	Phase III (12 MF) Bldg., Grading & Constr. Permit	
2-8-14:33 188 MF Units		Building Permit Application	Phase IV (28 MF) Grading & Constr. Permit	Phase V (40 MF) Bldg., Grading & Constr. Permit	Phase VI (40 MF) Bldg., Grading & Constr. Permit 40 Units/yr.→200	
2-8-14:32 280 MF Units		Class IV Zoning Permit App. *Hapa/Kiahuna Plant. Dr. Design Plan		Phase VII (70 MF) *Grading & Constr. Permit *Hapa/KPD Constr. & Utilities Under-ground (w/in SS)	Phase VIII (70 MF) Grading & Constr. Permit 70 Units/yr.→200	
2-8-14:Por. 32 70 SF Lots				*Preliminary Sub. Application	Sub. Constr. Plan Design & Approval	Phase IX 35 Lots *Grading Permit 35 lots/yr to 19
2-8-14:8 9 Holes					Phase XI *Grading Permit *Abut. Utilities udergrounding *Poipu Rd. Land-scape buffer	
2-8-14:35 88 SF Lots				*Preliminary Sub. Application	Sub. Constr. Plan Design & Approval	Phase XII Grading & Constr. Permit (22 lots/yr.→200

EXHIBIT I.

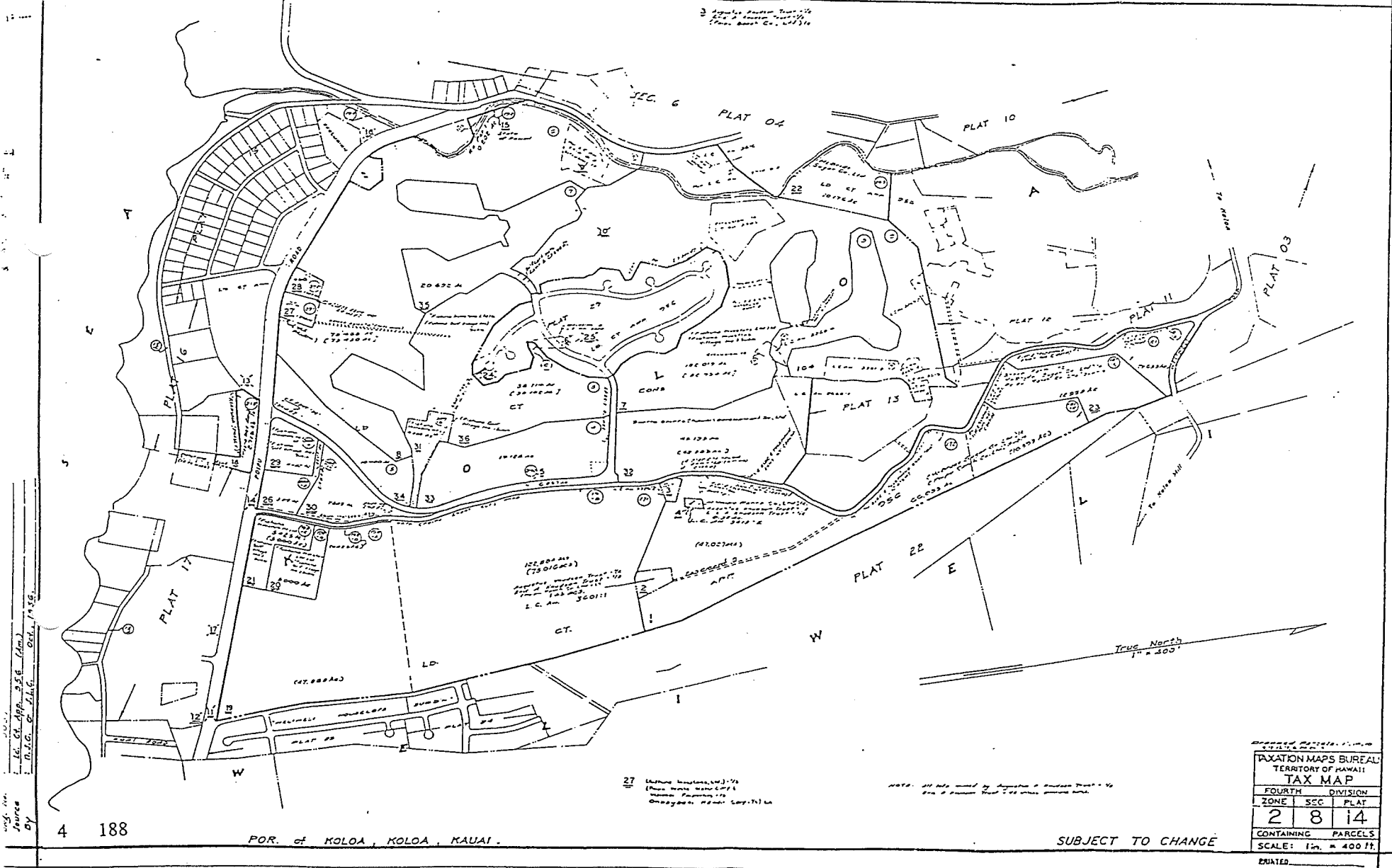

16. Ct. App. 256 (Am.)
 O.S.G. & I.H.C. Oct. 1, 1936.
 Source
 BY

4 188

POR. of KOLOA, KOLOA, KAUAI.

27
 (Mention hereinafter, etc.)
 (Please write name of
 person appearing in
 original name copy.)

NOTE: All data issued by Department of Finance, Territory of Hawaii,
 and of Bureau of Land Management, U.S. Department of the Interior.

SUBJECT TO CHANGE

TERRITORY OF HAWAII		
TAX MAP		
FOURTH	DIVISION	
ZONE	SEC	PLAT
2	8	14
CONTAINING PARCELS		
SCALE: 1 in. = 400 FT.		
ENRATED		

EXHIBIT I.



PLANNING DIRECTOR
Jeffrey R. Lacy
DEPUTY PLANNING DIRECTOR
TELEPHONE (808) 246-3919

COUNTY OF KAUAI
PLANNING DEPARTMENT
4280 RICE STREET
LIHUE, KAUAI, HAWAII 96766

May 5, 1992

Ms. Heather Harvey
4-1579 Kuhio Highway, Suite 208
Kapaa, HI 96746

SUBJECT: Zoning Determination for TMKs: 2-8-14: 8 & 35 by
Sports Shinko at Poiipu, Kauai

Upon review of your request to adjust the zoning boundaries for the subject properties to accommodate the future 88 lot residential developments, we conclude that such a request is appropriate for the following reasons:

1. The residential zoning shown on our zoning maps of the "Golf Village" development is intended to serve as graphic representations defining acreage and per acre densities of the zoning within the approved development. The exact delineation of the zoning district boundaries were not specifically defined during the zoning amendment to allow for the following:
 - a. Flexibility in golf course design and residential subdivision lot layout when more precise information is obtained and specific plans are developed.
 - b. Preservation of the archaeological sites by placing two sites outside of the Residential zoning boundaries and into the Open zone to manage and ensure the long term preservation of these sites.
2. The intent of the proposed zoning configuration is not to obtain additional density, but to situate the residential development away from the archaeological sites which would help promote a more efficient layout of the residential lots.

EXHIBIT II.

3. As requested, Sport Shinko has taken the time to prepare a conceptual master plan to cover the entire project area (including parts of Poipulani) to assist us in determining whether an adjustment of the zoning boundaries for the proposed residential development is appropriate to the overall project. After reviewing the conceptual master plan in relation to the proposed zoning boundaries we found the proposal for adjustment of the zoning boundaries to correspond and integrate into the project master plan. Please understand that the purpose of taking the time to prepare the master plan is to provide us with a perspective of how a particular project will relate to the entire development such that our zoning boundary determinations are not conducted on a piecemeal basis.

It should be noted that in the past, we have allowed the zoning boundaries to be adjusted as was done earlier for the existing Moana 90 lot residential subdivision. Your request is similar and is being applied in the same context.

In order to be fair to all concerns, we will not be committing to the exact zoning boundaries at this time since we are aware that such boundaries could change as a result of more detailed planning and engineering that would be involved in designing the subdivision. Instead we agree that the zoning boundaries are adjustable to the basic configuration being proposed, however a more appropriate time to define the exact boundaries would be at the time of subdivision when road designs, infrastructure improvements as well as lot lines are being approved. At that time the zoning boundaries can be precisely defined as was done with the 90 lot subdivision. However, please note that the general configuration of the proposed R-4 and Open zoning is acceptable subject to further refinement during subdivision.

We would also like to qualify that this letter should not be misconstrued to be an approval of Sport Shinko's Kiahuna Master Plan (April 1992) which includes the golf course expansion layout and the currently proposed 88 lot residential subdivision. The precise definition of the zoning districts could be affected during the permit process for these projects and as a result we would like to keep such options open.

It is very important to note that Moana Corp. under a current agreement, which is still binding and applicable to the present owner (Sports Shinko), has an obligation to participate in the conversion of the overhead utilities to underground. Resolution and participation of this conversion to underground will become a requirement for permits that are applied for properties

Ms. H. Harvey

Page 3

May 5, 1992

surrounding the affected area along Poipu Road. However, we note that the proposed master plan acknowledges Sport Shinko's participation in addressing this issue.

In closing, please submit for our records a copy of the zoning boundaries shown on the master plan on a 400 scale map for our subdivision and drafting sections.

Should you have any questions, please feel free to contact Keith Nitta of my staff at 245-3910.

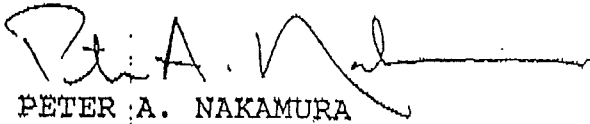

PETER A. NAKAMURA
Planning Director

CASE & LYNCH

ATTORNEYS AT LAW

PARTNERSHIP INCLUDING LAW CORPORATIONS

SUITE 2800 MAUKA TOWER

GROSVENOR CENTER

737 BISHOP STREET

HONOLULU, HAWAII 96813

POST OFFICE BOX 404

HONOLULU, HAWAII 96809-0404

(808) 547-6400

FOUNDED 1948

W. O. SMITH (1848-1988)
C. RUSLEY BRATT (1900-1979)

187 HATHORVINE PLAZA
4334 BEECH STREET, SUITE 208
LIVUE, KAUAI, HAWAII 96761-0308
TELEPHONE: (808) 848-4708
FACSIMILE: (808) 848-3277

THE HAWAII BUILDING
33 LONO AVENUE, SUITE 470
HAWAII, MAUI, HAWAII 96732-0501
TELEPHONE: (808) 871-8381
FACSIMILE: (808) 871-8728

MOHAKAMA PROFESSIONAL CENTER
878 MOHAKAMA STREET, SUITE 201
HILU, HAWAII 96720-3084
TELEPHONE: (808) 891-0811
FACSIMILE: (808) 891-4882

HUAKUNI TOWER
75-8728 HUAKUNI HIGHWAY, SUITE 108
KAILUA-KONA, HAWAII 96740-1724
TELEPHONE: (808) 328-4427
FACSIMILE: (808) 328-4808

HONOLULU OFFICE
CABLE: LONK
TELE: 733-822
FACSIMILE: (808) 523-1920

DANIEL H. SAGE
PAUL A. LYNCH
GARY L. HIRSH
ROBERT E. BETHEA
VALTA A. COOK
JAMES W. GABLEY
WESLEY W. CHISHA
JERRY R. HERRICK
MICHAEL L. BREHL
ROBERT E. ROWLAND
DAVID W. BROUDFOOT
BRUCE S. BULLOW
PAUL R. HANSEN
JEFFREY CHOI
ROBERT F. SCHNEIDER

STEPHEN D. WHITTAKER
S. V. OUB OUTHOUT
MICHAEL A. HARRIS
KENNETH H. LOUBARTSE
G. GEORGE SPINKAS
DIANA L. VAN DE CAR
GREGORY M. MUMFORD
RAY A. TAMURA
DANTON S. WONG
TOP I. TANAKA
CATY LEE BEANLEKI
VINCENT J. LUSANI
DANIEL ALAN FELLER
STEVEN S. LIM

CAROLINE R. EOLI
MATTHEW G. JEWELL
JOHN S. SIMPSON
WENAO REK
SCOTT D. BARONICH
J. GREGORY TURNBULL
RACHEL T. BRIMLEY
WERT J. SCHOFIELD
DAVID C. PARKER
FREDERICK A. TACHOINE
IVAN H. TOMNICK
SUSAN A. BENDER
CLAY BOTHERLAND
SHARON M. NISHI
MELINDA M. YAM

LYLE H. ICHIDA
GLENN H. TAGA
LINDA S. MARTEL
STEVEN J. KIM
LYNN M. HERRIT
KELLY M. HUGHES
DAVID R. BRICE
PETER A. KUBOHA
STACEY W. I. OHONG
LETA H. PARKER
JAMES J. FIRENCO
OLEAH A. S. CHING
ANN CORREA
CHARLES B. SWRIGHT IV

COUNSEL
HARTWELL H. K. SLAKE
DEBORAH A. WRIGHT
CATHERINE M. LEHGA

COUNSEL
ALAN S. KOHIEKI
CANSACE MCCASLIN

OF COUNSEL
ALLEN M. STACK
HORTO KAMAHARI

OF COUNSEL
WARREN J. SENOA
HELEON K. SOI

TA LAW CORPORATION

September 14, 1990

Ms. Esther Ueda
State of Hawaii
Land Use Commission
Room 104, Old Federal Building
335 Merchant Street
Honolulu, Hawaii 96813

HAND DELIVERY

SEP 14 10 24 AM '90
LAND USE COMMISSION
STATE OF HAWAII

Re: 1990 Annual Report
Docket No. A-76-418/Moana Corporation

Dear Ms. Ueda:

Pursuant to a telephone conversation with Steve Tagawa of your office, we are submitting this supplement to the revised 1990 Annual Report dated September 1, 1990.

Condition:

1-4. \$2,000,000.00 contribution to Kauai County for implementation of a county housing program.

7. Commission archaeological and biological study on property covered by docket.

Status:

Petitioner made payments amounting to \$9,000,000.00 to Kauai County by check in installments of \$10,000.00 during the three year period from 1984-87. The balance of the contribution was paid by check in October, 1987.

The archaeological and biological study was prepared by Francis Ching in 1980.

EXHIBIT III.

8. Employment of Kauai contractors and Kauai residents in temporary construction and permanent hotel jobs.

Petitioner contracted with Leal Construction, Greenscape, Inc., and Conrad Murashige for construction work relating to the golf course and golf club house. Petitioner contracted with K. Shioi for construction of shopping center. Each contractor employed Kauai residents. Petitioner did not employ any Kauai residents for hotel positions as Petitioner was not involved in construction of a hotel.

Please be advised that Kiahuna Land Company, successor in interest to Moana Corporation, sold all of its interest in the property covered by the above-referenced docket number to Sport Shinko (Kauai) Inc. in October, 1987. Future requests for annual reports should be directed to Mr. Charlie Ortega c/o Sport Shinko (Kauai) Inc., 2545 Kiahuna Plantation Drive, Koloa, Kauai, Hawaii 96756.

Very truly yours,

Case & Lynch

Stacey W. E. Chong

SWC/dac: 0165T
cc: Frank Supon
Robert Harmon
Dennis M. Lombardi, Esq.

CASE & LYNCH

ATTORNEYS AT LAW
PARTNERSHIP INCLUDING LAW CORPORATION

SUITE 2600 MAUKA TOWER
GROSVENOR CENTER
737 BISHOP STREET
HONOLULU, HAWAII 96813

POST OFFICE BOX 484

HONOLULU, HAWAII 96809-0484
(808) 547-8400

September 1, 1990

JANIEL H. GAGE
AULI A. LYNCH
GARY L. WHELAN
ROBERT E. BETHEA
VALTA A. COOK
JAMES H. O'NEALEY
WESLEY W. SHIBATA
JOHN B. MYRBAE
MICHAEL L. BIEHL
ROBERT E. HENGLAND
DAVID W. PEARCE
BRUCE C. MOULDER
PAUL R. MANDON
JEFFREY OMER
ROBERT P. SCHNEIDER

CAROLINE R. KELLY
MATTHEW D. JEWELL
JOHN B. SIMPSON
NEMAO ARAI
SCOTT O. MADOVICH
J. GREGORY TURNBULL
RAMEL T. SHIMAZU
WENNY J. BEMFIELD
DAVID S. PARNER
FREDERICK B. TROMBONE
IVAN H. TORRICE
SUSAN A. BENDER
R. CLAY BUTHOLAND
SHARON M. NISHI
HELENA H. YAM

STEPHEN O. WHITTAKER
S. V. BUD COUTYOUT
MICHAEL R. MARSH
DENNIS M. LOWBARRETT
O. GEORGE SPYRIDAKIS
DANA L. VAN DE GAR
GREGORY H. HANSEN
RAY A. LANIKAMA
DAVID B. WOODS
TODD J. TAMARA
GARY LEE SCHREIBER
VINCENT J. LUGANI
DAVID ALLAN PELLER
STEVEN S. LIM

LYLE H. SHIBATA
GLENN N. YADA
LINDA S. MARTELL
STEVEN J. KIM
LYNN M. METRY
KELLY M. HUGHES
DAVID R. SMER
PETER S. KUSOTA
STROY W. S. O'HANES
LETA H. PEARCE
JAMES J. FLEENER
GLENN S. O'HING
ANN CORREA
CHARLES E. DWIGHT IV

COUNSEL
HARTWELL H. T. BLAKE
DEBORAH E. WRIGHT
CATHERINE H. LEAHEA

OF COUNSEL
ALLEN M. STAGG
NORTO KAWAKAMI
WARREN J. BEMBA
HELEON K. DOI

* A LAW CORPORATION

FOUNDED 1888
W. O. SMITH (1888-1988)
C. DUDLEY PRATT (1900-1978)
187 KAPAHULU PLAZA
4334 KOOE STREET, SUITE 202
LIHUE, KAUAI, HAWAII 96746-1288
TELEPHONE: (808) 848-4700
FACSIMILE: (808) 848-3777

THE HONOLULU BUILDING
33 LONG AVENUE, SUITE 470
HONOLULU, MAUI, HAWAII 96731-4001
TELEPHONE: (808) 871-8281
FACSIMILE: (808) 871-0732

MOHAKAHAI PROFESSIONAL CENTER
278 MOHAKAHAI STREET, SUITE 201
KILAUEA, HAWAII 96720-3004
TELEPHONE: (808) 881-1601
FACSIMILE: (808) 881-4882

KUAKINI TOWER
75-572E KUAKINI HIGHWAY, SUITE 108
KAILUA-KONA, HAWAII 96740-1733
TELEPHONE: (808) 328-4441
FACSIMILE: (808) 328-4504

HONOLULU OFFICE
CABLE/LOAN
TELETYPE/TELEX
FACSIMILE: (808) 543-1880

Ms. Esther Ueda
Executive Officer
State of Hawaii
Land Use Commission
Room 104, Old Federal Building
335 Merchant Street
Honolulu, Hawaii 96813

Re: Revised 1990 Annual Report
Docket No. A-76-418/Moana Corporation

Dear Ms. Ueda:

Pursuant to the Land Use Commission's request, we are resubmitting the 1990 status report on the property covered by the above-mentioned docket (the "Property") to include a list of the conditions applicable to the Property, pursuant to the Decision and Order dated July 7, 1977, and a brief description of the progress made with respect to each condition.

Condition:

- 1-4. (as amended by Order Granting Motion to Amend Conditions, 1, 2, 3, 4, dated 12/13/79) \$2,000,000.00 contribution to Kauai County for implementation of a County housing program.
- 5. Construction of recreational and other amenities, including golf course and golf course club house.

Status:

Satisfied as of
October 1, 1987

Satisfied as of
October, 1987;
18-hole golf course
with cart barn and
club house
constructed.

EXHIBIT III.

SEP 4 10 31 AM '90
LAND USE COMMISSION
STATE OF HAWAII

6. Dedication of 20 acres of land makai of Poipu Beach Road and abutting Poipu Beach Park for expansion of the park. Satisfied as of October 1, 1987
7. (As amended by Decision and Order on Motion to Amend Condition No. 7 dated 7/13/78) Commission archaeological and biological study on property. Satisfied prior to construction of golf course.
8. Employment of Kauai contractors reasonably competitive with other contractors and Kauai residents in temporary construction and permanent hotel jobs. Satisfied
9. (As amended by Order Granting Motion to Amend Condition No.9 dated 12/13/79) Completion of 300 multi-family residential units, and an appropriate portion of commercial complex and recreational amenities. 90 units completed and sold; 35,000 sq. ft. shopping village constructed and road and utilities installed.

Based on the foregoing, Condition No. 9 is the only condition which remains outstanding. As to this condition, the portion of the Property designated for the construction of the multi-family residential units has been sold to Sports Shinko (Kauai) Co. Ltd. We suggest that future requests for annual reports be directed to this company.

If you have any questions or need further information, please do not hesitate to call.

Very truly yours,

CASE & LYNCH

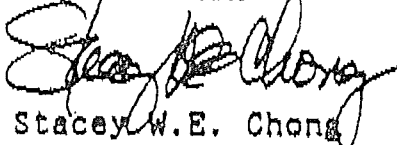

Stacey W.E. Chong

SWC/dim/9667P
cc: Robert Harmon
Frank Supon
Dennis M. Lombardi, Esq.