

## GOVERNMENT RECORDS SEARCHED / DATA CURRENCY TRACKING

### Public Schools

Source: National Center for Education Statistics  
Telephone: 202-502-7300

The National Center for Education Statistics' primary database on elementary and secondary public education in the United States. It is a comprehensive, annual, national statistical database of all public elementary and secondary schools and school districts, which contains data that are comparable across all states.

### Private Schools

Source: National Center for Education Statistics  
Telephone: 202-502-7300

The National Center for Education Statistics' primary database on private school locations in the United States.

Flood Zone Data: This data, available in select counties across the country, was obtained by EDR in 2003 & 2011 from the Federal Emergency Management Agency (FEMA). Data depicts 100-year and 500-year flood zones as defined by FEMA.

NWI: National Wetlands Inventory. This data, available in select counties across the country, was obtained by EDR in 2002, 2005 and 2010 from the U.S. Fish and Wildlife Service.

### Scanned Digital USGS 7.5' Topographic Map (DRG)

Source: United States Geologic Survey

A digital raster graphic (DRG) is a scanned image of a U.S. Geological Survey topographic map. The map images are made by scanning published paper maps on high-resolution scanners. The raster image is georeferenced and fit to the Universal Transverse Mercator (UTM) projection.

### STREET AND ADDRESS INFORMATION

© 2010 Tele Atlas North America, Inc. All rights reserved. This material is proprietary and the subject of copyright protection and other intellectual property rights owned by or licensed to Tele Atlas North America, Inc. The use of this material is subject to the terms of a license agreement. You will be held liable for any unauthorized copying or disclosure of this material.

## GEOCHECK®- PHYSICAL SETTING SOURCE ADDENDUM

### TARGET PROPERTY ADDRESS

MIKI BASIN - 200 ACRE INDUSTRIAL SITE  
MIKI ROAD & KAUMALAPAU HIGHWAY  
LANAI CITY, HI 96763

### TARGET PROPERTY COORDINATES

Latitude (North):	20.7904 - 20° 47' 25.44"
Longitude (West):	156.9375 - 156° 56' 15.00"
Universal Transverse Mercator:	Zone 4
UTM X (Meters):	714689.2
UTM Y (Meters):	2300187.0
Elevation:	1247 ft. above sea level

### USGS TOPOGRAPHIC MAP

Target Property Map:	20156-G8 ISLAND OF LANAI OE NW, HI
Most Recent Revision:	Not reported

EDR's GeoCheck Physical Setting Source Addendum is provided to assist the environmental professional in forming an opinion about the impact of potential contaminant migration.

Assessment of the impact of contaminant migration generally has two principal investigative components:

1. Groundwater flow direction, and
2. Groundwater flow velocity.

Groundwater flow direction may be impacted by surface topography, hydrology, hydrogeology, characteristics of the soil, and nearby wells. Groundwater flow velocity is generally impacted by the nature of the geologic strata.

## GEOCHECK® - PHYSICAL SETTING SOURCE SUMMARY

### GROUNDWATER FLOW DIRECTION INFORMATION

Groundwater flow direction for a particular site is best determined by a qualified environmental professional using site-specific well data. If such data is not reasonably ascertainable, it may be necessary to rely on other sources of information, such as surface topographic information, hydrologic information, hydrogeologic data collected on nearby properties, and regional groundwater flow information (from deep aquifers).

### TOPOGRAPHIC INFORMATION

Surface topography may be indicative of the direction of surficial groundwater flow. This information can be used to assist the environmental professional in forming an opinion about the impact of nearby contaminated properties or, should contamination exist on the target property, what downgradient sites might be impacted.

### TARGET PROPERTY TOPOGRAPHY

General Topographic Gradient: General SSE

### SURROUNDING TOPOGRAPHY: ELEVATION PROFILES

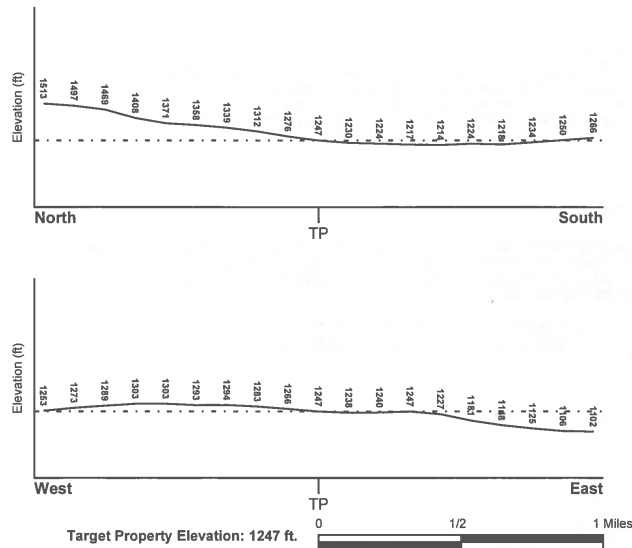

Source: Topography has been determined from the USGS 7.5' Digital Elevation Model and should be evaluated on a relative (not an absolute) basis. Relative elevation information between sites of close proximity should be field verified.

## GEOCHECK® - PHYSICAL SETTING SOURCE SUMMARY

### HYDROLOGIC INFORMATION

Surface water can act as a hydrologic barrier to groundwater flow. Such hydrologic information can be used to assist the environmental professional in forming an opinion about the impact of nearby contaminated properties or, should contamination exist on the target property, what downgradient sites might be impacted.

Refer to the Physical Setting Source Map following this summary for hydrologic information (major waterways and bodies of water).

### FEMA FLOOD ZONE

Target Property County  
MAUI, HI

FEMA Flood  
Electronic Data  
YES - refer to the Overview Map and Detail Map

Flood Plain Panel at Target Property:

Not Reported

Additional Panels in search area:

Not Reported

### NATIONAL WETLAND INVENTORY

NWI Quad at Target Property  
NOT AVAILABLE

NWI Electronic  
Data Coverage  
YES - refer to the Overview Map and Detail Map

### HYDROGEOLOGIC INFORMATION

Hydrogeologic information obtained by installation of wells on a specific site can often be an indicator of groundwater flow direction in the immediate area. Such hydrogeologic information can be used to assist the environmental professional in forming an opinion about the impact of nearby contaminated properties or, should contamination exist on the target property, what downgradient sites might be impacted.

### AQUIFLOW®

Search Radius: 1.000 Mile.

EDR has developed the AQUIFLOW Information System to provide data on the general direction of groundwater flow at specific points. EDR has reviewed reports submitted by environmental professionals to regulatory authorities at select sites and has extracted the date of the report, groundwater flow direction as determined hydrogeologically, and the depth to water table.

MAP ID	LOCATION FROM TP	GENERAL DIRECTION GROUNDWATER FLOW
Not Reported		

## GEOCHECK® - PHYSICAL SETTING SOURCE SUMMARY

### GROUNDWATER FLOW VELOCITY INFORMATION

Groundwater flow velocity information for a particular site is best determined by a qualified environmental professional using site specific geologic and soil strata data. If such data are not reasonably ascertainable, it may be necessary to rely on other sources of information, including geologic age identification, rock stratigraphic unit and soil characteristics data collected on nearby properties and regional soil information. In general, contaminant plumes move more quickly through sandy-gravelly types of soils than silty-clayey types of soils.

### GEOLOGIC INFORMATION IN GENERAL AREA OF TARGET PROPERTY

Geologic information can be used by the environmental professional in forming an opinion about the relative speed at which contaminant migration may be occurring.

#### ROCK STRATIGRAPHIC UNIT

Era: -  
System: -  
Series: -  
Code: N/A (decoded above as Era, System & Series)

#### GEOLOGIC AGE IDENTIFICATION

Category: -

Geologic Age and Rock Stratigraphic Unit Source: P.G. Schruben, R.E. Arndt and W.J. Bawiec, Geology of the Conterminous U.S. at 1:2,500,000 Scale - a digital representation of the 1974 P.B. King and H.M. Beikman Map, USGS Digital Data Series DDS - 11 (1994).

## SSURGO SOIL MAP - 3875991.2s

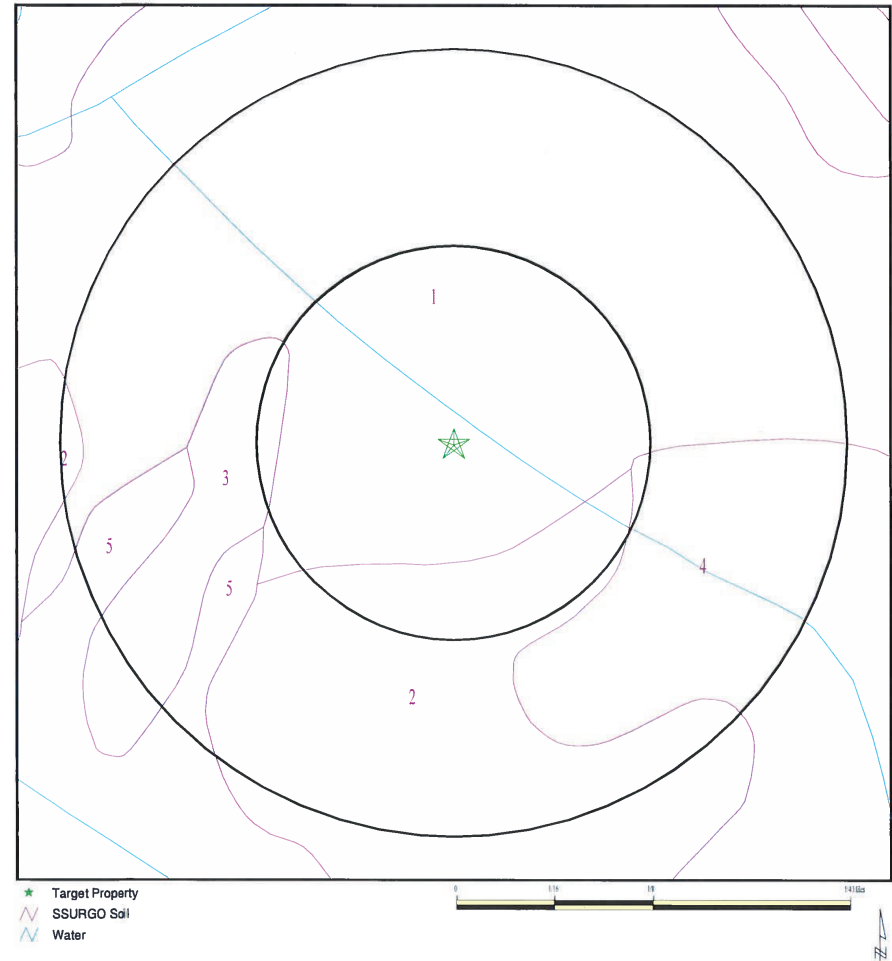

SITE NAME: Miki Basin - 200 Acre Industrial Site  
ADDRESS: Miki Road & Kaunapali Highway  
Lanai City HI 96763  
LAT/LONG: 20.7904 / 156.9375

CLIENT: TRC  
CONTACT: Ron Landolt  
INQUIRY #: 3875991.2s  
DATE: March 10, 2014 5:26 pm

Copyright © 2014 EOR, Inc. © 2010 Tala Atlas Rel. 07/2009.

## GEOCHECK® - PHYSICAL SETTING SOURCE SUMMARY

### DOMINANT SOIL COMPOSITION IN GENERAL AREA OF TARGET PROPERTY

The U.S. Department of Agriculture's (USDA) Soil Conservation Service (SCS) leads the National Cooperative Soil Survey (NCSS) and is responsible for collecting, storing, maintaining and distributing soil survey information for privately owned lands in the United States. A soil map in a soil survey is a representation of soil patterns in a landscape. The following information is based on Soil Conservation Service SSURGO data.

#### Soil Map ID: 1

Soil Component Name: Molokai

Soil Surface Texture: silty clay loam

Hydrologic Group: Class B - Moderate infiltration rates. Deep and moderately deep, moderately well and well drained soils with moderately coarse textures.

Soil Drainage Class: Well drained

Hydric Status: Unknown

Corrosion Potential - Uncoated Steel: Moderate

Depth to Bedrock Min: > 0 inches

Depth to Watertable Min: > 0 inches

Soil Layer Information							
Layer	Boundary		Soil Texture Class	Classification		Saturated hydraulic conductivity micro m/sec	Soil Reaction (pH)
	Upper	Lower		AASHTO Group	Unified Soil		
1	0 inches	14 inches	silty clay loam	Silt-Clay Materials (more than 35 pct. passing No. 200), Clayey Soils.	CL-K (proposed)	Max: 14 Min: 4.23	Max: 7.8 Min: 6.6
2	14 inches	72 inches	silty clay loam	Silt-Clay Materials (more than 35 pct. passing No. 200), Clayey Soils.	CL-K (proposed)	Max: 14 Min: 4.23	Max: 7.8 Min: 6.6

#### Soil Map ID: 2

Soil Component Name: Molokai

Soil Surface Texture: silty clay loam

Hydrologic Group: Class B - Moderate infiltration rates. Deep and moderately deep, moderately well and well drained soils with moderately coarse textures.

Soil Drainage Class: Well drained

## GEOCHECK® - PHYSICAL SETTING SOURCE SUMMARY

Hydric Status: Unknown

Corrosion Potential - Uncoated Steel: Moderate

Depth to Bedrock Min: > 0 inches

Depth to Watertable Min: > 0 inches

Soil Layer Information							
Layer	Boundary		Soil Texture Class	Classification		Saturated hydraulic conductivity micro m/sec	Soil Reaction (pH)
	Upper	Lower		AASHTO Group	Unified Soil		
1	0 inches	14 inches	silty clay loam	Silt-Clay Materials (more than 35 pct. passing No. 200), Clayey Soils.	CL-K (proposed)	Max: 14 Min: 4.23	Max: 7.8 Min: 6.6
2	14 inches	72 inches	silty clay loam	Silt-Clay Materials (more than 35 pct. passing No. 200), Clayey Soils.	CL-K (proposed)	Max: 14 Min: 4.23	Max: 7.8 Min: 6.6

#### Soil Map ID: 3

Soil Component Name: Uwala

Soil Surface Texture: silty clay loam

Hydrologic Group: Class B - Moderate infiltration rates. Deep and moderately deep, moderately well and well drained soils with moderately coarse textures.

Soil Drainage Class: Well drained

Hydric Status: Unknown

Corrosion Potential - Uncoated Steel: High

Depth to Bedrock Min: > 0 inches

Depth to Watertable Min: > 0 inches

# **GEOCHECK® - PHYSICAL SETTING SOURCE SUMMARY**

Soil Layer Information							
Layer	Boundary		Soil Texture Class	Classification		Saturated hydraulic conductivity micro m/sec	Soil Reaction (pH)
	Upper	Lower		AASHTO Group	Unified Soil		
1	0 inches	18 inches	silty clay loam	Silt-Clay Materials (more than 35 pct. passing No. 200), Clayey Soils.	CL-K (proposed)	Max: 14 Min: 4.23	Max: 5 Min: 4.5
2	18 inches	57 inches	silty clay loam	Silt-Clay Materials (more than 35 pct. passing No. 200), Clayey Soils.	CL-K (proposed)	Max: 14 Min: 4.23	Max: 6 Min: 5.1
3	57 inches	59 inches	silty clay loam	Silt-Clay Materials (more than 35 pct. passing No. 200), Clayey Soils.	CL-K (proposed)	Max: 14 Min: 4.23	Max: 6 Min: 5.1

## **Soil Map ID: 4**

Soil Component Name: Waikapu

Soil Surface Texture: silty clay loam

Hydrologic Group: Class B - Moderate infiltration rates. Deep and moderately deep, moderately well and well drained soils with moderately coarse textures.

Soil Drainage Class: Well drained

Hydric Status: Unknown

Corrosion Potential - Uncoated Steel: Low

Depth to Bedrock Min: > 0 inches

Depth to Watertable Min: > 0 inches

# **GEOCHECK® - PHYSICAL SETTING SOURCE SUMMARY**

Soil Layer Information							
Layer	Boundary		Soil Texture Class	Classification		Saturated hydraulic conductivity micro m/sec	Soil Reaction (pH)
	Upper	Lower		AASHTO Group	Unified Soil		
1	0 inches	11 inches	silty clay loam	Silt-Clay Materials (more than 35 pct. passing No. 200), Silty Soils.	CL-K (proposed)	Max: 14 Min: 4.23	Max: 7.8 Min: 6.6
2	11 inches	59 inches	silty clay loam	Silt-Clay Materials (more than 35 pct. passing No. 200), Silty Soils.	CL-K (proposed)	Max: 14 Min: 4.23	Max: 7.8 Min: 6.6

## **Soil Map ID: 5**

Soil Component Name: Uwala

Soil Surface Texture: silty clay loam

Hydrologic Group: Class B - Moderate infiltration rates. Deep and moderately deep, moderately well and well drained soils with moderately coarse textures.

Soil Drainage Class: Well drained

Hydric Status: Unknown

Corrosion Potential - Uncoated Steel: High

Depth to Bedrock Min: > 0 inches

Depth to Watertable Min: > 0 inches

Soil Layer Information							
Layer	Boundary		Soil Texture Class	Classification		Saturated hydraulic conductivity micro m/sec	Soil Reaction (pH)
	Upper	Lower		AASHTO Group	Unified Soil		
1	0 inches	18 inches	silty clay loam	Silt-Clay Materials (more than 35 pct. passing No. 200), Clayey Soils.	CL-K (proposed)	Max: 14 Min: 4.23	Max: 5 Min: 4.5

# **GEOCHECK® - PHYSICAL SETTING SOURCE SUMMARY**

Soil Layer Information							
Layer	Boundary		Soil Texture Class	Classification		Saturated hydraulic conductivity micro m/sec	Soil Reaction (pH)
	Upper	Lower		AASHTO Group	Unified Soil		
2	18 inches	57 inches	silty clay loam	Silt-Clay Materials (more than 35 pct. passing No. 200), Clayey Soils.	CL-K (proposed)	Max: 14 Min: 4.23	Max: 6 Min: 5.1
3	57 inches	59 inches	silty clay loam	Silt-Clay Materials (more than 35 pct. passing No. 200), Clayey Soils.	CL-K (proposed)	Max: 14 Min: 4.23	Max: 6 Min: 5.1

## LOCAL / REGIONAL WATER AGENCY RECORDS

EDR Local/Regional Water Agency records provide water well information to assist the environmental professional in assessing sources that may impact ground water flow direction, and in forming an opinion about the impact of contaminant migration on nearby drinking water wells.

## WELL SEARCH DISTANCE INFORMATION

<u>DATABASE</u>	<u>SEARCH DISTANCE (miles)</u>
Federal USGS	1.000
Federal FRDS PWS	Nearest PWS within 1 mile
State Database	1.000

## **FEDERAL USGS WELL INFORMATION**

MAP ID	WELL ID	LOCATION FROM TP
No Wells Found		

## **FEDERAL FRDS PUBLIC WATER SUPPLY SYSTEM INFORMATION**

MAP ID	WELL ID	LOCATION FROM TP
No PWS System Found		

Note: PWS System location is not always the same as well location.

# **GEOCHECK® - PHYSICAL SETTING SOURCE SUMMARY**

## **STATE DATABASE WELL INFORMATION**

MAP ID	WELL ID	LOCATION FROM TP
No Wells Found		

# PHYSICAL SETTING SOURCE MAP - 3875991.2s

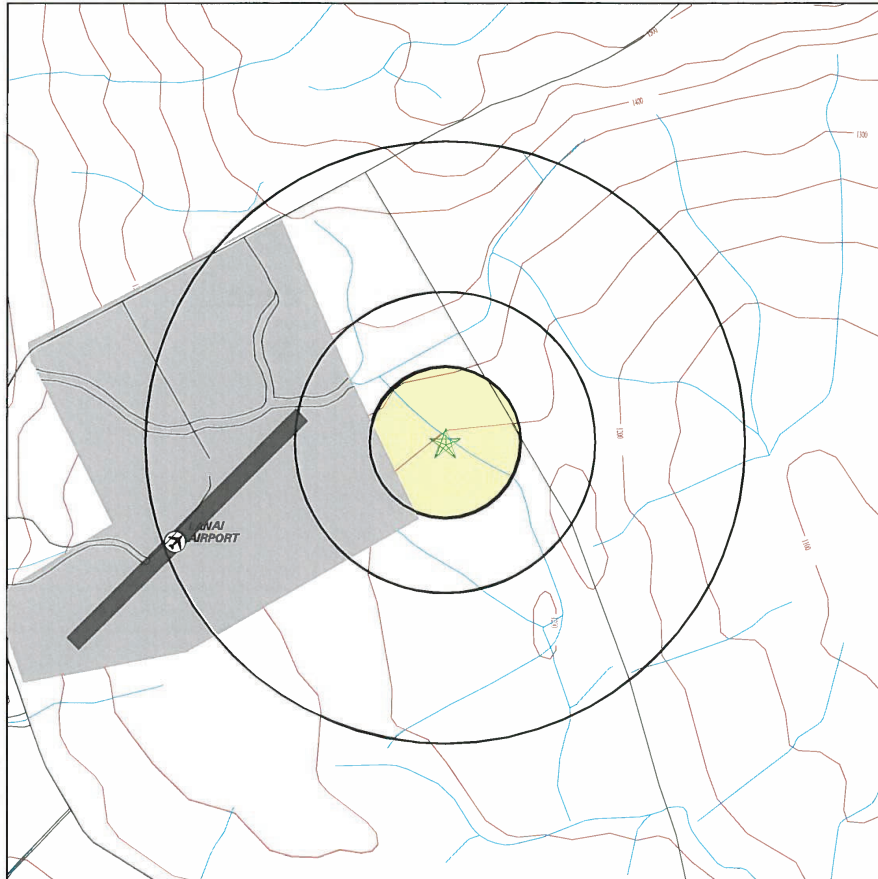

- County Boundary
- Major Roads
- Contour Lines
- Airports
- Earthquake epicenter, Richter 5 or greater
- Water Wells
- Public Water Supply Wells
- Cluster of Multiple Icons

- Groundwater Flow Direction
- Indeterminate Groundwater Flow at Location
- Groundwater Flow Varies at Location

SITE NAME: Miki Basin - 200 Acre Industrial Site  
 ADDRESS: Miki Road & Kaunapala Highway  
 Lanai City HI 96763  
 LAT/LONG: 20.7904 / 156.9375

CLIENT: TRC  
 CONTACT: Ron Landolt  
 INQUIRY #: 3875991.2s  
 DATE: March 10, 2014 5:26 pm

Copyright © 2014 EDR, Inc. © 2010 Tele Atlas Rel. 07/2009

## GEOCHECK® - PHYSICAL SETTING SOURCE MAP FINDINGS RADON

### AREA RADON INFORMATION

Federal EPA Radon Zone for MAUI County: 3

- Note: Zone 1 indoor average level > 4 pCi/L.  
 : Zone 2 indoor average level >= 2 pCi/L and <= 4 pCi/L.  
 : Zone 3 indoor average level < 2 pCi/L.

Federal Area Radon Information for MAUI COUNTY, HI

Number of sites tested: 70

Area	Average Activity	% <4 pCi/L	% 4-20 pCi/L	% >20 pCi/L
Living Area - 1st Floor	0.057 pCi/L	100%	0%	0%
Living Area - 2nd Floor	0.000 pCi/L	100%	0%	0%
Basement	0.150 pCi/L	100%	0%	0%



## PHYSICAL SETTING SOURCE RECORDS SEARCHED

### TOPOGRAPHIC INFORMATION

USGS 7.5' Digital Elevation Model (DEM)

Source: United States Geologic Survey

EDR acquired the USGS 7.5' Digital Elevation Model in 2002 and updated it in 2006. The 7.5 minute DEM corresponds to the USGS 1:24,000- and 1:25,000-scale topographic quadrangle maps. The DEM provides elevation data with consistent elevation units and projection.

Scanned Digital USGS 7.5' Topographic Map (DRG)

Source: United States Geologic Survey

A digital raster graphic (DRG) is a scanned image of a U.S. Geological Survey topographic map. The map images are made by scanning published paper maps on high-resolution scanners. The raster image is georeferenced and fit to the Universal Transverse Mercator (UTM) projection.

### HYDROLOGIC INFORMATION

Flood Zone Data: This data, available in select counties across the country, was obtained by EDR in 2003 & 2011 from the Federal Emergency Management Agency (FEMA). Data depicts 100-year and 500-year flood zones as defined by FEMA.

NWI: National Wetlands Inventory. This data, available in select counties across the country, was obtained by EDR in 2002, 2005 and 2010 from the U.S. Fish and Wildlife Service.

### HYDROGEOLOGIC INFORMATION

AQUIFLOW<sup>R</sup> Information System

Source: EDR proprietary database of groundwater flow information

EDR has developed the AQUIFLOW Information System (AIS) to provide data on the general direction of groundwater flow at specific points. EDR has reviewed reports submitted to regulatory authorities at select sites and has extracted the date of the report, hydrogeologically determined groundwater flow direction and depth to water table information.

### GEOLOGIC INFORMATION

Geologic Age and Rock Stratigraphic Unit

Source: P.G. Schruben, R.E. Arndt and W.J. Bawiec, Geology of the Conterminous U.S. at 1:2,500,000 Scale - A digital representation of the 1974 P.B. King and H.M. Beikman Map, USGS Digital Data Series DDS - 11 (1994).

STATSGO: State Soil Geographic Database

Source: Department of Agriculture, Natural Resources Conservation Services

The U.S. Department of Agriculture's (USDA) Natural Resources Conservation Service (NRCS) leads the national Conservation Soil Survey (NCSS) and is responsible for collecting, storing, maintaining and distributing soil survey information for privately owned lands in the United States. A soil map in a soil survey is a representation of soil patterns in a landscape. Soil maps for STATSGO are compiled by generalizing more detailed (SSURGO) soil survey maps.

SSURGO: Soil Survey Geographic Database

Source: Department of Agriculture, Natural Resources Conservation Services (NRCS)

Telephone: 800-672-5559

SSURGO is the most detailed level of mapping done by the Natural Resources Conservation Services, mapping scales generally range from 1:12,000 to 1:63,360. Field mapping methods using national standards are used to construct the soil maps in the Soil Survey Geographic (SSURGO) database. SSURGO digitizing duplicates the original soil survey maps. This level of mapping is designed for use by landowners, townships and county natural resource planning and management.

## PHYSICAL SETTING SOURCE RECORDS SEARCHED

### LOCAL / REGIONAL WATER AGENCY RECORDS

#### FEDERAL WATER WELLS

PWS: Public Water Systems

Source: EPA/Office of Drinking Water

Telephone: 202-564-3750

Public Water System data from the Federal Reporting Data System. A PWS is any water system which provides water to at least 25 people for at least 60 days annually. PWSs provide water from wells, rivers and other sources.

PWS ENF: Public Water Systems Violation and Enforcement Data

Source: EPA/Office of Drinking Water

Telephone: 202-564-3750

Violation and Enforcement data for Public Water Systems from the Safe Drinking Water Information System (SDWIS) after August 1995. Prior to August 1995, the data came from the Federal Reporting Data System (FRDS).

USGS Water Wells: USGS National Water Inventory System (NWIS)

This database contains descriptive information on sites where the USGS collects or has collected data on surface water and/or groundwater. The groundwater data includes information on wells, springs, and other sources of groundwater.

#### STATE RECORDS

Well Index Database

Source: Commission on Water Resource Management

Telephone: 808-587-0214

CWRM maintains a Well Index Database to track specific information pertaining to the construction and installation of production wells in Hawaii

### OTHER STATE DATABASE INFORMATION

#### RADON

Area Radon Information

Source: USGS

Telephone: 703-356-4020

The National Radon Database has been developed by the U.S. Environmental Protection Agency (USEPA) and is a compilation of the EPA/State Residential Radon Survey and the National Residential Radon Survey. The study covers the years 1986 - 1992. Where necessary data has been supplemented by information collected at private sources such as universities and research institutions.

EPA Radon Zones

Source: EPA

Telephone: 703-356-4020

Sections 307 & 309 of IRAA directed EPA to list and identify areas of U.S. with the potential for elevated indoor radon levels.

#### OTHER

Airport Landing Facilities: Private and public use landing facilities

Source: Federal Aviation Administration, 800-457-6656

Epicenters: World earthquake epicenters, Richter 5 or greater

Source: Department of Commerce, National Oceanic and Atmospheric Administration

Earthquake Fault Lines: The fault lines displayed on EDR's Topographic map are digitized quaternary faultlines, prepared in 1975 by the United State Geological Survey



## PHYSICAL SETTING SOURCE RECORDS SEARCHED

### STREET AND ADDRESS INFORMATION

© 2010 Tele Atlas North America, Inc. All rights reserved. This material is proprietary and the subject of copyright protection and other intellectual property rights owned by or licensed to Tele Atlas North America, Inc. The use of this material is subject to the terms of a license agreement. You will be held liable for any unauthorized copying or disclosure of this material.

### **MIKI BASIN GENERATING STATION**

1001 N MIKI RD  
LANAI CITY, HI 96763

Inquiry Number:  
March 31, 2014

EDR Site Report™



6 Armstrong Road, 4th floor  
Shelton, CT 06484  
Toll Free: 800.352.0050  
[www.edrnet.com](http://www.edrnet.com)

## TABLE OF CONTENTS

The EDR-Site Report™ is a comprehensive presentation of government filings on a facility identified in a search of federal, state and local environmental databases. The report is divided into three sections:

### Section 1: Facility Summary ..... Page 3

Summary of facility filings including a review of the following areas: waste management, waste disposal, multi-media issues, and Superfund liability.

### Section 2: Facility Detail Reports ..... Page 4

All available detailed information from databases where sites are identified.

### Section 3: Databases and Update Information. .... Page 6

Name, source, update dates, contact phone number and description of each of the databases for this report.

*Thank you for your business.*  
Please contact EDR at 1-800-352-0050  
with any questions or comments.

#### Disclaimer - Copyright and Trademark Notice

This report contains information obtained from a variety of public and other sources reasonably available to Environmental Data Resources, Inc. It cannot be concluded from this Report that coverage information for the target and surrounding properties does not exist from other sources. NO WARRANTY EXPRESSED OR IMPLIED, IS MADE WHATSOEVER IN CONNECTION WITH THIS REPORT. ENVIRONMENTAL DATA RESOURCES, INC. SPECIFICALLY DISCLAIMS THE MAKING OF ANY SUCH WARRANTIES, INCLUDING WITHOUT LIMITATION, MERCHANTABILITY OR FITNESS FOR A PARTICULAR USE OR PURPOSE. ALL RISK IS ASSUMED BY THE USER. IN NO EVENT SHALL ENVIRONMENTAL DATA RESOURCES, INC. BE LIABLE TO ANYONE, WHETHER ARISING OUT OF ERRORS OR OMISSIONS, NEGLIGENCE, ACCIDENT OR ANY OTHER CAUSE, FOR ANY LOSS OR DAMAGE, INCLUDING, WITHOUT LIMITATION, SPECIAL, INCIDENTAL, CONSEQUENTIAL, OR EXEMPLARY DAMAGES. ANY LIABILITY ON THE PART OF ENVIRONMENTAL DATA RESOURCES, INC. IS STRICTLY LIMITED TO A REFUND OF THE AMOUNT PAID FOR THIS REPORT. Purchaser accepts this report "AS IS". Any analyses, estimates, ratings, or risk codes provided in this report are provided for illustrative purposes only, and are not intended to provide, nor should they be interpreted as providing any facts regarding, or prediction or forecast of, any environmental risk for any property. Only a Phase I Environmental Site Assessment performed by an environmental professional can produce information regarding the environmental risk for any property. Additionally, the information provided in this Report is not to be construed as legal advice.

Copyright 2008 by Environmental Data Resources, Inc. All rights reserved. Reproduction in any media or format, in whole or in part, of any report or map of Environmental Data Resources, Inc., or its affiliates, is prohibited without prior written permission.

EDR and its logos (including Sanborn and Sanborn Map) are trademarks of Environmental Data Resources, Inc. or its affiliates. All other trademarks used herein are the property of their respective owners.

## SECTION 1: FACILITY SUMMARY

FACILITY	FACILITY 1
AREA	MIKI BASIN GENERATING STATION 1001 N MIKI RD LANAI CITY, HI 96763 EDR ID #S107768303
<b>WASTE MANAGEMENT</b> Facility generates hazardous waste (RCRA)	NO
Facility treats, stores, or disposes of hazardous waste on-site (RCRA/TSD)	NO
Facility has received Notices of Violations (RCRA/VIOL)	NO
Facility has been subject to RCRA administrative actions (RAATS)	NO
Facility has been subject to corrective actions (CORRACTS)	NO
Facility handles PCBs (PADS)	NO
Facility uses radioactive materials (MLTS)	NO
Facility manages registered aboveground storage tanks (AST)	NO
Facility manages registered underground storage tanks (UST)	NO
Facility has reported leaking underground storage tank incidents (LUST)	NO
Facility has reported emergency releases to the soil (ERNS)	NO
Facility has reported hazardous material incidents to DOT (HMIRS)	NO
<b>WASTE DISPOSAL</b> Facility is a Superfund Site (NPL)	NO
Facility has a known or suspect abandoned, inactive or uncontrolled hazardous waste site (CERCLIS)	NO
Facility has a reported Superfund Lien on it (LIENS)	NO
Facility is listed as a state hazardous waste site (SHWS)	NO
Facility has disposed of solid waste on-site (SWF/LF)	NO
<b>MULTIMEDIA</b> Facility uses toxic chemicals and has notified EPA under SARA Title III, Section 313 (TRIS)	NO
Facility produces pesticides and has notified EPA under Section 7 of FIFRA (SSTS)	NO
Facility manufactures or imports toxic chemicals on the TSCA list (TSCA)	NO
Facility has inspections under FIFRA, TSCA or EPCRA (FTTS)	NO
Facility is listed in EPA's index system (FINDS)	NO
Facility is listed in other database records (OTHER)	YES - p4
<b>POTENTIAL SUPERFUND LIABILITY</b> Facility has a list of potentially responsible parties PRP	NO
<b>TOTAL (YES)</b>	1

## SECTION 2: FACILITY DETAIL REPORTS

### MULTIMEDIA

Facility is listed in other database records

DATABASE: Other Database Records (OTHER)

MIKI BASIN GENERATING STATION  
1001 N MIKI RD  
LANAI CITY, HI 96763  
EDR ID #S107769303

HI SPILLS:  
Island: Lanai  
Supplemental Loc. Text: Not reported  
Case Number: 20100524-0912  
HID Number: Not reported  
Facility Registry Id: Not reported  
Lead and Program: HEER EP&R  
ER: None  
Units: Diesel Generator "EMD 3"  
Substances: Lube Oil  
Less Or Greater Than: Not reported  
Numerical Quantity: 5  
Units: Gallons  
Activity Type: Response  
Activity Lead: Curtis Martin  
Assignment End Date: 2010-05-24 00:00:00  
Result: SOSOC NFA  
File Under: MECO-Lanai City Generating Station

Island: Lanai  
Supplemental Loc. Text: Not reported  
Case Number: 20070816-1030  
HID Number: Not reported  
Facility Registry Id: Not reported  
Lead and Program: HEER EP&R  
ER: No  
Units: Diesel Generating Unit 4  
Substances: Engine Oil 40SAE  
Less Or Greater Than: Not reported  
Numerical Quantity: 5  
Units: Gallons  
Activity Type: Response  
Activity Lead: Paul Chong  
Assignment End Date: 2007-09-14 00:00:00  
Result: SOSOC NFA  
File Under: MECO-Lanai City Generating Station

Island: Lanai  
Supplemental Loc. Text: Not reported  
Case Number: 20121026-1501  
HID Number: Not reported  
Facility Registry Id: Not reported  
Lead and Program: HEER EP&R  
ER: None  
Units: MECO lub oil release  
Substances: Lube Oil  
Less Or Greater Than: >  
Numerical Quantity: 5  
Units: Gallons  
Activity Type: Response  
Activity Lead: Curtis Martin  
Assignment End Date: Not reported  
Result: Not reported  
File Under: Not reported

AIRS:  
Facility ID: 0030-06-C  
Island: Lanai  
Mailing Address: P.O. Box 398  
Locale: Not reported  
Mailing City, ST, Zip: Kahului, HI 96732  
Business Phone: Not reported  
Contact Name: Michael Ribao  
Contact Title: Manager, Power Supply Department  
Description: Eight (8) Diesel Engine Generators This permit encompasses the following equipment: Attachment IIA: Unit Nos. Description 1-51.0 MW General Motors Electro-Motive Division (EMD) diesel engine generators (DEGs) (model no. 567-C, serial nos. 51-H-164; 54-C-141; 56-F-135; 56-G-13; 56-H-59; and 62-J-72, respectively), fired on fuel oil no. 2

## SECTION 2: FACILITY DETAIL REPORTS

...Continued...

and spec used oil Attachment IIB: Unit Nos. Description 7.82.2 MW Caterpillar diesel engine generators (DEGs) (model no. 3608, serial nos. 6MC00475 and 6MC00476 respectively), fired on fuel oil no. 2 and spec used oil

### SECTION 3: DATABASES AND UPDATE DATES

To maintain currency of the following federal, state and local databases, EDR contacts the appropriate government agency on a monthly or quarterly basis as required.

**Elapsed ASTM days:** Provides confirmation that this report meets or exceeds the 90-day updating requirement of the ASTM standard.

#### DATABASES FOUND IN THIS REPORT

##### HI SPILLS: Release Notifications

Source: Department of Health

Telephone: 808-586-4249

Releases of hazardous substances to the environment reported to the Office of Hazard Evaluation and Emergency Response since 1988.

Date of Government Version: 01/04/2014  
Database Release Frequency: Varies

Date of Last EDR Contact: 02/26/2014  
Date of Next Scheduled Update: 06/09/2014

##### HI AIRS: List of Permitted Facilities

Source: Department of Health

Telephone: 808-586-4200

A listing of permitted facilities in the state.

Date of Government Version: 01/01/2014  
Database Release Frequency: Varies

Date of Last EDR Contact: 01/03/2014  
Date of Next Scheduled Update: 04/21/2014

**MAUI ELECTRIC CO LTD MIKI BASIN**  
1001 N MIKI RD  
LANAI CITY, HI 96763

**Inquiry Number:**  
**March 31, 2014**

**EDR Site Report™**



6 Armstrong Road, 4th floor  
Shelton, CT 06484  
Toll Free: 800.352.0050  
[www.edrnet.com](http://www.edrnet.com)

## TABLE OF CONTENTS

The EDR-Site Report™ is a comprehensive presentation of government filings on a facility identified in a search of federal, state and local environmental databases. The report is divided into three sections:

### Section 1: Facility Summary ..... Page 3

Summary of facility filings including a review of the following areas: waste management, waste disposal, multi-media issues, and Superfund liability.

### Section 2: Facility Detail Reports ..... Page 4

All available detailed information from databases where sites are identified.

### Section 3: Databases and Update Information. .... Page 6

Name, source, update dates, contact phone number and description of each of the databases for this report.

*Thank you for your business.*  
Please contact EDR at 1-800-352-0050  
with any questions or comments.

## SECTION 1: FACILITY SUMMARY

FACILITY	FACILITY 1
AREA	MAUI ELECTRIC CO LTD MIKI BASIN POWER PL 1001 N MIKI RD LANAI CITY, HI 96763 EDR ID #S113183480
WASTE MANAGEMENT	
Facility generates hazardous waste (RCRA)	NO
Facility treats, stores, or disposes of hazardous waste on-site (RCRA/TSDF)	NO
Facility has received Notices of Violations (RCRA/VIOL)	NO
Facility has been subject to RCRA administrative actions (RAATS)	NO
Facility has been subject to corrective actions (CORRACTS)	NO
Facility handles PCBs (PADS)	NO
Facility uses radioactive materials (MLTS)	NO
Facility manages registered aboveground storage tanks (AST)	NO
Facility manages registered underground storage tanks (UST)	NO
Facility has reported leaking underground storage tank incidents (LUST)	NO
Facility has reported emergency releases to the soil (ERNS)	NO
Facility has reported hazardous material incidents to DOT (HMIRS)	NO
WASTE DISPOSAL	
Facility is a Superfund Site (NPL)	NO
Facility has a known or suspect abandoned, inactive or uncontrolled hazardous waste site (CERCLIS)	NO
Facility has a reported Superfund Lien on it (LIENS)	NO
Facility is listed as a state hazardous waste site (SHWS)	NO
Facility has disposed of solid waste on-site (SWF/LF)	NO
MULTIMEDIA	
Facility uses toxic chemicals and has notified EPA under SARA Title III, Section 313 (TRIS)	NO
Facility produces pesticides and has notified EPA under Section 7 of FIFRA (SSTS)	NO
Facility manufactures or imports toxic chemicals on the TSCA list (TSCA)	NO
Facility has inspections under FIFRA, TSCA or EPCRA (FTTS)	NO
Facility is listed in EPA's index system (FINDS)	NO
Facility is listed in other database records (OTHER)	YES - p4
POTENTIAL SUPERFUND LIABILITY	
Facility has a list of potentially responsible parties PRP	NO
TOTAL (YES)	1

#### Disclaimer - Copyright and Trademark Notice

This report contains information obtained from a variety of public and other sources reasonably available to Environmental Data Resources, Inc. It cannot be concluded from this Report that coverage information for the target and surrounding properties does not exist from other sources. NO WARRANTY EXPRESSED OR IMPLIED, IS MADE WHATSOEVER IN CONNECTION WITH THIS REPORT. ENVIRONMENTAL DATA RESOURCES, INC. SPECIFICALLY DISCLAIMS THE MAKING OF ANY SUCH WARRANTIES, INCLUDING WITHOUT LIMITATION, MERCHANTABILITY OR FITNESS FOR A PARTICULAR USE OR PURPOSE. ALL RISK IS ASSUMED BY THE USER. IN NO EVENT SHALL ENVIRONMENTAL DATA RESOURCES, INC. BE LIABLE TO ANYONE, WHETHER ARISING OUT OF ERRORS OR OMISSIONS, NEGLIGENCE, ACCIDENT OR ANY OTHER CAUSE, FOR ANY LOSS OR DAMAGE, INCLUDING, WITHOUT LIMITATION, SPECIAL, INCIDENTAL, CONSEQUENTIAL, OR EXEMPLARY DAMAGES. ANY LIABILITY ON THE PART OF ENVIRONMENTAL DATA RESOURCES, INC. IS STRICTLY LIMITED TO A REFUND OF THE AMOUNT PAID FOR THIS REPORT. Purchaser accepts this report "AS IS". Any analyses, estimates, ratings, or risk codes provided in this report are provided for illustrative purposes only, and are not intended to provide, nor should they be interpreted as providing any facts regarding, or prediction or forecast of, any environmental risk for any property. Only a Phase I Environmental Site Assessment performed by an environmental professional can produce information regarding the environmental risk for any property. Additionally, the information provided in this Report is not to be construed as legal advice.

Copyright 2008 by Environmental Data Resources, Inc. All rights reserved. Reproduction in any media or format, in whole or in part, of any report or map of Environmental Data Resources, Inc., or its affiliates, is prohibited without prior written permission.

EDR and its logos (including Sanborn and Sanborn Map) are trademarks of Environmental Data Resources, Inc. or its affiliates. All other trademarks used herein are the property of their respective owners.

## SECTION 2: FACILITY DETAIL REPORTS

### MULTIMEDIA

Facility is listed in other database records

### DATABASE: Other Database Records (OTHER)

MAUI ELECTRIC CO LTD MIKI BASIN POWER PL  
1001 N MIKI RD  
LANAI CITY, HI 96763  
EDR ID #S113183480

HAZNET:  
Year: 2003  
Gepaid: HIR000000141  
Contact: ED OYAMA  
Telephone: 8085656453  
Mailing Name: Not reported  
Mailing Address: 1001 N MIKI RD  
Mailing City,St,Zip: LANAI CITY, HI 96763  
Gen County: Not reported  
TSD EPA ID: CAT000646117  
TSD County: Not reported  
Waste Category: Polychlorinated biphenyls and material containing PCBs  
Disposal Method: Transfer Station  
Tons: 0.35  
Facility County: 99

Year: 2003  
Gepaid: HIR000000141  
Contact: ED OYAMA  
Telephone: 8085656453  
Mailing Name: Not reported  
Mailing Address: 1001 N MIKI RD  
Mailing City,St,Zip: LANAI CITY, HI 96763  
Gen County: Not reported  
TSD EPA ID: CAT000646117  
TSD County: Not reported  
Waste Category: Polychlorinated biphenyls and material containing PCBs  
Disposal Method: Disposal, Land Fill  
Tons: 0.25  
Facility County: 99

Year: 2003  
Gepaid: HIR000000141  
Contact: ED OYAMA  
Telephone: 8085656453  
Mailing Name: Not reported  
Mailing Address: 1001 N MIKI RD  
Mailing City,St,Zip: LANAI CITY, HI 96763  
Gen County: Not reported  
TSD EPA ID: CAT000646117  
TSD County: Not reported  
Waste Category: Liquids with polychlorinated biphenyls >= 50 Mg/L  
Disposal Method: Transfer Station  
Tons: 0.14  
Facility County: 99

Year: 2002  
Gepaid: HIR000000141  
Contact: ED OYAMA  
Telephone: 8085656453  
Mailing Name: Not reported  
Mailing Address: 1001 N MIKI RD  
Mailing City,St,Zip: LANAI CITY, HI 96763  
Gen County: Not reported  
TSD EPA ID: CAT000646117  
TSD County: Not reported  
Waste Category: Polychlorinated biphenyls and material containing PCBs  
Disposal Method: Transfer Station  
Tons: 2.45  
Facility County: 99

Year: 2002  
Gepaid: HIR000000141  
Contact: ED OYAMA  
Telephone: 8085656453  
Mailing Name: Not reported  
Mailing Address: 1001 N MIKI RD  
Mailing City,St,Zip: LANAI CITY, HI 96763  
Gen County: Not reported  
TSD EPA ID: CAT000646117

## SECTION 2: FACILITY DETAIL REPORTS

...Continued...

TSD County: Not reported  
Waste Category: Polychlorinated biphenyls and material containing PCBs  
Disposal Method: Disposal, Land Fill  
Tons: 4.11  
Facility County: 99

Year: 2001  
Gepaid: HIR000000141  
Contact: ED OYAMA  
Telephone: 8085656453  
Mailing Name: Not reported  
Mailing Address: 1001 N MIKI RD  
Mailing City,St,Zip: LANAI CITY, HI 96763  
Gen County: Not reported  
TSD EPA ID: CAT000646117  
TSD County: Not reported  
Waste Category: Polychlorinated biphenyls and material containing PCBs  
Disposal Method: Transfer Station  
Tons: 0.15  
Facility County: 99

Year: 2001  
Gepaid: HIR000000141  
Contact: ED OYAMA  
Telephone: 8085656453  
Mailing Name: Not reported  
Mailing Address: 1001 N MIKI RD  
Mailing City,St,Zip: LANAI CITY, HI 96763  
Gen County: Not reported  
TSD EPA ID: CAT000646117  
TSD County: Not reported  
Waste Category: Polychlorinated biphenyls and material containing PCBs  
Disposal Method: Disposal, Land Fill  
Tons: 0.07  
Facility County: 99

Year: 2000  
Gepaid: HIR000000141  
Contact: ED OYAMA  
Telephone: 8085656453  
Mailing Name: Not reported  
Mailing Address: 1001 N MIKI RD  
Mailing City,St,Zip: LANAI CITY, HI 96763  
Gen County: Not reported  
TSD EPA ID: CAT000646117  
TSD County: Not reported  
Waste Category: Polychlorinated biphenyls and material containing PCBs  
Disposal Method: Transfer Station  
Tons: 0.77  
Facility County: 99

Year: 2000  
Gepaid: HIR000000141  
Contact: ED OYAMA  
Telephone: 8085656453  
Mailing Name: Not reported  
Mailing Address: 1001 N MIKI RD  
Mailing City,St,Zip: LANAI CITY, HI 96763  
Gen County: Not reported  
TSD EPA ID: CAT000646117  
TSD County: Not reported  
Waste Category: Polychlorinated biphenyls and material containing PCBs  
Disposal Method: Disposal, Land Fill  
Tons: 0.15  
Facility County: 99

### SECTION 3: DATABASES AND UPDATE DATES

To maintain currency of the following federal, state and local databases, EDR contacts the appropriate government agency on a monthly or quarterly basis as required.

**Elapsed ASTM days:** Provides confirmation that this report meets or exceeds the 90-day updating requirement of the ASTM standard.

#### DATABASES FOUND IN THIS REPORT

**CA HAZNET: Facility and Manifest Data**  
Source: California Environmental Protection Agency  
Telephone: 916-255-1136

Facility and Manifest Data. The data is extracted from the copies of hazardous waste manifests received each year by the DTSC. The annual volume of manifests is typically 700,000 - 1,000,000 annually, representing approximately 350,000 - 500,000 shipments. Data are from the manifests submitted without correction, and therefore many contain some invalid values for data elements such as generator ID, TSD ID, waste category, and disposal method.

Date of Government Version: 12/31/2012  
Database Release Frequency: Annually

Date of Last EDR Contact: 01/17/2014  
Date of Next Scheduled Update: 04/28/2014

**MIKI BASIN GENERATING STATION**  
1001 NORTH MIKI RD.  
LANAI CITY, HI 96763

Inquiry Number:  
March 31, 2014

EDR Site Report™



6 Armstrong Road, 4th floor  
Shelton, CT 06484  
Toll Free: 800.352.0050  
www.edrnet.com



## TABLE OF CONTENTS

The EDR-Site Report™ is a comprehensive presentation of government filings on a facility identified in a search of federal, state and local environmental databases. The report is divided into three sections:

### Section 1: Facility Summary ..... Page 3

Summary of facility filings including a review of the following areas: waste management, waste disposal, multi-media issues, and Superfund liability.

### Section 2: Facility Detail Reports ..... Page 4

All available detailed information from databases where sites are identified.

### Section 3: Databases and Update Information ..... Page 7

Name, source, update dates, contact phone number and description of each of the databases for this report.

*Thank you for your business.*  
Please contact EDR at 1-800-352-0050  
with any questions or comments.

#### Disclaimer - Copyright and Trademark Notice

This report contains information obtained from a variety of public and other sources reasonably available to Environmental Data Resources, Inc. It cannot be concluded from this Report that coverage information for the target and surrounding properties does not exist from other sources. NO WARRANTY EXPRESSED OR IMPLIED, IS MADE WHATSOEVER IN CONNECTION WITH THIS REPORT. ENVIRONMENTAL DATA RESOURCES, INC. SPECIFICALLY DISCLAIMS THE MAKING OF ANY SUCH WARRANTIES, INCLUDING WITHOUT LIMITATION, MERCHANTABILITY OR FITNESS FOR A PARTICULAR USE OR PURPOSE. ALL RISK IS ASSUMED BY THE USER. IN NO EVENT SHALL ENVIRONMENTAL DATA RESOURCES, INC. BE LIABLE TO ANYONE, WHETHER ARISING OUT OF ERRORS OR OMISSIONS, NEGLIGENCE, ACCIDENT OR ANY OTHER CAUSE, FOR ANY LOSS OR DAMAGE, INCLUDING, WITHOUT LIMITATION, SPECIAL, INCIDENTAL, CONSEQUENTIAL, OR EXEMPLARY DAMAGES. ANY LIABILITY ON THE PART OF ENVIRONMENTAL DATA RESOURCES, INC. IS STRICTLY LIMITED TO A REFUND OF THE AMOUNT PAID FOR THIS REPORT. Purchaser accepts this report "AS IS". Any analyses, estimates, ratings, or risk codes provided in this report are provided for illustrative purposes only, and are not intended to provide, nor should they be interpreted as providing any facts regarding, or prediction or forecast of, any environmental risk for any property. Only a Phase I Environmental Site Assessment performed by an environmental professional can produce information regarding the environmental risk for any property. Additionally, the information provided in this Report is not to be construed as legal advice.

Copyright 2008 by Environmental Data Resources, Inc. All rights reserved. Reproduction in any media or format, in whole or in part, of any report or map of Environmental Data Resources, Inc., or its affiliates, is prohibited without prior written permission.

EDR and its logos (including Sanborn and Sanborn Map) are trademarks of Environmental Data Resources, Inc. or its affiliates. All other trademarks used herein are the property of their respective owners.

## SECTION 1: FACILITY SUMMARY

FACILITY	FACILITY 1
AREA	MIKI BASIN GENERATING STATION 1001 NORTH MIKI RD. LANAI CITY, HI 96763 EDR ID #1007092130 EPA #H1R000000141
<b>WASTE MANAGEMENT</b>	
Facility generates hazardous waste (RCRA)	YES - p4
Facility treats, stores, or disposes of hazardous waste on-site (RCRA/TSD)	NO
Facility has received Notices of Violations (RCRA/VIOL)	NO
Facility has been subject to RCRA administrative actions (RAATS)	NO
Facility has been subject to corrective actions (CORRACTS)	NO
Facility handles PCBs (PADS)	YES - p6
Facility uses radioactive materials (MLTS)	NO
Facility manages registered aboveground storage tanks (AST)	NO
Facility manages registered underground storage tanks (UST)	NO
Facility has reported leaking underground storage tank incidents (LUST)	NO
Facility has reported emergency releases to the soil (ERNS)	NO
Facility has reported hazardous material incidents to DOT (HMIRS)	NO
<b>WASTE DISPOSAL</b>	
Facility is a Superfund Site (NPL)	NO
Facility has a known or suspect abandoned, inactive or uncontrolled hazardous waste site (CERCLIS)	NO
Facility has a reported Superfund Lien on it (LIENS)	NO
Facility is listed as a state hazardous waste site (SHWS)	NO
Facility has disposed of solid waste on-site (SWF/LF)	NO
<b>MULTIMEDIA</b>	
Facility uses toxic chemicals and has notified EPA under SARA Title III, Section 313 (TRIS)	NO
Facility produces pesticides and has notified EPA under Section 7 of FIFRA (SSTS)	NO
Facility manufactures or imports toxic chemicals on the TSCA list (TSCA)	NO
Facility has inspections under FIFRA, TSCA or EPCRA (FTTS)	NO
Facility is listed in EPA's index system (FINDS)	NO
Facility is listed in other database records (OTHER)	NO
<b>POTENTIAL SUPERFUND LIABILITY</b>	
Facility has a list of potentially responsible parties PRP	NO
<b>TOTAL (YES)</b>	2

## SECTION 2: FACILITY DETAIL REPORTS

## SECTION 2: FACILITY DETAIL REPORTS

...Continued...

### WASTE MANAGEMENT

Facility generates hazardous waste

DATABASE: Resource Conservation and Recovery Information (RCRAInfo)

MIKI BASIN GENERATING STATION  
1001 NORTH MIKI RD.  
LANAI CITY, HI 96763  
EDR ID #1007092130

#### RCRA-CESQG:

Date form received by agency: 03/19/2003  
Facility name: MIKI BASIN GENERATING STATION  
Facility address: 1001 N MIKI RD  
LANAI CITY, HI 96763  
EPA ID: HIR000000141  
Mailing address: PO BOX 398  
KAHULUI, HI 96733-6898  
Contact: DONN FUKADA  
Contact address: 1001 N MIKI RD  
LANAI CITY, HI 96763  
Contact country: US  
Contact telephone: 808-543-4525  
Contact email: Not reported  
EPA Region: 09  
Classification: Conditionally Exempt Small Quantity Generator  
Description: Handler: generates 100 kg or less of hazardous waste per calendar month, and accumulates 1000 kg or less of hazardous waste at any time; or generates 1 kg or less of acutely hazardous waste per calendar month, and accumulates at any time: 1 kg or less of acutely hazardous waste; or 100 kg or less of any residue or contaminated soil, waste or other debris resulting from the cleanup of a spill, into or on any land or water, of acutely hazardous waste; or generates 100 kg or less of any residue or contaminated soil, waste or other debris resulting from the cleanup of a spill, into or on any land or water, of acutely hazardous waste during any calendar month, and accumulates at any time: 1 kg or less of acutely hazardous waste; or 100 kg or less of any residue or contaminated soil, waste or other debris resulting from the cleanup of a spill, into or on any land or water, of acutely hazardous waste

#### Owner/Operator Summary:

Owner/operator name: MAUI ELEC CO LTD  
Owner/operator address: Not reported  
Owner/operator country: US  
Owner/operator telephone: Not reported  
Legal status: Private  
Owner/Operator Type: Operator  
Owner/Op start date: 01/01/1994  
Owner/Op end date: Not reported  
  
Owner/operator name: MAUI ELEC CO LTD  
Owner/operator address: Not reported  
Owner/operator country: US  
Owner/operator telephone: Not reported  
Legal status: Private  
Owner/Operator Type: Owner  
Owner/Op start date: 01/01/1994  
Owner/Op end date: Not reported

#### Handler Activities Summary:

U.S. importer of hazardous waste: No  
Mixed waste (haz. and radioactive): No  
Recycler of hazardous waste: No  
Transporter of hazardous waste: No  
Treater, storer or disposer of HW: No  
Underground injection activity: No  
On-site burner exemption: No  
Furnace exemption: No  
Used oil fuel burner: No  
Used oil processor: No  
Used oil refiner: No  
Used oil fuel marketer to burner: No  
Used oil Specification marketer: Yes  
Used oil transfer facility: No  
Used oil transporter: No

#### Historical Generators:

Date form received by agency: 05/24/1995

Facility name: MIKI BASIN GENERATING STATION  
Site name: MAUI ELECTRIC CO LTD MIKI BASIN POWER PL  
Classification: Small Quantity Generator

#### Hazardous Waste Summary:

Waste code: D001  
Waste name: IGNITABLE HAZARDOUS WASTES ARE THOSE WASTES WHICH HAVE A FLASHPOINT OF LESS THAN 140 DEGREES FAHRENHEIT AS DETERMINED BY A PENSKEY-MARTENS CLOSED CUP FLASH POINT TESTER. ANOTHER METHOD OF DETERMINING THE FLASH POINT OF A WASTE IS TO REVIEW THE MATERIAL SAFETY DATA SHEET, WHICH CAN BE OBTAINED FROM THE MANUFACTURER OR DISTRIBUTOR OF THE MATERIAL. LACQUER THINNER IS AN EXAMPLE OF A COMMONLY USED SOLVENT WHICH WOULD BE CONSIDERED AS IGNITABLE HAZARDOUS WASTE.

Waste code: D006  
Waste name: CADMIUM

Waste code: D008  
Waste name: LEAD

Violation Status: No violations found

## SECTION 2: FACILITY DETAIL REPORTS

...Continued...

### WASTE MANAGEMENT

#### Facility handles PCBs

#### DATABASE: PCB Activity Database System (PADS)

MIKI BASIN GENERATING STATION  
1001 NORTH MIKI RD.  
LANAI CITY, HI 96763  
EDR ID #1007092130

PADS:  
EPAID: HIR000000141  
Facility name: MIKI BASIN GENERATING STATION  
Facility Address: 1001 NORTH MIKI RD.  
LANAI CITY, HI 96763  
Facility country: US  
Generator: Yes  
Storer: No  
Transporter: No  
Disposer: No  
Research facility: No  
Smelter: No  
Facility owner name: MAUI ELECTRIC CO., LTD  
Contact title: Not reported  
Contact name: Donn Fukuda  
Contact tel: (808)543-4525  
Contact extension: Not reported  
Mailing address: P.O. Box 630608  
Lanai City, HI 96763  
Mailing country: US  
Cert. title: Not reported  
Cert. name: Not reported  
Cert. date: 02/07/2005  
Date received: 03/24/2005

## SECTION 3: DATABASES AND UPDATE DATES

To maintain currency of the following federal, state and local databases, EDR contacts the appropriate government agency on a monthly or quarterly basis as required.

**Elapsed ASTM days:** Provides confirmation that this report meets or exceeds the 90-day updating requirement of the ASTM standard.

### DATABASES FOUND IN THIS REPORT

#### PADS: PCB Activity Database System

Source: EPA  
Telephone: 202-566-0500  
PCB Activity Database. PADS identifies generators, transporters, commercial storers and/or brokers and disposers of PCB's who are required to notify the EPA of such activities.  
Date of Government Version: 06/01/2013  
Database Release Frequency: Annually  
Date of Last EDR Contact: 01/28/2014  
Date of Next Scheduled Update: 04/28/2014

#### RCRA-CESQG: RCRA - Conditionally Exempt Small Quantity Generator

Source: Environmental Protection Agency  
Telephone: 703-308-8895  
RCRAinfo is EPA's comprehensive information system, providing access to data supporting the Resource Conservation and Recovery Act (RCRA) of 1976 and the Hazardous and Solid Waste Amendments (HSWA) of 1984. The database includes selective information on sites which generate, transport, store, treat and/or dispose of hazardous waste as defined by the Resource Conservation and Recovery Act (RCRA). Conditionally exempt small quantity generators (CESQGs) generate less than 100 kg of hazardous waste, or less than 1 kg of acutely hazardous waste per month.  
Date of Government Version: 09/10/2013  
Database Release Frequency: Varies  
Date of Last EDR Contact: 03/13/2014  
Date of Next Scheduled Update: 04/14/2014

## TABLE OF CONTENTS

The EDR-Site Report™ is a comprehensive presentation of government filings on a facility identified in a search of federal, state and local environmental databases. The report is divided into three sections:

**Section 1: Facility Summary . . . . . Page 3**

Summary of facility filings including a review of the following areas: waste management, waste disposal, multi-media issues, and Superfund liability.

**Section 2: Facility Detail Reports . . . . . Page 4**

All available detailed information from databases where sites are identified.

**Section 3: Databases and Update Information. . . . . Page 15**

Name, source, update dates, contact phone number and description of each of the databases for this report.

*Thank you for your business.*  
Please contact EDR at 1-800-352-0050  
with any questions or comments.

## EDR Site Report™

### Disclaimer - Copyright and Trademark Notice

This report contains information obtained from a variety of public and other sources reasonably available to Environmental Data Resources, Inc. It cannot be concluded from this Report that coverage information for the target and surrounding properties does not exist from other sources. NO WARRANTY EXPRESSED OR IMPLIED, IS MADE WHATSOEVER IN CONNECTION WITH THIS REPORT. ENVIRONMENTAL DATA RESOURCES, INC. SPECIFICALLY DISCLAIMS THE MAKING OF ANY SUCH WARRANTIES, INCLUDING WITHOUT LIMITATION, MERCHANTABILITY OR FITNESS FOR A PARTICULAR USE OR PURPOSE. ALL RISK IS ASSUMED BY THE USER. IN NO EVENT SHALL ENVIRONMENTAL DATA RESOURCES, INC. BE LIABLE TO ANYONE, WHETHER ARISING OUT OF ERRORS OR OMISSIONS, NEGLIGENCE, ACCIDENT OR ANY OTHER CAUSE, FOR ANY LOSS OR DAMAGE, INCLUDING, WITHOUT LIMITATION, SPECIAL, INCIDENTAL, CONSEQUENTIAL, OR EXEMPLARY DAMAGES. ANY LIABILITY ON THE PART OF ENVIRONMENTAL DATA RESOURCES, INC. IS STRICTLY LIMITED TO A REFUND OF THE AMOUNT PAID FOR THIS REPORT. Purchaser accepts this report "AS IS". Any analyses, estimates, ratings, or risk codes provided in this report are provided for illustrative purposes only, and are not intended to provide, nor should they be interpreted as providing any facts regarding, or prediction or forecast of, any environmental risk for any property. Only a Phase I Environmental Site Assessment performed by an environmental professional can produce information regarding the environmental risk for any property. Additionally, the information provided in this Report is not to be construed as legal advice.

Copyright 2008 by Environmental Data Resources, Inc. All rights reserved. Reproduction in any media or format, in whole or in part, of any report or map of Environmental Data Resources, Inc., or its affiliates, is prohibited without prior written permission.

EDR and its logos (including Sanborn and Sanborn Map) are trademarks of Environmental Data Resources, Inc. or its affiliates. All other trademarks used herein are the property of their respective owners.

### MAUI ELECTRIC CO - MIKI BASIN

1001 N MIKI RD  
LANAI CITY, HI 96763

Inquiry Number:  
March 31, 2014



6 Armstrong Road, 4th floor  
Shelton, CT 06484  
Toll Free 800.352.0050  
www.edrnet.com

## SECTION 1: FACILITY SUMMARY

FACILITY	FACILITY 1
AREA	MAUI ELECTRIC CO - MIKI BASIN 1001 N MIKI RD LANAI CITY, HI 96763 EDR ID #1001024214 EPA #110055402737
WASTE MANAGEMENT Facility generates hazardous waste (RCRA)	NO
Facility treats, stores, or disposes of hazardous waste on-site (RCRA/TSD)	NO
Facility has received Notices of Violations (RCRA/VIOL)	NO
Facility has been subject to RCRA administrative actions (RAATS)	NO
Facility has been subject to corrective actions (CORRACTS)	NO
Facility handles PCBs (PADS)	NO
Facility uses radioactive materials (MLTS)	NO
Facility manages registered aboveground storage tanks (AST)	NO
Facility manages registered underground storage tanks (UST)	NO
Facility has reported leaking underground storage tank incidents (LUST)	NO
Facility has reported emergency releases to the soil (ERNS)	NO
Facility has reported hazardous material incidents to DOT (HMIRS)	NO
WASTE DISPOSAL Facility is a Superfund Site (NPL)	NO
Facility has a known or suspect abandoned, inactive or uncontrolled hazardous waste site (CERCLIS)	NO
Facility has a reported Superfund Lien on it (LIENS)	NO
Facility is listed as a state hazardous waste site (SHWS)	NO
Facility has disposed of solid waste on-site (SWF/LF)	NO
MULTIMEDIA Facility uses toxic chemicals and has notified EPA under SARA Title III, Section 313 (TRIS)	NO
Facility produces pesticides and has notified EPA under Section 7 of FIFRA (SSTS)	NO
Facility manufactures or imports toxic chemicals on the TSCA list (TSCA)	NO
Facility has inspections under FIFRA, TSCA or EPCRA (FTTS)	NO
Facility is listed in EPA's index system (FINDS)	YES - p4
Facility is listed in other database records (OTHER)	YES - p9
POTENTIAL SUPERFUND LIABILITY Facility has a list of potentially responsible parties PRP	NO
TOTAL (YES)	2

## SECTION 2: FACILITY DETAIL REPORTS

### MULTIMEDIA

Facility is listed in EPA's index system

DATABASE: Facility Index System (FINDS)

MAUI ELECTRIC CO - MIKI BASIN  
1001 N MIKI RD  
LANAI CITY, HI 96763  
EDR ID #1001024214

This site is listed in the Federal FINDS database. The FINDS database may contain references to records from government databases included elsewhere in the report.  
Please note: the FINDS database may also contain references to out of date records formerly associated with the site.

Registry ID: 110001764029  
Facility Name: MAUI ELECTRIC CO (MECO) - MIKI BASIN GENERATING STATION  
Facility Address: 1001 N MIKI RD  
LANAI CITY, HI  
Facility URL: http://aspub.epa.gov/enviro/fii\_query\_detail\_disp\_program\_facility?p\_registry\_id=110001764029  
RPS: 15009  
Fed Facility: Not reported  
Tribal Land: Not reported  
Tribal Name: Not reported  
Congressional District: 02  
Hydrologic Unit Code: 20040000  
EPA Region: 09  
Site Type: STATIONARY  
Date Created: 01-MAR-00  
Date Updated: 29-AUG-13  
U.S.-Mexico Border: Not reported  
Latitude: 20.790646  
Longitude: -155.93382  
Horizontal Collection: Not reported  
Horizontal Accuracy: Not reported  
Reference Point: FACILITY CENTROID  
Horizontal Datum: NAD83  
Coordinates Source: Not reported  
Environmental Interest/Information System

AFS (Aerometric Information Retrieval System (AIRS) Facility Subsystem) replaces the former Compliance Data System (CDS), the National Emission Data System (NEDS), and the Storage and Retrieval of Aerometric Data (SAROAD). AIRS is the national repository for information concerning airborne pollution in the United States. AFS is used to track emissions and compliance data from industrial plants. AFS data are utilized by states to prepare State Implementation Plans to comply with regulatory programs and by EPA as an input for the estimation of total national emissions. AFS is undergoing a major redesign to support facility operating permits required under Title V of the Clean Air Act.

The NEI (National Emissions Inventory) database contains information on stationary and mobile sources that emit criteria air pollutants and their precursors, as well as hazardous air pollutants (HAPs).

US EPA TRIS (Toxics Release Inventory System) contains information from facilities on the amounts of over 300 listed toxic chemicals that these facilities release directly to air, water, land, or that are transported off-site.

US Emissions & Generation Resource Database (EGRID) contains data on emissions and resource mix for virtually every power plant and company that generates electricity in the United States.

RCRAInfo is a national information system that supports the Resource Conservation and Recovery Act (RCRA) program through the tracking of events and activities related to facilities that generate, transport, and treat, store, or dispose of hazardous waste. RCRAInfo allows RCRA program staff to track the notification, permit, compliance, and corrective action activities required under RCRA.

ELECTRIC GENERATOR

STATE MASTER

CRITERIA AND HAZARDOUS AIR POLLUTANT INVENTORY

US EPA RACT/BACT/LAER Clearinghouse (RBLC) database contains case-specific information on the "Best Available" air pollution technologies that have been required to reduce the emission of air pollutants from stationary sources (e.g., power plants, steel mills, chemical plants, etc.). RACT, or Reasonably Available Control Technology, is required on existing sources in areas that are not meeting national ambient air quality standards. BACT, or Best Available

## SECTION 2: FACILITY DETAIL REPORTS

...Continued...

Control Technology, is required on major new or modified sources in clean areas.  
LAER, or Lowest Achievable Emission Rate, is required on major new or modified sources in non-attainment areas.

Registry ID: 110055402737  
Facility Name: MIKI BASIN GENERATING STATION  
Facility Address: 1001 N MIKI RD  
LANAI CITY, HI  
Facility URL: http://iaspub.epa.gov/enviro/fil\_query\_detail\_disp\_program\_facility?p\_registry\_id=110055402737  
FIPS: Not reported  
Fed Facility: Not reported  
Tribal Land: Not reported  
Tribal Name: Not reported  
Congressional District: 01  
Hydrologic Unit Code: 20060000  
EPA Region: 09  
Site Type: STATIONARY  
Date Created: 23-JUL-13  
Date Updated: Not reported  
U.S.-Mexico Border: Not reported  
Latitude: 21.338271  
Longitude: -157.89732  
Horizontal Collection: ADDRESS MATCHING-OTHER  
Horizontal Accuracy: 149  
Reference Point: UNKNOWN  
Horizontal Datum: NAD83  
Coordinates Source: Not reported  
Environmental Interest/Information System  
Program System ID: 928711  
Program Sys. Name: EIS  
Env. Interest Type: CRITERIA AND HAZARDOUS AIR POLLUTANT INVENTORY  
Env. Interest Start Dt.: Not reported  
Start Date Qualifier: Not reported  
Env. Interest End Dt.: Not reported  
End Date Qualifier: Not reported  
Data Source: EIS  
Active Code: Yes  
  
Program System ID: 7264  
Program Sys. Name: EIA-860  
Env. Interest Type: ELECTRIC GENERATOR  
Env. Interest Start Dt.: Not reported  
Start Date Qualifier: Not reported  
Env. Interest End Dt.: Not reported  
End Date Qualifier: Not reported  
Data Source: EIA-860  
Active Code: Not reported  
  
Program System ID: 7264  
Program Sys. Name: EGRID  
Env. Interest Type: ELECTRIC POWER GENERATOR (OIL BASED)  
Env. Interest Start Dt.: Not reported  
Start Date Qualifier: Not reported  
Env. Interest End Dt.: Not reported  
End Date Qualifier: Not reported  
Data Source: EGRID  
Active Code: Not reported  
  
Program System ID: NEIH12543  
Program Sys. Name: NEI  
Env. Interest Type: CRITERIA AND HAZARDOUS AIR POLLUTANT INVENTORY  
Env. Interest Start Dt.: Not reported  
Start Date Qualifier: Not reported  
Env. Interest End Dt.: Not reported  
End Date Qualifier: Not reported  
Data Source: NEI  
Active Code: Not reported  
  
Program System ID: 3720  
Program Sys. Name: RBLC  
Env. Interest Type: AIR MAJOR  
Env. Interest Start Dt.: 04-MAY-96  
Start Date Qualifier: ORIGINAL PERMIT ISSUE DATE  
Env. Interest End Dt.: Not reported  
End Date Qualifier: Not reported  
Data Source: RBLC  
Active Code: Not reported  
  
Program System ID: HIR00000141  
Program Sys. Name: RCRINFO  
Env. Interest Type: CESQG  
Start Date Qualifier: 24-MAY-95  
Env. Interest End Dt.: Not reported  
End Date Qualifier: Not reported

## SECTION 2: FACILITY DETAIL REPORTS

...Continued...

Data Source: RCRINFO  
Active Code: Yes  
  
Program System ID: 1500900035  
Program Sys. Name: AIRS/AFS  
Env. Interest Type: AIR MAJOR  
Env. Interest Start Dt.: Not reported  
Start Date Qualifier: Not reported  
Env. Interest End Dt.: Not reported  
End Date Qualifier: Not reported  
Data Source: AIRS/AFS  
Active Code: Yes  
  
Program System ID: 96763MLCTR1001N  
Program Sys. Name: TRIS  
Env. Interest Type: TRI REPORTER  
Env. Interest Start Dt.: 31-DEC-00  
Start Date Qualifier: FIRST REPORTING YEAR  
Env. Interest End Dt.: Not reported  
End Date Qualifier: Not reported  
Data Source: TRI REPORTING FORM  
Active Code: Not reported  
  
Program System ID: 8315  
Program Sys. Name: HI-EHW  
Env. Interest Type: STATE MASTER  
Env. Interest Start Dt.: Not reported  
Start Date Qualifier: Not reported  
Env. Interest End Dt.: Not reported  
End Date Qualifier: Not reported  
Data Source: HI-EHW  
Active Code: Not reported  
  
Alternative Name: MAUI ELECTRIC CO LTD MIKI BASIN GENERATING STATION  
Alternative Name: MAUI ELECTRIC CO LTD MIKI BASIN POWER PL  
Alternative Name: MAUI ELECTRIC CO LTD, MIKI BASIN  
Alternative Name: MAUI ELECTRIC CO, LTD, MIKI BASIN GENERATING STATION  
Alternative Name: MAUI ELECTRIC COMPANY, LTD  
Alternative Name: MECO - MIKI BASIN POWER PLANT  
Alternative Name: MIKI BASIN  
  
Contact Name: DONN FUKADA  
Contact Type: REGULATORY CONTACT  
Contact Title: Not reported  
Contact Telephone: 808-543-4525  
Contact Fax: Not reported  
Contact email: Not reported  
Contact Address: 1001 N MIKI RD  
LANAI CITY, HI 96763  
  
Contact Name: KAUAI AWAI-DICKSON  
Contact Type: PUBLIC CONTACT  
Contact Title: Not reported  
Contact Telephone: (808) 872-3263  
Contact Fax: Not reported  
Contact email: Not reported  
Contact Address: Not reported  
  
Contact Name: VIRGIL KONG  
Contact Type: TECHNICAL CONTACT  
Contact Title: Not reported  
Contact Telephone: (808) 543-4517  
Contact Fax: Not reported  
Contact email: Not reported  
Contact Address: Not reported  
  
Contact Name: Not reported  
Contact Type: PUBLIC CONTACT  
Contact Title: Not reported  
Contact Telephone: Not reported  
Contact Fax: Not reported  
Contact email: Not reported  
Contact Address: MIKI BASIN GENERATING STATION  
LANAI,  
  
NAICS Code: 221112(FOSSIL FUEL ELECTRIC POWER GENERATION.)  
NAICS Code: 221121(ELECTRIC BULK POWER TRANSMISSION AND CONTROL.)  
  
SIC Code: 4911(ELECTRIC SERVICES)  
  
Organization Name: Not reported  
Affiliation Type: OWNER/OPERATOR  
Organization Type: PRIVATE

## SECTION 2: FACILITY DETAIL REPORTS

...Continued...

DUNS Number: 006927164  
Division Name: Not reported  
Telephone Number: Not reported  
Alternative Number: Not reported  
Fax Number: Not reported  
Email: Not reported  
EIN: Not reported  
State Business ID: Not reported  
Parent Name: Not reported  
Parent DUNS: Not reported  
Mailing Address: Not reported

Organization Name: MAUI ELECTRIC CO LTD  
Affiliation Type: OPERATOR  
Organization Type: Not reported  
DUNS Number: Not reported  
Division Name: Not reported  
Telephone Number: Not reported  
Alternative Number: Not reported  
Fax Number: Not reported  
Email: Not reported  
EIN: Not reported  
State Business ID: Not reported  
Parent Name: Not reported  
Parent DUNS: Not reported  
Mailing Address: Not reported

Organization Name: MAUI ELECTRIC CO LTD  
Affiliation Type: OWNER1  
Organization Type: Not reported  
DUNS Number: Not reported  
Division Name: Not reported  
Telephone Number: Not reported  
Alternative Number: Not reported  
Fax Number: Not reported  
Email: Not reported  
EIN: Not reported  
State Business ID: Not reported  
Parent Name: Not reported  
Parent DUNS: Not reported  
Mailing Address: Not reported

Organization Name: HAWAIIAN ELECTRIC INDUSTRIES INC  
Affiliation Type: PARENT COMPANY  
Organization Type: PRIVATE  
DUNS Number: 103901773  
Division Name: Not reported  
Telephone Number: Not reported  
Alternative Number: Not reported  
Fax Number: Not reported  
Email: Not reported  
EIN: Not reported  
State Business ID: Not reported  
Parent Name: Not reported  
Parent DUNS: Not reported  
Mailing Address: Not reported

Organization Name: MAUI ELECTRIC CO LTD  
Affiliation Type: OWNER/OPERATOR  
Organization Type: Not reported  
DUNS Number: Not reported  
Division Name: Not reported  
Telephone Number: Not reported  
Alternative Number: Not reported  
Fax Number: Not reported  
Email: Not reported  
EIN: Not reported  
State Business ID: Not reported  
Parent Name: Not reported  
Parent DUNS: Not reported  
Mailing Address: Not reported  
P O BOX 398  
KAHULUI - MAUI, HI 967320000

Organization Name: MAUI ELECTRIC COMPANY, LTD.  
Affiliation Type: OPERATOR  
Organization Type: PRIVATE  
DUNS Number: Not reported  
Division Name: Not reported  
Telephone Number: Not reported  
Alternative Number: Not reported

## SECTION 2: FACILITY DETAIL REPORTS

...Continued...

Fax Number: Not reported  
Email: Not reported  
EIN: Not reported  
State Business ID: Not reported  
Parent Name: Not reported  
Parent DUNS: Not reported  
Mailing Address: Not reported

Organization Name: MAUI ELECTRIC COMPANY, LTD.  
Affiliation Type: OWNER  
Organization Type: PRIVATE  
DUNS Number: Not reported  
Division Name: Not reported  
Telephone Number: Not reported  
Alternative Number: Not reported  
Fax Number: Not reported  
Email: Not reported  
EIN: Not reported  
State Business ID: Not reported  
Parent Name: Not reported  
Parent DUNS: Not reported  
Mailing Address: Not reported



## SECTION 2: FACILITY DETAIL REPORTS

...Continued...

### MULTIMEDIA

Facility is listed in other database records

DATABASE: Other Database Records (OTHER)

MAUI ELECTRIC CO - MIKI BASIN  
1001 N MIKI RD  
LANAI CITY, HI 96763  
EDR ID #1001024214

#### AIRS (AFS):

##### Compliance and Violation Data Major Sources:

EPA plant ID: 110001764029  
Plant name: MAUI ELECTRIC CO - MIKI BASIN  
Plant address: 1001 N MIKI RD  
LANAI CITY, HI 96763  
County: MAUI  
Region code: 09  
Dunn & Bradst #: Not reported  
Air quality cntl region: Not reported  
Sic code: 4911  
Sic code desc: ELECTRIC SERVICES  
North Am. industrial class: 221112  
NAIC code description: Fossil Fuel Electric Power Generation  
Default compliance status: IN COMPLIANCE - INSPECTION  
Default classification: ACTUAL OR POTENTIAL EMISSIONS ARE ABOVE THE APPLICABLE MAJOR SOURCE THRESHOLDS  
Govt facility: ALL OTHER FACILITIES NOT OWNED OR OPERATED BY A FEDERAL, STATE, OR LOCAL GOVERNMENT  
Current HPV: Not reported

##### Compliance and Enforcement Major Issues:

Air program: SIP SOURCE  
National action type: MULTI MEDIA INSPECTION - LEVEL 2 OR GREATER  
Date achieved: 000825  
Penalty amount: 000000000  
  
Air program: TITLE V PERMITS  
National action type: MULTI MEDIA INSPECTION - LEVEL 2 OR GREATER  
Date achieved: 010827  
Penalty amount: 000000000  
  
Air program: SIP SOURCE  
National action type: MULTI MEDIA INSPECTION - LEVEL 2 OR GREATER  
Date achieved: 010827  
Penalty amount: 000000000  
  
Air program: TITLE V PERMITS  
National action type: S/L REQ (O/O COND) STACK TEST/NOT OBSV BUT REVWD  
Date achieved: 020529  
Penalty amount: Not reported  
  
Air program: TITLE V PERMITS  
National action type: COMPLIANCE CERTIFICATION STATE REVIEW  
Date achieved: 020809  
Penalty amount: Not reported  
  
Air program: TITLE V PERMITS  
National action type: STATE CONDUCTED FCE / ON-SITE  
Date achieved: 020809  
Penalty amount: Not reported  
  
Air program: TITLE V PERMITS  
National action type: S/L REQ (O/O COND) STACK TEST/NOT OBSV BUT REVWD  
Date achieved: 020816  
Penalty amount: Not reported  
  
Air program: TITLE V PERMITS  
National action type: STATE DAY 0  
Date achieved: 030530  
Penalty amount: Not reported  
  
Air program: TITLE V PERMITS  
National action type: NXXXXX  
Date achieved: 030530  
Penalty amount: Not reported  
  
Air program: TITLE V PERMITS  
National action type: NXXXXX

## SECTION 2: FACILITY DETAIL REPORTS

...Continued...

Date achieved: 030531  
Penalty amount: 000004900  
  
Air program: TITLE V PERMITS  
National action type: SV RESOLVED  
Date achieved: 030707  
Penalty amount: Not reported  
  
Air program: TITLE V PERMITS  
National action type: S/L REQ (O/O COND) STACK TEST/NOT OBSV BUT REVWD  
Date achieved: 030904  
Penalty amount: Not reported  
  
Air program: TITLE V PERMITS  
National action type: COMPLIANCE CERTIFICATION STATE REVIEW  
Date achieved: 030904  
Penalty amount: Not reported  
  
Air program: TITLE V PERMITS  
National action type: STATE CONDUCTED FCE / ON-SITE  
Date achieved: 030904  
Penalty amount: Not reported  
  
Air program: TITLE V PERMITS  
National action type: TITLE V COMPLIANCE CERT DUE/RECEIVED BY  
Date achieved: 040402  
Penalty amount: Not reported  
  
Air program: TITLE V PERMITS  
National action type: COMPLIANCE CERTIFICATION EPA REVIEW  
Date achieved: 040720  
Penalty amount: Not reported  
  
Air program: TITLE V PERMITS  
National action type: S/L REQ (O/O COND) STACK TEST/NOT OBSV BUT REVWD  
Date achieved: 040722  
Penalty amount: Not reported  
  
Air program: TITLE V PERMITS  
National action type: COMPLIANCE CERTIFICATION STATE REVIEW  
Date achieved: 040722  
Penalty amount: Not reported  
  
Air program: TITLE V PERMITS  
National action type: STATE CONDUCTED FCE / ON-SITE  
Date achieved: 040722  
Penalty amount: Not reported  
  
Air program: TITLE V PERMITS  
National action type: S/L REQ (O/O COND) STACK TEST/NOT OBSV BUT REVWD  
Date achieved: 050811  
Penalty amount: Not reported  
  
Air program: TITLE V PERMITS  
National action type: COMPLIANCE CERTIFICATION STATE REVIEW  
Date achieved: 050811  
Penalty amount: Not reported  
  
Air program: TITLE V PERMITS  
National action type: STATE CONDUCTED FCE / ON-SITE  
Date achieved: 060404  
Penalty amount: Not reported  
  
Air program: TITLE V PERMITS  
National action type: COMPLIANCE CERTIFICATION STATE REVIEW  
Date achieved: 060725  
Penalty amount: Not reported  
  
Air program: TITLE V PERMITS  
National action type: STATE CONDUCTED FCE / ON-SITE  
Date achieved: 060725  
Penalty amount: Not reported  
  
Air program: TITLE V PERMITS  
National action type: TITLE V COMPLIANCE CERT DUE/RECEIVED BY  
Date achieved: 070403  
Penalty amount: Not reported  
  
Air program: TITLE V PERMITS  
National action type: STATE CONDUCTED FCE / ON-SITE

## SECTION 2: FACILITY DETAIL REPORTS

...Continued...

Date achieved:	070723
Penalty amount:	Not reported
Air program:	TITLE V PERMITS
National action type:	S/L REQ (O/O COND) STACK TEST/NOT OBSV BUT REVWD
Date achieved:	070723
Penalty amount:	Not reported
Air program:	TITLE V PERMITS
National action type:	COMPLIANCE CERTIFICATION STATE REVIEW
Date achieved:	070723
Penalty amount:	Not reported
Air program:	TITLE V PERMITS
National action type:	TITLE V COMPLIANCE CERT DUE/RECEIVED BY
Date achieved:	080325
Penalty amount:	Not reported
Air program:	TITLE V PERMITS
National action type:	S/L REQ (O/O COND) STACK TEST/NOT OBSV BUT REVWD
Date achieved:	080708
Penalty amount:	Not reported
Air program:	TITLE V PERMITS
National action type:	STATE CONDUCTED FCE / ON-SITE
Date achieved:	080708
Penalty amount:	Not reported
Air program:	TITLE V PERMITS
National action type:	COMPLIANCE CERTIFICATION STATE REVIEW
Date achieved:	080708
Penalty amount:	Not reported
Air program:	TITLE V PERMITS
National action type:	TITLE V COMPLIANCE CERT DUE/RECEIVED BY
Date achieved:	090331
Penalty amount:	Not reported
Air program:	TITLE V PERMITS
National action type:	STATE CONDUCTED FCE / ON-SITE
Date achieved:	090813
Penalty amount:	Not reported
Air program:	TITLE V PERMITS
National action type:	S/L REQ (O/O COND) STACK TEST/NOT OBSV BUT REVWD
Date achieved:	090813
Penalty amount:	Not reported
Air program:	TITLE V PERMITS
National action type:	COMPLIANCE CERTIFICATION STATE REVIEW
Date achieved:	090813
Penalty amount:	Not reported
Air program:	TITLE V PERMITS
National action type:	TITLE V COMPLIANCE CERT DUE/RECEIVED BY
Date achieved:	100518
Penalty amount:	Not reported
Air program:	TITLE V PERMITS
National action type:	COMPLIANCE CERTIFICATION STATE REVIEW
Date achieved:	100729
Penalty amount:	Not reported
Air program:	TITLE V PERMITS
National action type:	S/L REQ (O/O COND) STACK TEST/NOT OBSV BUT REVWD
Date achieved:	100729
Penalty amount:	Not reported
Air program:	TITLE V PERMITS
National action type:	STATE CONDUCTED FCE / ON-SITE
Date achieved:	100729
Penalty amount:	Not reported
Air program:	TITLE V PERMITS
National action type:	COMPLIANCE CERTIFICATION STATE REVIEW
Date achieved:	110719
Penalty amount:	Not reported
Air program:	TITLE V PERMITS
National action type:	S/L REQ (O/O COND) STACK TEST/NOT OBSV BUT REVWD
Date achieved:	110719
Penalty amount:	Not reported
Air program:	TITLE V PERMITS
National action type:	STATE CONDUCTED FCE / ON-SITE

## SECTION 2: FACILITY DETAIL REPORTS

...Continued...

Date achieved:	110719
Penalty amount:	Not reported
Air program:	TITLE V PERMITS
National action type:	COMPLIANCE CERTIFICATION STATE REVIEW
Date achieved:	120724
Penalty amount:	Not reported
Air program:	TITLE V PERMITS
National action type:	STATE CONDUCTED FCE / ON-SITE
Date achieved:	120724
Penalty amount:	Not reported
Air program:	TITLE V PERMITS
National action type:	S/L REQ (O/O COND) STACK TEST/NOT OBSV BUT REVWD
Date achieved:	120724
Penalty amount:	Not reported
Air program:	SIP SOURCE
National action type:	MULTI MEDIA INSPECTION - LEVEL 2 OR GREATER
Date achieved:	970402
Penalty amount:	000000000
Air program:	SIP SOURCE
National action type:	MULTI MEDIA INSPECTION - LEVEL 2 OR GREATER
Date achieved:	980407
Penalty amount:	000000000
Air program:	TITLE V PERMITS
National action type:	NXXXXX
Date achieved:	980810
Penalty amount:	000000000
Air program:	TITLE V PERMITS
National action type:	STATE CONSENT AGREEMENT FILED
Date achieved:	980810
Penalty amount:	000000000
Air program:	TITLE V PERMITS
National action type:	STATE DAY 0
Date achieved:	980810
Penalty amount:	000000000
Air program:	TITLE V PERMITS
National action type:	SV RESOLVED
Date achieved:	980810
Penalty amount:	000000000
Air program:	SIP SOURCE
National action type:	MULTI MEDIA INSPECTION - LEVEL 2 OR GREATER
Date achieved:	980819
Penalty amount:	000000000
Historical Compliance Minor Sources:	
State compliance status:	IN COMPLIANCE - INSPECTION
Hist compliance date:	1004
Air prog code hist file:	SIP SOURCE
State compliance status:	IN COMPLIANCE - INSPECTION
Hist compliance date:	1004
Air prog code hist file:	TITLE V PERMITS
State compliance status:	IN COMPLIANCE - INSPECTION
Hist compliance date:	1101
Air prog code hist file:	SIP SOURCE
State compliance status:	IN COMPLIANCE - INSPECTION
Hist compliance date:	1101
Air prog code hist file:	TITLE V PERMITS
State compliance status:	IN COMPLIANCE - INSPECTION
Hist compliance date:	1102
Air prog code hist file:	SIP SOURCE
State compliance status:	IN COMPLIANCE - INSPECTION
Hist compliance date:	1102
Air prog code hist file:	TITLE V PERMITS
State compliance status:	IN COMPLIANCE - INSPECTION
Hist compliance date:	1103
Air prog code hist file:	SIP SOURCE
State compliance status:	IN COMPLIANCE - INSPECTION
Hist compliance date:	1103

## SECTION 2: FACILITY DETAIL REPORTS

...Continued...

## SECTION 2: FACILITY DETAIL REPORTS

...Continued...

Air prog code hist file: TITLE V PERMITS

State compliance status: IN COMPLIANCE - INSPECTION  
Hist compliance date: 1104  
Air prog code hist file: SIP SOURCE

State compliance status: IN COMPLIANCE - INSPECTION  
Hist compliance date: 1104  
Air prog code hist file: TITLE V PERMITS

State compliance status: IN COMPLIANCE - INSPECTION  
Hist compliance date: 1201  
Air prog code hist file: SIP SOURCE

State compliance status: IN COMPLIANCE - INSPECTION  
Hist compliance date: 1201  
Air prog code hist file: TITLE V PERMITS

State compliance status: IN COMPLIANCE - INSPECTION  
Hist compliance date: 1202  
Air prog code hist file: SIP SOURCE

State compliance status: IN COMPLIANCE - INSPECTION  
Hist compliance date: 1202  
Air prog code hist file: TITLE V PERMITS

State compliance status: IN COMPLIANCE - INSPECTION  
Hist compliance date: 1203  
Air prog code hist file: SIP SOURCE

State compliance status: IN COMPLIANCE - INSPECTION  
Hist compliance date: 1203  
Air prog code hist file: TITLE V PERMITS

State compliance status: IN COMPLIANCE - INSPECTION  
Hist compliance date: 1204  
Air prog code hist file: SIP SOURCE

State compliance status: IN COMPLIANCE - INSPECTION  
Hist compliance date: 1204  
Air prog code hist file: TITLE V PERMITS

State compliance status: IN COMPLIANCE - INSPECTION  
Hist compliance date: 1301  
Air prog code hist file: SIP SOURCE

State compliance status: IN COMPLIANCE - INSPECTION  
Hist compliance date: 1301  
Air prog code hist file: TITLE V PERMITS

State compliance status: IN COMPLIANCE - INSPECTION  
Hist compliance date: 1302  
Air prog code hist file: SIP SOURCE

State compliance status: IN COMPLIANCE - INSPECTION  
Hist compliance date: 1302  
Air prog code hist file: TITLE V PERMITS

State compliance status: IN COMPLIANCE - INSPECTION  
Hist compliance date: 1303  
Air prog code hist file: SIP SOURCE

State compliance status: IN COMPLIANCE - INSPECTION  
Hist compliance date: 1303  
Air prog code hist file: TITLE V PERMITS

Permit Information:  
Compliance plant ID: 00035  
Permit number: 0030-06-C  
Permit category: V  
Permit category desc: TITLE V PERMIT - PLANT SP

Permit Source:  
Compliance plant ID: 00035  
Plant name: MAUI ELECTRIC CO - MIKI BASIN  
Plant address: 1001 N MIKI RD  
LANAI CITY, HI 96763

Event Information:  
Compliance permit ID: 00035  
Permit number: 0030-06-C  
Event action type: IF  
Event description: \*PERMIT AUTHORITY ISSUES FINAL PERMIT

Event action # 001  
Event date: 20021119

SECTION 3: DATABASES AND UPDATE DATES

To maintain currency of the following federal, state and local databases, EDR contacts the appropriate government agency on a monthly or quarterly basis as required.

Elapsed ASTM days: Provides confirmation that this report meets or exceeds the 90-day updating requirement of the ASTM standard.

DATABASES FOUND IN THIS REPORT

FINDS: Facility Index System/Facility Registry System

Source: EPA  
Telephone: Not reported  
Facility Index System. FINDS contains both facility information and 'pointers' to other sources that contain more detail. EDR includes the following FINDS databases in this report: PCS (Permit Compliance System), AIRS (Aerometric Information Retrieval System), DOCKET (Enforcement Docket used to manage and track information on civil judicial enforcement cases for all environmental statutes), FURS (Federal Underground Injection Control), C-DOCKET (Criminal Docket System used to track criminal enforcement actions for all environmental statutes), FFIS (Federal Facilities Information System), STATE (State Environmental Laws and Statutes), and PADS (PCB Activity Data System).  
Date of Government Version: 11/18/2013 Date of Last EDR Contact: 03/14/2014  
Database Release Frequency: Quarterly Date of Next Scheduled Update: 06/23/2014

US AIRS (AFS): Aerometric Information Retrieval System Facility Subsystem (AFS)

Source: EPA  
Telephone: 202-564-5962  
The database is a sub-system of Aerometric Information Retrieval System (AIRS). AFS contains compliance data on air pollution point sources regulated by the U.S. EPA and/or state and local air regulatory agencies. This information comes from source reports by various stationary sources of air pollution, such as electric power plants, steel mills, factories, and universities, and provides information about the air pollutants they produce. Action, air program, air program pollutant, and general level plant data. It is used to track emissions and compliance data from industrial plants.  
Date of Government Version: 10/23/2013 Date of Last EDR Contact: 03/31/2014  
Database Release Frequency: Annually Date of Next Scheduled Update: 07/14/2014

APPENDIX B

USER QUESTIONNAIRE

February 26, 2014

**ASTM E-1527 PHASE I ENVIRONMENTAL SITE ASSESSMENT  
PRE-SURVEY QUESTIONNAIRE AND DISCLOSURE STATEMENT**

**Borrower:** Please complete this questionnaire before the Consultant's site visit. For those questions that are not applicable to the subject please respond with an "N/A". This document must be signed by the Owner or his/her representative (Item No. 2). If you have any questions about how to answer any of the questions please call. If additional pages for response are necessary please attach them to this form. Clearly mark all references to the appropriate question number(s). This document and your written response to same will be an exhibit in our report.

**1. PROPERTY INFORMATION:**

Property Name: <i>200 ACR Industrial Park- Miki Basin</i>		
Property Address: <i>M.K. Road</i>		
City: <i>Lanai City</i>	State: <i>HI</i>	Zip: <i>96763</i>
Assessor's Parcel Number: <i>(2) 4-9-002-001</i>		

**2. COMPLETED BY**

Signature: <i>Thomas A. Houn</i>	Date: <i>3-20-14</i>
Printed Name: <i>Thomas A. Houn</i>	Title: <i>Director of Development + Construction</i>

**3. ASTM-REQUIRED INQUIRIES**

Property Owner: Name: <i>PULAMA LANAI</i> Phone: <i>808-565-9361</i> Fax:	
Key Site Manager (Site contact): Name: <i>Wayne Ishizaki</i> Phone: <i>808-565-9553</i> Fax:	
<b>If not residential Property, please provide list of tenants, including contact names and phone numbers.</b>	
Can you provide a Current Title Abstract for the Property, including a chain of Title? If so, please send documents along with completed questionnaire.	<input type="checkbox"/> Yes <input checked="" type="checkbox"/> No
Do you have knowledge of any environmental liens recorded against the Property, or environmentally related Activity and Use Limitations of the Property?	<input type="checkbox"/> Yes <input checked="" type="checkbox"/> No
Do you have any specialized knowledge that would be material in identifying recognized environmental conditions in connection with the Property?	<input type="checkbox"/> Yes <input checked="" type="checkbox"/> No
Are you aware of a reduction in the property value due to environmental issues?	<input type="checkbox"/> Yes <input checked="" type="checkbox"/> No
<b>Please attach explanation of all affirmative answers.</b>	



February 26, 2014

Please state reason for procuring this Phase I ESA:

☐ Qualify for Innocent Landowner defense to CERCLA Liability.

☒ Other: (state below) *As part of a study to pursue Land Use approval to use the land as an Industrial Park. It is currently zoned ag.*

**4. PLEASE PROVIDE A GENERAL SITE DESCRIPTION BY COMPLETING THE FOLLOWING TABLE:**

Legal description/ boundary survey/ plat available for inspector	<input type="checkbox"/> Yes <input checked="" type="checkbox"/> No
Total Property Size	<i>Site map provided previously</i>
Total number of buildings	<i>200 ACRES</i>
Total square footage of buildings	<i>0</i>
Date of construction	<i>0</i>
Dates of significant renovation	<i>N/A</i>
Waste water discharge	<input type="checkbox"/> Municipal Sanitary Sewer <input type="checkbox"/> On-site septic system <input checked="" type="checkbox"/> Other <i>N/A CURRENTLY</i>
Potable water source	<input type="checkbox"/> Community Water Supplier <input type="checkbox"/> On-site well <input checked="" type="checkbox"/> Other <i>N/A CURRENTLY</i>
Please describe prior use of property, if known:	

**5. PREVIOUS INVESTIGATIONS:**

Have any previous environmental investigations been performed at the site?	
<input type="checkbox"/> Yes <input checked="" type="checkbox"/> No	<i>NOT TO MY KNOWLEDGE</i>
<b>INVESTIGATION TYPE</b> If yes, please describe conclusions, and attach copy of report(s)	
<input type="checkbox"/> Phase 1 ESA	
<input type="checkbox"/> Phase 2 ESA	
<input type="checkbox"/> Tank Tightness Testing	
<input type="checkbox"/> Asbestos Survey/ O&M	
<input type="checkbox"/> Radon	
<input type="checkbox"/> Lead-based Paint	
<input type="checkbox"/> Lead in Water	
<input type="checkbox"/> Operations & Maintenance Plan(s)	
<input type="checkbox"/> Other	



February 26, 2014

# 6. ON SITE OPERATIONS

Are you aware of any of the following conditions, either past or present, on the site?		
Condition	Response	If yes, please describe
1. Stored Chemicals	<input type="checkbox"/> Yes <input checked="" type="checkbox"/> No	
2. Underground Storage Tanks	<input type="checkbox"/> Yes <input checked="" type="checkbox"/> No	
3. Aboveground Storage Tanks	<input type="checkbox"/> Yes <input checked="" type="checkbox"/> No	
4. Spills or Releases	<input type="checkbox"/> Yes <input checked="" type="checkbox"/> No	
5. Dump Areas/ Landfills	<input type="checkbox"/> Yes <input checked="" type="checkbox"/> No	
6. Waste Treatment Systems	<input type="checkbox"/> Yes <input checked="" type="checkbox"/> No	
7. Clarifiers/ Separators	<input type="checkbox"/> Yes <input checked="" type="checkbox"/> No	
8. Air stacks/ Vents/ Odors	<input type="checkbox"/> Yes <input checked="" type="checkbox"/> No	
9. Floor Drains/Sumps	<input type="checkbox"/> Yes <input checked="" type="checkbox"/> No	
10. Stained Soil/ Impacted Vegetation	<input type="checkbox"/> Yes <input checked="" type="checkbox"/> No	
11. On-site OWNED Electrical Transformers	<input type="checkbox"/> Yes <input checked="" type="checkbox"/> No	
12. Hydraulic lifts/ Elevators	<input type="checkbox"/> Yes <input checked="" type="checkbox"/> No	
13. Dry Cleaning Operations	<input type="checkbox"/> Yes <input checked="" type="checkbox"/> No	
14. Wetlands/ Flooding	<input type="checkbox"/> Yes <input checked="" type="checkbox"/> No	
15. Oil/ Gas/ Water/ Monitoring Wells	<input type="checkbox"/> Yes <input checked="" type="checkbox"/> No	
16. Environmental Cleanups	<input type="checkbox"/> Yes <input checked="" type="checkbox"/> No	
17. Environmental Permits	<input type="checkbox"/> Yes <input checked="" type="checkbox"/> No	If yes, please describe and ATTACH ALL COPIES of permits. Please attach last three waste manifests.
a) Industrial Discharge	<input type="checkbox"/> Yes <input checked="" type="checkbox"/> No	
b) POTW (NPDES)	<input type="checkbox"/> Yes <input checked="" type="checkbox"/> No	
c) Hazardous Waste Generator	<input type="checkbox"/> Yes <input checked="" type="checkbox"/> No	
d) Air Quality	<input type="checkbox"/> Yes <input checked="" type="checkbox"/> No	
e) Flammable Materials	<input type="checkbox"/> Yes <input checked="" type="checkbox"/> No	
f) AST/UST	<input type="checkbox"/> Yes <input checked="" type="checkbox"/> No	
g) Waste Manifest(s)	<input type="checkbox"/> Yes <input checked="" type="checkbox"/> No	
h) other	<input type="checkbox"/> Yes <input checked="" type="checkbox"/> No	

## APPENDIX C

## HISTORICAL RESEARCH DOCUMENTATION

