

Miki Basin - 200 Acre Industrial Site
Miki Road & Kaumalapau Highway
Lanai City, HI 96763

Inquiry Number: 3875991.2s
March 10, 2014

APPENDIX A

DATABASE RADIUS REPORT

The EDR Radius Map™ Report with GeoCheck®



6 Armstrong Road, 4th floor
Shelton, CT 06484
Toll Free: 800.352.0050
www.edrnet.com

FORM-LBC-KKT

REF-303

TABLE OF CONTENTS

SECTION	PAGE
Executive Summary.....	ES1
Overview Map.....	2
Detail Map.....	3
Map Findings Summary.....	4
Map Findings.....	7
Orphan Summary.....	8
Government Records Searched/Data Currency Tracking.....	GR-1

GEOCHECK ADDENDUM

Physical Setting Source Addendum.....	A-1
Physical Setting Source Summary.....	A-2
Physical Setting SSURGO Soil Map.....	A-5
Physical Setting Source Map.....	A-11
Physical Setting Source Map Findings.....	A-13
Physical Setting Source Records Searched.....	A-9

Thank you for your business.
Please contact EDR at 1-800-352-0050
with any questions or comments.

Disclaimer - Copyright and Trademark Notice

This Report contains certain information obtained from a variety of public and other sources reasonably available to Environmental Data Resources, Inc. It cannot be concluded from this Report that coverage information for the target and surrounding properties does not exist from other sources. NO WARRANTY EXPRESSED OR IMPLIED, IS MADE WHATSOEVER IN CONNECTION WITH THIS REPORT. ENVIRONMENTAL DATA RESOURCES, INC. SPECIFICALLY DISCLAIMS THE MAKING OF ANY SUCH WARRANTIES, INCLUDING WITHOUT LIMITATION, MERCHANTABILITY OR FITNESS FOR A PARTICULAR USE OR PURPOSE. ALL RISK IS ASSUMED BY THE USER. IN NO EVENT SHALL ENVIRONMENTAL DATA RESOURCES, INC. BE LIABLE TO ANYONE, WHETHER ARISING OUT OF ERRORS OR OMISSIONS, NEGLIGENCE, ACCIDENT OR ANY OTHER CAUSE, FOR ANY LOSS OF DAMAGE, INCLUDING, WITHOUT LIMITATION, SPECIAL, INCIDENTAL, CONSEQUENTIAL, OR EXEMPLARY DAMAGES. ANY LIABILITY ON THE PART OF ENVIRONMENTAL DATA RESOURCES, INC. IS STRICTLY LIMITED TO A REFUND OF THE AMOUNT PAID FOR THIS REPORT. Purchaser accepts this Report "AS IS". Any analyses, estimates, ratings, environmental risk levels or risk codes provided in this Report are provided for illustrative purposes only, and are not intended to provide, nor should they be interpreted as providing any facts regarding, or prediction or forecast of, any environmental risk for any property. Only a Phase I Environmental Site Assessment performed by an environmental professional can provide information regarding the environmental risk for any property. Additionally, the information provided in this Report is not to be construed as legal advice.

Copyright 2014 by Environmental Data Resources, Inc. All rights reserved. Reproduction in any media or format, in whole or in part, of any report or map of Environmental Data Resources, Inc., or its affiliates, is prohibited without prior written permission. EDR and its logos (including Sanborn and Sanborn Map) are trademarks of Environmental Data Resources, Inc. or its affiliates. All other trademarks used herein are the property of their respective owners.

EXECUTIVE SUMMARY

A search of available environmental records was conducted by Environmental Data Resources, Inc (EDR). The report was designed to assist parties seeking to meet the search requirements of EPA's Standards and Practices for All Appropriate Inquiries (40 CFR Part 312), the ASTM Standard Practice for Environmental Site Assessments (E 1527-13) or custom requirements developed for the evaluation of environmental risk associated with a parcel of real estate.

TARGET PROPERTY INFORMATION

ADDRESS

MIKI ROAD & KAUMALAPAU HIGHWAY
LANAI CITY, HI 96763

COORDINATES

Latitude (North): 20.7904000 - 20° 47' 25.44"
Longitude (West): 156.9375000 - 156° 56' 15.00"
Universal Transverse Mercator: Zone 4
UTM X (Meters): 714689.2
UTM Y (Meters): 2300187.0
Elevation: 1247 ft. above sea level

USGS TOPOGRAPHIC MAP ASSOCIATED WITH TARGET PROPERTY

Target Property Map: 20156-G8 ISLAND OF LANAI OE NW, HI
Most Recent Revision: Not reported

TARGET PROPERTY SEARCH RESULTS

The target property was not listed in any of the databases searched by EDR.

DATABASES WITH NO MAPPED SITES

No mapped sites were found in EDR's search of available ("reasonably ascertainable ") government records either on the target property or within the search radius around the target property for the following databases:

STANDARD ENVIRONMENTAL RECORDS

Federal NPL site list

NPL..... National Priority List
Proposed NPL..... Proposed National Priority List Sites
NPL LIENS..... Federal Superfund Liens

Federal Delisted NPL site list

Delisted NPL..... National Priority List Deletions

EXECUTIVE SUMMARY

Federal CERCLIS list

CERCLIS..... Comprehensive Environmental Response, Compensation, and Liability Information System
FEDERAL FACILITY..... Federal Facility Site Information listing

Federal CERCLIS NFRAP site List

CERC-NFRAP..... CERCLIS No Further Remedial Action Planned

Federal RCRA CORRACTS facilities list

CORRACTS..... Corrective Action Report

Federal RCRA non-CORRACTS TSD facilities list

RCRA-TSDF..... RCRA - Treatment, Storage and Disposal

Federal RCRA generators list

RCRA-LQG..... RCRA - Large Quantity Generators
RCRA-SQG..... RCRA - Small Quantity Generators
RCRA-CESQG..... RCRA - Conditionally Exempt Small Quantity Generator

Federal institutional controls / engineering controls registries

US ENG CONTROLS..... Engineering Controls Sites List
US INST CONTROL..... Sites with Institutional Controls
LUCIS..... Land Use Control Information System

Federal ERNS list

ERNS..... Emergency Response Notification System

State- and tribal - equivalent CERCLIS

SHWS..... Sites List

State and tribal landfill and/or solid waste disposal site lists

SWF/LF..... Permitted Landfills in the State of Hawaii

State and tribal leaking storage tank lists

LUST..... Leaking Underground Storage Tank Database
INDIAN LUST..... Leaking Underground Storage Tanks on Indian Land

State and tribal registered storage tank lists

INDIAN UST..... Underground Storage Tanks on Indian Land
FEMA UST..... Underground Storage Tank Listing

State and tribal institutional control / engineering control registries

ENG CONTROLS..... Engineering Control Sites

EXECUTIVE SUMMARY

INST CONTROL..... Sites with Institutional Controls

State and tribal voluntary cleanup sites

INDIAN VCP..... Voluntary Cleanup Priority Listing
VCP..... Voluntary Response Program Sites

State and tribal Brownfields sites

BROWNFIELDS..... Brownfields Sites

ADDITIONAL ENVIRONMENTAL RECORDS

Local Brownfield lists

US BROWNFIELDS..... A Listing of Brownfields Sites

Local Lists of Landfill / Solid Waste Disposal Sites

DEBRIS REGION 9..... Torres Martinez Reservation Illegal Dump Site Locations
ODI..... Open Dump Inventory
INDIAN ODI..... Report on the Status of Open Dumps on Indian Lands

Local Lists of Hazardous waste / Contaminated Sites

US CDL..... Clandestine Drug Labs
CDL..... Clandestine Drug Lab Listing
US HIST CDL..... National Clandestine Laboratory Register

Local Land Records

LIENS 2..... CERCLA Lien Information

Records of Emergency Release Reports

HMIRS..... Hazardous Materials Information Reporting System
SPILLS..... Release Notifications
SPILLS 90..... SPILLS 90 data from FirstSearch

Other Ascertainable Records

RCRA NonGen / NLR..... RCRA - Non Generators
DOT OPS..... Incident and Accident Data
DOD..... Department of Defense Sites
FUDS..... Formerly Used Defense Sites
CONSENT..... Superfund (CERCLA) Consent Decrees
ROD..... Records Of Decision
UMTRA..... Uranium Mill Tailings Sites
US MINES..... Mines Master Index File
TRIS..... Toxic Chemical Release Inventory System
TSCA..... Toxic Substances Control Act
FTTS..... FIFRA/ TSCA Tracking System - FIFRA (Federal Insecticide, Fungicide, & Rodenticide Act)/TSCA (Toxic Substances Control Act)
HIST FTTS..... FIFRA/TSCA Tracking System Administrative Case Listing

EXECUTIVE SUMMARY

SSTS.....	Section 7 Tracking Systems
ICIS.....	Integrated Compliance Information System
PADS.....	PCB Activity Database System
MLTS.....	Material Licensing Tracking System
RADINFO.....	Radiation Information Database
FINDS.....	Facility Index System/Facility Registry System
RAATS.....	RCRA Administrative Action Tracking System
RMP.....	Risk Management Plans
UIC.....	Underground Injection Wells Listing
DRYCLEANERS.....	Permitted Drycleaner Facility Listing
AIRS.....	List of Permitted Facilities
INDIAN RESERV.....	Indian Reservations
SCRD DRYCLEANERS.....	State Coalition for Remediation of Drycleaners Listing
LEAD SMELTERS.....	Lead Smelter Sites
2020 COR ACTION.....	2020 Corrective Action Program List
EPA WATCH LIST.....	EPA WATCH LIST
COAL ASH DOE.....	Steam-Electric Plant Operation Data
PCB TRANSFORMER.....	PCB Transformer Registration Database
COAL ASH EPA.....	Coal Combustion Residues Surface Impoundments List
US FIN ASSUR.....	Financial Assurance Information
US AIRS.....	Aerometric Information Retrieval System Facility Subsystem
PRP.....	Potentially Responsible Parties
Financial Assurance.....	Financial Assurance Information Listing

EDR HIGH RISK HISTORICAL RECORDS

EDR Exclusive Records

EDR MGP.....	EDR Proprietary Manufactured Gas Plants
EDR US Hist Auto Stat.....	EDR Exclusive Historic Gas Stations
EDR US Hist Cleaners.....	EDR Exclusive Historic Dry Cleaners

EDR RECOVERED GOVERNMENT ARCHIVES

Exclusive Recovered Govt. Archives

RGA LF.....	Recovered Government Archive Solid Waste Facilities List
RGA LUST.....	Recovered Government Archive Leaking Underground Storage Tank
RGA HWS.....	Recovered Government Archive State Hazardous Waste Facilities List

SURROUNDING SITES: SEARCH RESULTS

Surrounding sites were identified in the following databases.

Elevations have been determined from the USGS Digital Elevation Model and should be evaluated on a relative (not an absolute) basis. Relative elevation information between sites of close proximity should be field verified. Sites with an elevation equal to or higher than the target property have been differentiated below from sites with an elevation lower than the target property. Page numbers and map identification numbers refer to the EDR Radius Map report where detailed data on individual sites can be reviewed.

Sites listed in **bold italics** are in multiple databases.

Unmappable (orphan) sites are not considered in the foregoing analysis.

EXECUTIVE SUMMARY

STANDARD ENVIRONMENTAL RECORDS

State and tribal registered storage tank lists

UST: The Underground Storage Tank database contains registered USTs. USTs are regulated under Subtitle I of the Resource Conservation and Recovery Act (RCRA). The data come from the Department of Health's Listing of Underground Storage Tanks.

A review of the UST list, as provided by EDR, and dated 12/04/2013 has revealed that there is 1 UST site within approximately 0.25 miles of the target property.

Equal/Higher Elevation	Address	Direction / Distance	Map ID	Page
LANAI AIRPORT (PMID LNY620123)	LANAI AIRPORT	WNW 0 - 1/8 (0.001 mi.)	1	7

EXECUTIVE SUMMARY

Due to poor or inadequate address information, the following sites were not mapped. Count: 20 records.

Site Name	Database(s)
CASTLE & COOKE - MANELE BAY	US AIRS
MAUI ELECTRIC CO - MIKI BASIN	FINDS, US AIRS
DOLE PLANTATION	RCRA-TSDF, CERC-NFRAP, RCRA
	NonGen / NLR, FINDS
LANAI LANDFILL	SHWS, RGA HWS
DOLE PLANTATION (PALAWAI & 5319 BA	SHWS, RGA HWS
LANAI LDFL	CERC-NFRAP
LANAI DUMP SITE PALAWI BASIN	CERC-NFRAP
LANAI DRUM SITE NO. 3	CERC-NFRAP
LANAI DRUM SITE NO. 2	CERC-NFRAP
LANAI DUMP SITE	CERC-NFRAP
LANAI DRUM SITE NO. 1	CERC-NFRAP
TRANSPORTATION SECURITY ADMINISTRA	RCRA-CESQG
KAUMALAPAU PETROLEUM TERMINAL	RCRA-CESQG, FINDS
MIKI BASIN GENERATING STATION	RCRA-CESQG, PADS
FAA - LANAI	FINDS
CASTLE & COOKE - MANELE BAY	FINDS
MIKI BASIN PAVING & FENCING	FINDS
MORRIS, CHARLES AND ROSS, NORMAN -	FINDS
MIKI BASIN GENERATING STATION	SPILLS, AIRS
MAUI ELECTRIC CO LTD MIKI BASIN PO	HAZNET

OVERVIEW MAP - 3875991.2s

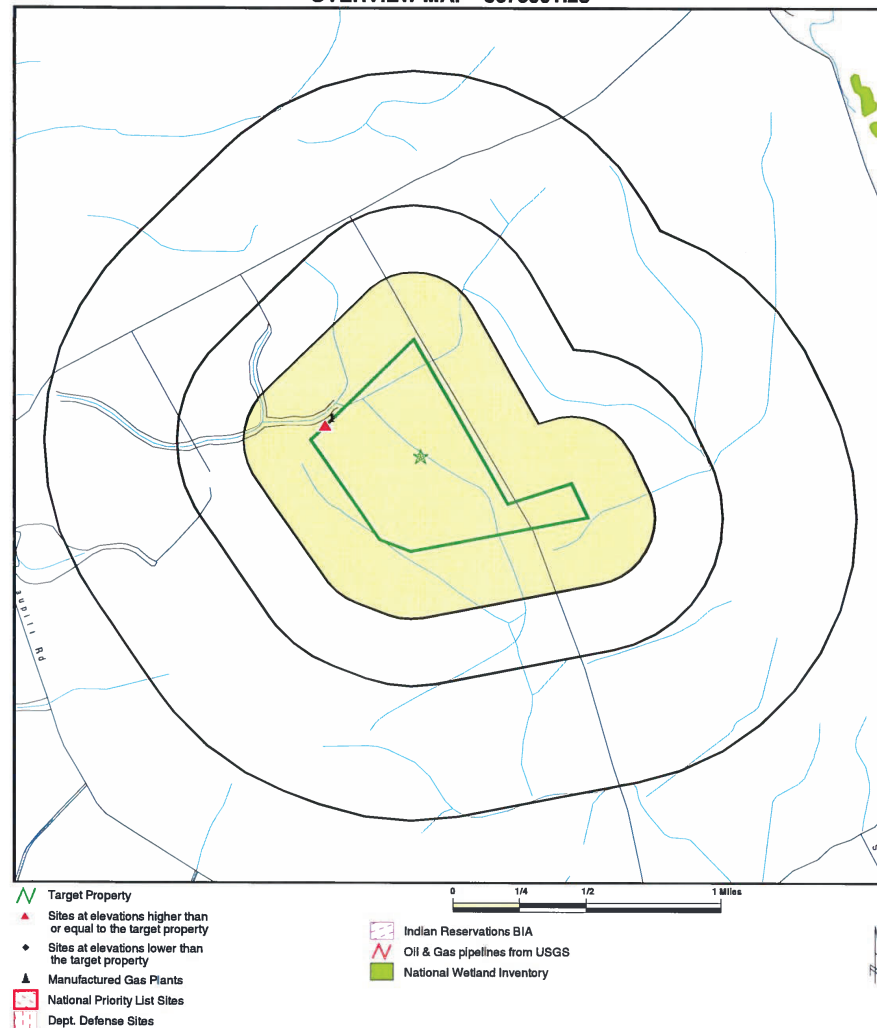

This report includes Interactive Map Layers to display and/or hide map information. The legend includes only those icons for the default map view.

SITE NAME: Miki Basin - 200 Acre Industrial Site
 ADDRESS: Miki Road & Kaunalapau Highway
 Lanai City HI 96763
 LAT/LONG: 20.7904 / 156.9375

CLIENT: TRC
 CONTACT: Ron Landolt
 INQUIRY #: 3875991.2s
 DATE: March 10, 2014 5:26 pm

Copyright © 2014 EDR, Inc. © 2010 Tele Atlas Rel. 07/2009.

DETAIL MAP - 3875991.2s

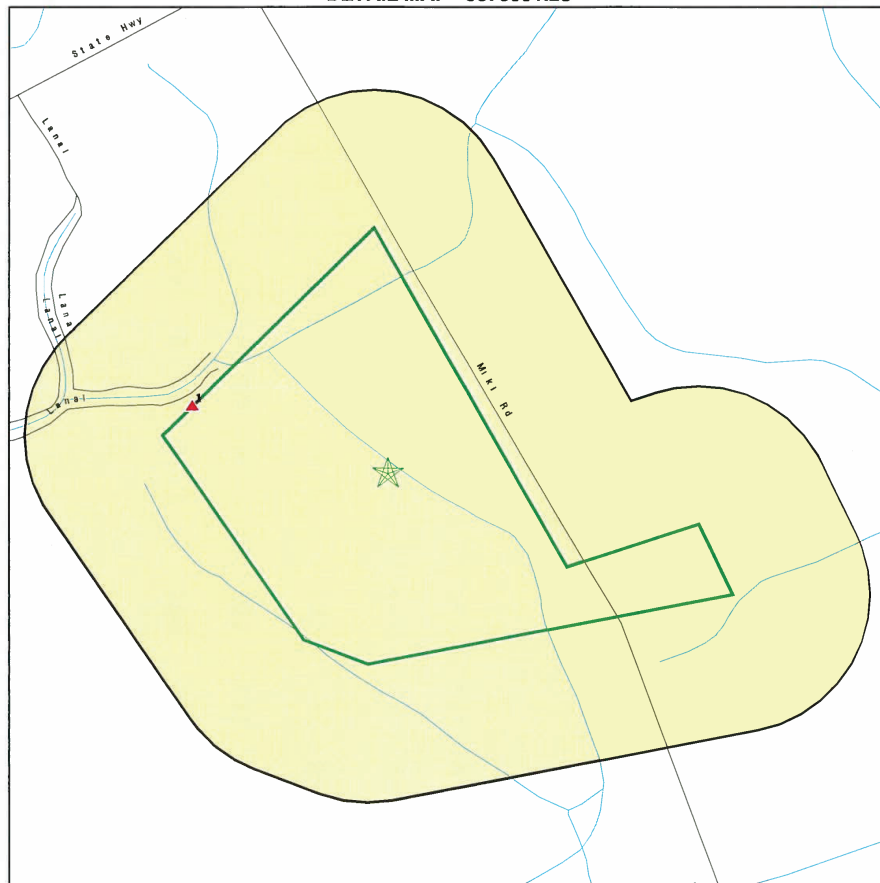

- Target Property
- Sites at elevations higher than or equal to the target property
- Sites at elevations lower than the target property
- Manufactured Gas Plants
- Sensitive Receptors
- National Priority List Sites
- Dept. Defense Sites

- Indian Reservations BIA
- Oil & Gas pipelines from USGS

This report includes Interactive Map Layers to display and/or hide map information. The legend includes only those icons for the default map view.

SITE NAME: Miki Basin - 200 Acre Industrial Site
ADDRESS: Miki Road & Kaunapapa Highway
Lanai City HI 96753
LAT/LONG: 20.7904 / 156.9375

CLIENT: TRC
CONTACT: Ron Landolt
INQUIRY #: 3875991.2s
DATE: March 10, 2014 5:26 pm

Copyright © 2014 EDR, Inc. © 2010 Tels Allier Rel. 07/2008

MAP FINDINGS SUMMARY

Database	Search Distance (Miles)	Target Property	< 1/8	1/8 - 1/4	1/4 - 1/2	1/2 - 1	> 1	Total Plotted
STANDARD ENVIRONMENTAL RECORDS								
Federal NPL site list								
NPL	1.000		0	0	0	0	NR	0
Proposed NPL	1.000		0	0	0	0	NR	0
NPL LIENS	TP		NR	NR	NR	NR	NR	0
Federal Delisted NPL site list								
Delisted NPL	1.000		0	0	0	0	NR	0
Federal CERCLIS list								
CERCLIS	0.500		0	0	0	NR	NR	0
FEDERAL FACILITY	0.500		0	0	0	NR	NR	0
Federal CERCLIS NFRAP site List								
CERC-NFRAP	0.500		0	0	0	NR	NR	0
Federal RCRA CORRACTS facilities list								
CORRACTS	1.000		0	0	0	0	NR	0
Federal RCRA non-CORRACTS TSD facilities list								
RCRA-TSDF	0.500		0	0	0	NR	NR	0
Federal RCRA generators list								
RCRA-LQG	0.250		0	0	NR	NR	NR	0
RCRA-SQG	0.250		0	0	NR	NR	NR	0
RCRA-CESQG	0.250		0	0	NR	NR	NR	0
Federal institutional controls / engineering controls registries								
US ENG CONTROLS	0.500		0	0	0	NR	NR	0
US INST CONTROL	0.500		0	0	0	NR	NR	0
LUCIS	0.500		0	0	0	NR	NR	0
Federal ERNS list								
ERNS	TP		NR	NR	NR	NR	NR	0
State- and tribal - equivalent CERCLIS								
SHWS	1.000		0	0	0	0	NR	0
State and tribal landfill and/or solid waste disposal site lists								
SWF/LF	0.500		0	0	0	NR	NR	0
State and tribal leaking storage tank lists								
LUST	0.500		0	0	0	NR	NR	0
INDIAN LUST	0.500		0	0	0	NR	NR	0
State and tribal registered storage tank lists								
UST	0.250		1	0	NR	NR	NR	1

MAP FINDINGS SUMMARY

Database	Search Distance (Miles)	Target Property	< 1/8	1/8 - 1/4	1/4 - 1/2	1/2 - 1	> 1	Total Plotted
INDIAN UST	0.250		0	0	NR	NR	NR	0
FEMA UST	0.250		0	0	NR	NR	NR	0
<i>State and tribal institutional control / engineering control registries</i>								
ENG CONTROLS	0.500		0	0	0	NR	NR	0
INST CONTROL	0.500		0	0	0	NR	NR	0
<i>State and tribal voluntary cleanup sites</i>								
INDIAN VCP	0.500		0	0	0	NR	NR	0
VCP	0.500		0	0	0	NR	NR	0
<i>State and tribal Brownfields sites</i>								
BROWNFIELDS	0.500		0	0	0	NR	NR	0
<u>ADDITIONAL ENVIRONMENTAL RECORDS</u>								
<i>Local Brownfield lists</i>								
US BROWNFIELDS	0.500		0	0	0	NR	NR	0
<i>Local Lists of Landfill / Solid Waste Disposal Sites</i>								
DEBRIS REGION 9	0.500		0	0	0	NR	NR	0
ODI	0.500		0	0	0	NR	NR	0
INDIAN ODI	0.500		0	0	0	NR	NR	0
<i>Local Lists of Hazardous waste / Contaminated Sites</i>								
US CDL	TP		NR	NR	NR	NR	NR	0
CDL	TP		NR	NR	NR	NR	NR	0
US HIST CDL	TP		NR	NR	NR	NR	NR	0
<i>Local Land Records</i>								
LIENS 2	TP		NR	NR	NR	NR	NR	0
<i>Records of Emergency Release Reports</i>								
HMIRS	TP		NR	NR	NR	NR	NR	0
SPILLS	TP		NR	NR	NR	NR	NR	0
SPILLS 90	TP		NR	NR	NR	NR	NR	0
<i>Other Ascertainable Records</i>								
RCRA NonGen / NLR	0.250		0	0	NR	NR	NR	0
DOT OPS	TP		NR	NR	NR	NR	NR	0
DOD	1,000		0	0	0	0	NR	0
FUDS	1,000		0	0	0	0	NR	0
CONSENT	1,000		0	0	0	0	NR	0
ROD	1,000		0	0	0	0	NR	0
UMTRA	0.500		0	0	0	NR	NR	0
US MINES	0.250		0	0	NR	NR	NR	0
TRIS	TP		NR	NR	NR	NR	NR	0

MAP FINDINGS SUMMARY

Database	Search Distance (Miles)	Target Property	< 1/8	1/8 - 1/4	1/4 - 1/2	1/2 - 1	> 1	Total Plotted
TSCA	TP		NR	NR	NR	NR	NR	0
FTTS	TP		NR	NR	NR	NR	NR	0
HIST FTTS	TP		NR	NR	NR	NR	NR	0
SSTS	TP		NR	NR	NR	NR	NR	0
ICIS	TP		NR	NR	NR	NR	NR	0
PADS	TP		NR	NR	NR	NR	NR	0
MLTS	TP		NR	NR	NR	NR	NR	0
RADINFO	TP		NR	NR	NR	NR	NR	0
FINDS	TP		NR	NR	NR	NR	NR	0
RAATS	TP		NR	NR	NR	NR	NR	0
RMP	TP		NR	NR	NR	NR	NR	0
UIC	TP		NR	NR	NR	NR	NR	0
DRYCLEANERS	0.250		0	0	NR	NR	NR	0
AIRS	TP		NR	NR	NR	NR	NR	0
INDIAN RESERV	1,000		0	0	0	0	NR	0
SCRD DRYCLEANERS	0.500		0	0	0	NR	NR	0
LEAD SMELTERS	TP		NR	NR	NR	NR	NR	0
2020 COR ACTION	0.250		0	0	NR	NR	NR	0
EPA WATCH LIST	TP		NR	NR	NR	NR	NR	0
COAL ASH DOE	TP		NR	NR	NR	NR	NR	0
PCB TRANSFORMER	TP		NR	NR	NR	NR	NR	0
COAL ASH EPA	0.500		0	0	0	NR	NR	0
US FIN ASSUR	TP		NR	NR	NR	NR	NR	0
US AIRS	TP		NR	NR	NR	NR	NR	0
PRP	TP		NR	NR	NR	NR	NR	0
Financial Assurance	TP		NR	NR	NR	NR	NR	0
<u>EDR HIGH RISK HISTORICAL RECORDS</u>								
<i>EDR Exclusive Records</i>								
EDR MGP	1,000		0	0	0	0	NR	0
EDR US Hist Auto Stat	0.250		0	0	NR	NR	NR	0
EDR US Hist Cleaners	0.250		0	0	NR	NR	NR	0
<u>EDR RECOVERED GOVERNMENT ARCHIVES</u>								
<i>Exclusive Recovered Govt. Archives</i>								
RGA LF	TP		NR	NR	NR	NR	NR	0
RGA LUST	TP		NR	NR	NR	NR	NR	0
RGA HWS	TP		NR	NR	NR	NR	NR	0

NOTES:

TP = Target Property

NR = Not Requested at this Search Distance

Sites may be listed in more than one database

Map ID
Direction
Distance
Elevation

MAP FINDINGS

Site

Database(s)

EDR ID Number
EPA ID Number

1
WNW
< 1/8
0.001 mi.
7 ft.

LANAI AIRPORT (PMID LNY620123)
LANAI AIRPORT
LANAI CITY, HI 96763

UST
U003222164
N/A

Relative:
Higher

Actual:
1310 ft.

UST:
Facility ID: 9-402985
Owner: STATE DOT - AIRPORTS DIVISION
Owner Address: Not reported
Ownder City,St,Zip: Lanai City, 96763 96763

Tank ID: R-1
Date Installed: Not reported
Tank Status: Permanently Out of Use
Date Closed: 06/29/1994
Tank Capacity: 350
Substance: Diesel

City		EDR ID	Site Name	Site Address	Zip	Database(s)
ORPHAN SUMMARY						
LANAI	1003875123	LANAI LDFL	LANAI	LANAI	96763	CERC-NFRAP
LANAI CITY	1015932482	FAA - LANAI	P.O. BOX 722	P.O. BOX 722	96763	CERC-NFRAP
LANAI CITY	1007447440	TRANSPORTATION SECURITY ADMINISTRA	KAUINALAPAU HWY	KAUINALAPAU HWY	96763	RCRA-CESQG
LANAI CITY	1006815457	LANAI LANDFILL	KAUINALAPAU HWY	KAUINALAPAU HWY	96763	SHWS, RGA, HWS
LANAI CITY	1000146613	KAUINALAPAU PETROLEUM TERMINAL	MANELE BAY FACILITY	MANELE BAY FACILITY	96763	RCRA-CESQG, FINDS
LANAI CITY	1016079559	CASTLE & COOKE - MANELE BAY	1001 N MIKI RD	1001 N MIKI RD	96763	US AIRS
LANAI CITY	1008382103	MAUI ELECTRIC CO LTD MIKI BASIN PO	MIKI ROAD	MIKI ROAD	96763	HAZNET
LANAI CITY	S113183480	MIKI BASIN GENERATING STATION	1001 N MIKI RD	1001 N MIKI RD	96763	FINDS
LANAI CITY	S107769303	MIKI BASIN PAVING & FENCING	1001 N MIKI RD	1001 N MIKI RD	96763	RCRA-CESQG, PAOS
LANAI CITY	1010166528	MIKI BASIN GENERATING STATION	PALAWAI ST	PALAWAI ST	96763	FINDS, US AIRS
LANAI CITY	1007092130	DOLE PLANTATION (PALAWAI & 5319 BA	PALAWAI & 5319 BASINS	PALAWAI & 5319 BASINS	96763	SHWS, RGA, HWS
LANAI CITY	1001024214	DOLE PLANTATION	BOUNDED BY FIELD NO. 5429, 54	BOUNDED BY FIELD NO. 5429, 54	96763	RCRA-TSDF, CERC-NFRAP, RCRA
LANAI CITY	1006820213	DOLE PLANTATION	NORTHWEST OF FIELD # 5319	NORTHWEST OF FIELD # 5319	96763	NotGen / NLR, FINDS
LANAI CITY	1000198027	LANAI DUMP SITE PALAWI BASIN	SOUTH OFF MIKI ROAD	SOUTH OFF MIKI ROAD	96763	CERC-NFRAP
LANAI ISLAND	1003875697	LANAI DRUM SITE NO. 3	SOUTHEAST OF FIELD #5311	SOUTHEAST OF FIELD #5311	96763	CERC-NFRAP
LANAI ISLAND	1003875695	LANAI DRUM SITE NO. 2	SOUTHWEST OF FIELD #5310	SOUTHWEST OF FIELD #5310	96763	CERC-NFRAP
LANAI ISLAND	1003875694	LANAI DUMP SITE	SEE BELOW	SEE BELOW	96763	CERC-NFRAP
LANAI ISLAND	1003875696	LANAI DRUM SITE NO. 1			96763	FINDS
LANAI ISLAND	1003875693	LANAI DRUM SITE NO. 1				
MAUI COUNTY	1015780556	MORRIS, CHARLES AND ROSS, NORMAN -				

Count: 20 records.

GOVERNMENT RECORDS SEARCHED / DATA CURRENCY TRACKING

To maintain currency of the following federal and state databases, EDR contacts the appropriate governmental agency on a monthly or quarterly basis, as required.

Number of Days to Update: Provides confirmation that EDR is reporting records that have been updated within 90 days from the date the government agency made the information available to the public.

STANDARD ENVIRONMENTAL RECORDS

Federal NPL site list

NPL: National Priority List

National Priorities List (Superfund). The NPL is a subset of CERCLIS and identifies over 1,200 sites for priority cleanup under the Superfund Program. NPL sites may encompass relatively large areas. As such, EDR provides polygon coverage for over 1,000 NPL site boundaries produced by EPA's Environmental Photographic Interpretation Center (EPIC) and regional EPA offices.

Date of Government Version: 10/25/2013	Source: EPA
Date Data Arrived at EDR: 11/11/2013	Telephone: N/A
Date Made Active in Reports: 01/28/2014	Last EDR Contact: 01/21/2014
Number of Days to Update: 78	Next Scheduled EDR Contact: 04/21/2014
	Data Release Frequency: Quarterly

NPL Site Boundaries

Sources:

EPA's Environmental Photographic Interpretation Center (EPIC)
Telephone: 202-564-7333

EPA Region 1 Telephone 617-918-1143	EPA Region 6 Telephone: 214-655-6659
--	---

EPA Region 3 Telephone 215-814-5418	EPA Region 7 Telephone: 913-551-7247
--	---

EPA Region 4 Telephone 404-562-8033	EPA Region 8 Telephone: 303-312-6774
--	---

EPA Region 5 Telephone 312-886-6686	EPA Region 9 Telephone: 415-947-4246
--	---

EPA Region 10 Telephone 206-553-8665	
---	--

Proposed NPL: Proposed National Priority List Sites

A site that has been proposed for listing on the National Priorities List through the issuance of a proposed rule in the Federal Register. EPA then accepts public comments on the site, responds to the comments, and places on the NPL those sites that continue to meet the requirements for listing.

Date of Government Version: 10/25/2013	Source: EPA
Date Data Arrived at EDR: 11/11/2013	Telephone: N/A
Date Made Active in Reports: 01/28/2014	Last EDR Contact: 01/09/2014
Number of Days to Update: 78	Next Scheduled EDR Contact: 04/21/2014
	Data Release Frequency: Quarterly

NPL LIENS: Federal Superfund Liens

Federal Superfund Liens. Under the authority granted the USEPA by CERCLA of 1980, the USEPA has the authority to file liens against real property in order to recover remedial action expenditures or when the property owner received notification of potential liability. USEPA compiles a listing of filed notices of Superfund Liens.

Date of Government Version: 10/15/1991	Source: EPA
Date Data Arrived at EDR: 02/02/1994	Telephone: 202-564-4267
Date Made Active in Reports: 03/30/1994	Last EDR Contact: 08/15/2011
Number of Days to Update: 56	Next Scheduled EDR Contact: 11/28/2011
	Data Release Frequency: No Update Planned

GOVERNMENT RECORDS SEARCHED / DATA CURRENCY TRACKING

Federal Delisted NPL site list

DELISTED NPL: National Priority List Deletions

The National Oil and Hazardous Substances Pollution Contingency Plan (NCP) establishes the criteria that the EPA uses to delete sites from the NPL. In accordance with 40 CFR 300.425(e), sites may be deleted from the NPL where no further response is appropriate.

Date of Government Version: 10/25/2013	Source: EPA
Date Data Arrived at EDR: 11/11/2013	Telephone: N/A
Date Made Active in Reports: 01/28/2014	Last EDR Contact: 01/09/2014
Number of Days to Update: 78	Next Scheduled EDR Contact: 04/21/2014
	Data Release Frequency: Quarterly

Federal CERCLIS list

CERCLIS: Comprehensive Environmental Response, Compensation, and Liability Information System

CERCLIS contains data on potentially hazardous waste sites that have been reported to the USEPA by states, municipalities, private companies and private persons, pursuant to Section 103 of the Comprehensive Environmental Response, Compensation, and Liability Act (CERCLA). CERCLIS contains sites which are either proposed to or on the National Priorities List (NPL) and sites which are in the screening and assessment phase for possible inclusion on the NPL.

Date of Government Version: 10/25/2013	Source: EPA
Date Data Arrived at EDR: 11/11/2013	Telephone: 703-412-9810
Date Made Active in Reports: 02/13/2014	Last EDR Contact: 02/28/2014
Number of Days to Update: 94	Next Scheduled EDR Contact: 06/09/2014
	Data Release Frequency: Quarterly

FEDERAL FACILITY: Federal Facility Site Information listing

A listing of National Priority List (NPL) and Base Realignment and Closure (BRAC) sites found in the Comprehensive Environmental Response, Compensation and Liability Information System (CERCLIS) Database where EPA Federal Facilities Restoration and Reuse Office is involved in cleanup activities.

Date of Government Version: 05/31/2013	Source: Environmental Protection Agency
Date Data Arrived at EDR: 07/08/2013	Telephone: 703-603-8704
Date Made Active in Reports: 12/06/2013	Last EDR Contact: 01/10/2014
Number of Days to Update: 151	Next Scheduled EDR Contact: 04/21/2014
	Data Release Frequency: Varies

Federal CERCLIS NFRAP site List

CERCLIS-NFRAP: CERCLIS No Further Remedial Action Planned

Archived sites are sites that have been removed and archived from the inventory of CERCLIS sites. Archived status indicates that, to the best of EPA's knowledge, assessment at a site has been completed and that EPA has determined no further steps will be taken to list this site on the National Priorities List (NPL), unless information indicates this decision was not appropriate or other considerations require a recommendation for listing at a later time. This decision does not necessarily mean that there is no hazard associated with a given site; it only means that, based upon available information, the location is not judged to be a potential NPL site.

Date of Government Version: 10/25/2013	Source: EPA
Date Data Arrived at EDR: 11/11/2013	Telephone: 703-412-9810
Date Made Active in Reports: 02/13/2014	Last EDR Contact: 02/28/2014
Number of Days to Update: 94	Next Scheduled EDR Contact: 06/09/2014
	Data Release Frequency: Quarterly

Federal RCRA CORRACTS facilities list

CORRACTS: Corrective Action Report

CORRACTS identifies hazardous waste handlers with RCRA corrective action activity.

GOVERNMENT RECORDS SEARCHED / DATA CURRENCY TRACKING

Date of Government Version: 09/10/2013
 Date Data Arrived at EDR: 10/02/2013
 Date Made Active in Reports: 12/16/2013
 Number of Days to Update: 75

Source: EPA
 Telephone: 800-424-9346
 Last EDR Contact: 01/02/2014
 Next Scheduled EDR Contact: 04/14/2014
 Data Release Frequency: Quarterly

Federal RCRA non-CORRACTS TSD facilities list

RCRA-TSDF: RCRA - Treatment, Storage and Disposal
 RCRAInfo is EPA's comprehensive information system, providing access to data supporting the Resource Conservation and Recovery Act (RCRA) of 1976 and the Hazardous and Solid Waste Amendments (HSWA) of 1984. The database includes selective information on sites which generate, transport, store, treat and/or dispose of hazardous waste as defined by the Resource Conservation and Recovery Act (RCRA). Transporters are individuals or entities that move hazardous waste from the generator offsite to a facility that can recycle, treat, store, or dispose of the waste. TSDFs treat, store, or dispose of the waste.

Date of Government Version: 09/10/2013
 Date Data Arrived at EDR: 10/02/2013
 Date Made Active in Reports: 12/16/2013
 Number of Days to Update: 75

Source: Environmental Protection Agency
 Telephone: (415) 495-8895
 Last EDR Contact: 01/02/2014
 Next Scheduled EDR Contact: 04/14/2014
 Data Release Frequency: Quarterly

Federal RCRA generators list

RCRA-LQG: RCRA - Large Quantity Generators
 RCRAInfo is EPA's comprehensive information system, providing access to data supporting the Resource Conservation and Recovery Act (RCRA) of 1976 and the Hazardous and Solid Waste Amendments (HSWA) of 1984. The database includes selective information on sites which generate, transport, store, treat and/or dispose of hazardous waste as defined by the Resource Conservation and Recovery Act (RCRA). Large quantity generators (LQGs) generate over 1,000 kilograms (kg) of hazardous waste, or over 1 kg of acutely hazardous waste per month.

Date of Government Version: 09/10/2013
 Date Data Arrived at EDR: 10/02/2013
 Date Made Active in Reports: 12/16/2013
 Number of Days to Update: 75

Source: Environmental Protection Agency
 Telephone: (415) 495-8895
 Last EDR Contact: 01/02/2014
 Next Scheduled EDR Contact: 04/14/2014
 Data Release Frequency: Quarterly

RCRA-SQG: RCRA - Small Quantity Generators

RCRAInfo is EPA's comprehensive information system, providing access to data supporting the Resource Conservation and Recovery Act (RCRA) of 1976 and the Hazardous and Solid Waste Amendments (HSWA) of 1984. The database includes selective information on sites which generate, transport, store, treat and/or dispose of hazardous waste as defined by the Resource Conservation and Recovery Act (RCRA). Small quantity generators (SQGs) generate between 100 kg and 1,000 kg of hazardous waste per month.

Date of Government Version: 09/10/2013
 Date Data Arrived at EDR: 10/02/2013
 Date Made Active in Reports: 12/16/2013
 Number of Days to Update: 75

Source: Environmental Protection Agency
 Telephone: (415) 495-8895
 Last EDR Contact: 01/02/2014
 Next Scheduled EDR Contact: 04/14/2014
 Data Release Frequency: Quarterly

RCRA-CESQG: RCRA - Conditionally Exempt Small Quantity Generators

RCRAInfo is EPA's comprehensive information system, providing access to data supporting the Resource Conservation and Recovery Act (RCRA) of 1976 and the Hazardous and Solid Waste Amendments (HSWA) of 1984. The database includes selective information on sites which generate, transport, store, treat and/or dispose of hazardous waste as defined by the Resource Conservation and Recovery Act (RCRA). Conditionally exempt small quantity generators (CESQGs) generate less than 100 kg of hazardous waste, or less than 1 kg of acutely hazardous waste per month.

Date of Government Version: 09/10/2013
 Date Data Arrived at EDR: 10/02/2013
 Date Made Active in Reports: 12/16/2013
 Number of Days to Update: 75

Source: Environmental Protection Agency
 Telephone: (415) 495-8895
 Last EDR Contact: 01/02/2014
 Next Scheduled EDR Contact: 04/14/2014
 Data Release Frequency: Varies

GOVERNMENT RECORDS SEARCHED / DATA CURRENCY TRACKING

Federal institutional controls / engineering controls registries

US ENG CONTROLS: Engineering Controls Sites List

A listing of sites with engineering controls in place. Engineering controls include various forms of caps, building foundations, liners, and treatment methods to create pathway elimination for regulated substances to enter environmental media or effect human health.

Date of Government Version: 12/17/2013
 Date Data Arrived at EDR: 01/14/2014
 Date Made Active in Reports: 01/28/2014
 Number of Days to Update: 14

Source: Environmental Protection Agency
 Telephone: 703-603-0695
 Last EDR Contact: 12/09/2013
 Next Scheduled EDR Contact: 03/24/2014
 Data Release Frequency: Varies

US INST CONTROL: Sites with Institutional Controls

A listing of sites with institutional controls in place. Institutional controls include administrative measures, such as groundwater use restrictions, construction restrictions, property use restrictions, and post remediation care requirements intended to prevent exposure to contaminants remaining on site. Deed restrictions are generally required as part of the institutional controls.

Date of Government Version: 12/17/2013
 Date Data Arrived at EDR: 01/14/2014
 Date Made Active in Reports: 01/28/2014
 Number of Days to Update: 14

Source: Environmental Protection Agency
 Telephone: 703-603-0695
 Last EDR Contact: 12/09/2013
 Next Scheduled EDR Contact: 03/24/2014
 Data Release Frequency: Varies

LUCIS: Land Use Control Information System

LUCIS contains records of land use control information pertaining to the former Navy Base Realignment and Closure properties.

Date of Government Version: 11/20/2013
 Date Data Arrived at EDR: 11/21/2013
 Date Made Active in Reports: 02/24/2014
 Number of Days to Update: 95

Source: Department of the Navy
 Telephone: 843-820-7326
 Last EDR Contact: 02/14/2014
 Next Scheduled EDR Contact: 06/02/2014
 Data Release Frequency: Varies

Federal ERNS list

ERNS: Emergency Response Notification System

Emergency Response Notification System. ERNS records and stores information on reported releases of oil and hazardous substances.

Date of Government Version: 09/30/2013
 Date Data Arrived at EDR: 10/01/2013
 Date Made Active in Reports: 12/06/2013
 Number of Days to Update: 66

Source: National Response Center, United States Coast Guard
 Telephone: 202-267-2180
 Last EDR Contact: 02/07/2014
 Next Scheduled EDR Contact: 04/14/2014
 Data Release Frequency: Annually

State- and tribal - equivalent CERCLIS

SHWS: Sites List

Facilities, sites or areas in which the Office of Hazard Evaluation and Emergency Response has an interest, has investigated or may investigate under HRS 128D (includes CERCLIS sites).

Date of Government Version: 01/04/2014
 Date Data Arrived at EDR: 02/26/2014
 Date Made Active in Reports: 03/07/2014
 Number of Days to Update: 9

Source: Department of Health
 Telephone: 808-586-4249
 Last EDR Contact: 02/26/2014
 Next Scheduled EDR Contact: 06/09/2014
 Data Release Frequency: Semi-Annually

State and tribal landfill and/or solid waste disposal site lists

GOVERNMENT RECORDS SEARCHED / DATA CURRENCY TRACKING

SWF/LF: Permitted Landfills in the State of Hawaii

Solid Waste Facilities/Landfill Sites. SWF/LF type records typically contain an inventory of solid waste disposal facilities or landfills in a particular state. Depending on the state, these may be active or inactive facilities or open dumps that failed to meet RCRA Subtitle D Section 4004 criteria for solid waste landfills or disposal sites.

Date of Government Version: 09/17/2012	Source: Department of Health
Date Data Arrived at EDR: 04/03/2013	Telephone: 808-586-4245
Date Made Active in Reports: 05/10/2013	Last EDR Contact: 12/30/2013
Number of Days to Update: 37	Next Scheduled EDR Contact: 04/14/2014
	Data Release Frequency: Varies

State and tribal leaking storage tank lists

LUST: Leaking Underground Storage Tank Database

Leaking Underground Storage Tank Incident Reports. LUST records contain an inventory of reported leaking underground storage tank incidents. Not all states maintain these records, and the information stored varies by state.

Date of Government Version: 12/04/2013	Source: Department of Health
Date Data Arrived at EDR: 12/05/2013	Telephone: 808-586-4228
Date Made Active in Reports: 12/10/2013	Last EDR Contact: 03/03/2014
Number of Days to Update: 5	Next Scheduled EDR Contact: 06/16/2014
	Data Release Frequency: Semi-Annually

INDIAN LUST R10: Leaking Underground Storage Tanks on Indian Land

LUSTs on Indian land in Alaska, Idaho, Oregon and Washington.

Date of Government Version: 11/06/2013	Source: EPA Region 10
Date Data Arrived at EDR: 11/07/2013	Telephone: 206-553-2857
Date Made Active in Reports: 12/06/2013	Last EDR Contact: 01/27/2014
Number of Days to Update: 29	Next Scheduled EDR Contact: 05/12/2014
	Data Release Frequency: Quarterly

INDIAN LUST R9: Leaking Underground Storage Tanks on Indian Land

LUSTs on Indian land in Arizona, California, New Mexico and Nevada

Date of Government Version: 03/01/2013	Source: Environmental Protection Agency
Date Data Arrived at EDR: 03/01/2013	Telephone: 415-972-3372
Date Made Active in Reports: 04/12/2013	Last EDR Contact: 01/27/2014
Number of Days to Update: 42	Next Scheduled EDR Contact: 05/12/2014
	Data Release Frequency: Quarterly

INDIAN LUST R7: Leaking Underground Storage Tanks on Indian Land

LUSTs on Indian land in Iowa, Kansas, and Nebraska

Date of Government Version: 08/27/2013	Source: EPA Region 7
Date Data Arrived at EDR: 08/27/2013	Telephone: 913-551-7003
Date Made Active in Reports: 11/01/2013	Last EDR Contact: 01/27/2014
Number of Days to Update: 66	Next Scheduled EDR Contact: 05/12/2014
	Data Release Frequency: Varies

INDIAN LUST R6: Leaking Underground Storage Tanks on Indian Land

LUSTs on Indian land in New Mexico and Oklahoma.

Date of Government Version: 09/12/2011	Source: EPA Region 6
Date Data Arrived at EDR: 09/13/2011	Telephone: 214-665-6597
Date Made Active in Reports: 11/11/2011	Last EDR Contact: 02/21/2014
Number of Days to Update: 59	Next Scheduled EDR Contact: 05/12/2014
	Data Release Frequency: Varies

GOVERNMENT RECORDS SEARCHED / DATA CURRENCY TRACKING

INDIAN LUST R4: Leaking Underground Storage Tanks on Indian Land

LUSTs on Indian land in Florida, Mississippi and North Carolina.

Date of Government Version: 11/21/2013	Source: EPA Region 4
Date Data Arrived at EDR: 11/26/2013	Telephone: 404-562-8677
Date Made Active in Reports: 02/24/2014	Last EDR Contact: 01/27/2014
Number of Days to Update: 90	Next Scheduled EDR Contact: 05/12/2014
	Data Release Frequency: Semi-Annually

INDIAN LUST R1: Leaking Underground Storage Tanks on Indian Land

A listing of leaking underground storage tank locations on Indian Land.

Date of Government Version: 02/01/2013	Source: EPA Region 1
Date Data Arrived at EDR: 05/01/2013	Telephone: 617-918-1313
Date Made Active in Reports: 11/01/2013	Last EDR Contact: 01/30/2014
Number of Days to Update: 184	Next Scheduled EDR Contact: 05/12/2014
	Data Release Frequency: Varies

INDIAN LUST R5: Leaking Underground Storage Tanks on Indian Land

Leaking underground storage tanks located on Indian Land in Michigan, Minnesota and Wisconsin.

Date of Government Version: 02/13/2014	Source: EPA, Region 5
Date Data Arrived at EDR: 02/14/2014	Telephone: 312-886-7439
Date Made Active in Reports: 02/24/2014	Last EDR Contact: 01/27/2014
Number of Days to Update: 10	Next Scheduled EDR Contact: 05/12/2014
	Data Release Frequency: Varies

INDIAN LUST R8: Leaking Underground Storage Tanks on Indian Land

LUSTs on Indian land in Colorado, Montana, North Dakota, South Dakota, Utah and Wyoming.

Date of Government Version: 08/27/2012	Source: EPA Region 8
Date Data Arrived at EDR: 08/28/2012	Telephone: 303-312-6271
Date Made Active in Reports: 10/16/2012	Last EDR Contact: 01/27/2014
Number of Days to Update: 49	Next Scheduled EDR Contact: 05/12/2014
	Data Release Frequency: Quarterly

State and tribal registered storage tank lists

UST: Underground Storage Tank Database

Registered Underground Storage Tanks. UST's are regulated under Subtitle I of the Resource Conservation and Recovery Act (RCRA) and must be registered with the state department responsible for administering the UST program. Available information varies by state program.

Date of Government Version: 12/04/2013	Source: Department of Health
Date Data Arrived at EDR: 12/05/2013	Telephone: 808-586-4228
Date Made Active in Reports: 12/10/2013	Last EDR Contact: 03/03/2014
Number of Days to Update: 5	Next Scheduled EDR Contact: 06/16/2014
	Data Release Frequency: Semi-Annually

INDIAN UST R1: Underground Storage Tanks on Indian Land

The Indian Underground Storage Tank (UST) database provides information about underground storage tanks on Indian land in EPA Region 1 (Connecticut, Maine, Massachusetts, New Hampshire, Rhode Island, Vermont and ten Tribal Nations).

Date of Government Version: 02/01/2013	Source: EPA, Region 1
Date Data Arrived at EDR: 05/01/2013	Telephone: 617-918-1313
Date Made Active in Reports: 01/27/2014	Last EDR Contact: 01/30/2014
Number of Days to Update: 271	Next Scheduled EDR Contact: 05/12/2014
	Data Release Frequency: Varies

GOVERNMENT RECORDS SEARCHED / DATA CURRENCY TRACKING

INDIAN UST R10: Underground Storage Tanks on Indian Land

The Indian Underground Storage Tank (UST) database provides information about underground storage tanks on Indian land in EPA Region 10 (Alaska, Idaho, Oregon, Washington, and Tribal Nations).

Date of Government Version: 02/05/2013	Source: EPA Region 10
Date Data Arrived at EDR: 02/06/2013	Telephone: 206-553-2857
Date Made Active in Reports: 04/12/2013	Last EDR Contact: 01/27/2014
Number of Days to Update: 65	Next Scheduled EDR Contact: 05/12/2014
	Data Release Frequency: Quarterly

INDIAN UST R9: Underground Storage Tanks on Indian Land

The Indian Underground Storage Tank (UST) database provides information about underground storage tanks on Indian land in EPA Region 9 (Arizona, California, Hawaii, Nevada, the Pacific Islands, and Tribal Nations).

Date of Government Version: 07/29/2013	Source: EPA Region 9
Date Data Arrived at EDR: 07/30/2013	Telephone: 415-972-3368
Date Made Active in Reports: 12/06/2013	Last EDR Contact: 01/27/2014
Number of Days to Update: 129	Next Scheduled EDR Contact: 05/12/2014
	Data Release Frequency: Quarterly

INDIAN UST R8: Underground Storage Tanks on Indian Land

The Indian Underground Storage Tank (UST) database provides information about underground storage tanks on Indian land in EPA Region 8 (Colorado, Montana, North Dakota, South Dakota, Utah, Wyoming and 27 Tribal Nations).

Date of Government Version: 07/29/2013	Source: EPA Region 8
Date Data Arrived at EDR: 08/01/2013	Telephone: 303-312-6137
Date Made Active in Reports: 11/01/2013	Last EDR Contact: 01/27/2014
Number of Days to Update: 92	Next Scheduled EDR Contact: 05/12/2014
	Data Release Frequency: Quarterly

INDIAN UST R7: Underground Storage Tanks on Indian Land

The Indian Underground Storage Tank (UST) database provides information about underground storage tanks on Indian land in EPA Region 7 (Iowa, Kansas, Missouri, Nebraska, and 9 Tribal Nations).

Date of Government Version: 12/31/2012	Source: EPA Region 7
Date Data Arrived at EDR: 02/28/2013	Telephone: 913-551-7003
Date Made Active in Reports: 04/12/2013	Last EDR Contact: 01/27/2014
Number of Days to Update: 43	Next Scheduled EDR Contact: 05/12/2014
	Data Release Frequency: Varies

INDIAN UST R6: Underground Storage Tanks on Indian Land

The Indian Underground Storage Tank (UST) database provides information about underground storage tanks on Indian land in EPA Region 6 (Louisiana, Arkansas, Oklahoma, New Mexico, Texas and 65 Tribes).

Date of Government Version: 05/10/2011	Source: EPA Region 6
Date Data Arrived at EDR: 05/11/2011	Telephone: 214-865-7591
Date Made Active in Reports: 06/14/2011	Last EDR Contact: 01/27/2014
Number of Days to Update: 34	Next Scheduled EDR Contact: 05/12/2014
	Data Release Frequency: Semi-Annually

INDIAN UST R5: Underground Storage Tanks on Indian Land

The Indian Underground Storage Tank (UST) database provides information about underground storage tanks on Indian land in EPA Region 5 (Michigan, Minnesota and Wisconsin and Tribal Nations).

Date of Government Version: 02/13/2014	Source: EPA Region 5
Date Data Arrived at EDR: 02/14/2014	Telephone: 312-886-6136
Date Made Active in Reports: 02/24/2014	Last EDR Contact: 01/27/2014
Number of Days to Update: 10	Next Scheduled EDR Contact: 05/12/2014
	Data Release Frequency: Varies

GOVERNMENT RECORDS SEARCHED / DATA CURRENCY TRACKING

INDIAN UST R4: Underground Storage Tanks on Indian Land

The Indian Underground Storage Tank (UST) database provides information about underground storage tanks on Indian land in EPA Region 4 (Alabama, Florida, Georgia, Kentucky, Mississippi, North Carolina, South Carolina, Tennessee and Tribal Nations).

Date of Government Version: 11/21/2013	Source: EPA Region 4
Date Data Arrived at EDR: 11/26/2013	Telephone: 404-562-9424
Date Made Active in Reports: 02/24/2014	Last EDR Contact: 01/27/2014
Number of Days to Update: 90	Next Scheduled EDR Contact: 05/12/2014
	Data Release Frequency: Semi-Annually

FEMA UST: Underground Storage Tank Listing

A listing of all FEMA owned underground storage tanks.

Date of Government Version: 01/01/2010	Source: FEMA
Date Data Arrived at EDR: 02/16/2010	Telephone: 202-646-5797
Date Made Active in Reports: 04/12/2010	Last EDR Contact: 01/13/2014
Number of Days to Update: 55	Next Scheduled EDR Contact: 04/28/2014
	Data Release Frequency: Varies

State and tribal institutional control / engineering control registries

ENG CONTROLS: Engineering Control Sites

A listing of sites with engineering controls in place.

Date of Government Version: 01/04/2014	Source: Department of Health
Date Data Arrived at EDR: 02/26/2014	Telephone: 404-586-4249
Date Made Active in Reports: 03/07/2014	Last EDR Contact: 02/26/2014
Number of Days to Update: 9	Next Scheduled EDR Contact: 06/09/2014
	Data Release Frequency: Varies

INST CONTROL: Sites with Institutional Controls

Voluntary Remediation Program and Brownfields sites with institutional controls in place.

Date of Government Version: 01/04/2014	Source: Department of Health
Date Data Arrived at EDR: 02/26/2014	Telephone: 808-586-4249
Date Made Active in Reports: 03/07/2014	Last EDR Contact: 02/26/2014
Number of Days to Update: 9	Next Scheduled EDR Contact: 06/09/2014
	Data Release Frequency: Varies

State and tribal voluntary cleanup sites

INDIAN VCP R7: Voluntary Cleanup Priority Listing

A listing of voluntary cleanup priority sites located on Indian Land located in Region 7.

Date of Government Version: 03/20/2008	Source: EPA Region 7
Date Data Arrived at EDR: 04/22/2008	Telephone: 913-551-7365
Date Made Active in Reports: 05/19/2009	Last EDR Contact: 04/20/2009
Number of Days to Update: 27	Next Scheduled EDR Contact: 07/20/2009
	Data Release Frequency: Varies

INDIAN VCP R1: Voluntary Cleanup Priority Listing

A listing of voluntary cleanup priority sites located on Indian Land located in Region 1.

Date of Government Version: 09/17/2013	Source: EPA, Region 1
Date Data Arrived at EDR: 10/01/2013	Telephone: 617-918-1102
Date Made Active in Reports: 12/06/2013	Last EDR Contact: 01/03/2014
Number of Days to Update: 66	Next Scheduled EDR Contact: 04/14/2014
	Data Release Frequency: Varies

GOVERNMENT RECORDS SEARCHED / DATA CURRENCY TRACKING

VCP: Voluntary Response Program Sites

Sites participating in the Voluntary Response Program. The purpose of the VRP is to streamline the cleanup process in a way that will encourage prospective developers, lenders, and purchasers to voluntarily cleanup properties.

Date of Government Version: 01/04/2014
Date Data Arrived at EDR: 02/26/2014
Date Made Active in Reports: 03/07/2014
Number of Days to Update: 9

Source: Department of Health
Telephone: 808-586-4249
Last EDR Contact: 02/26/2014
Next Scheduled EDR Contact: 06/09/2014
Data Release Frequency: Varies

State and tribal Brownfields sites

BROWNFIELDS: Brownfields Sites

With certain legal exclusions and additions, the term 'brownfield site' means real property, the expansion, redevelopment, or reuse of which may be complicated by the presence or potential presence of a hazardous substance, pollutant, or contaminant.

Date of Government Version: 01/04/2014
Date Data Arrived at EDR: 02/26/2014
Date Made Active in Reports: 03/07/2014
Number of Days to Update: 9

Source: Department of Health
Telephone: 808-586-4249
Last EDR Contact: 02/26/2014
Next Scheduled EDR Contact: 06/09/2014
Data Release Frequency: Varies

ADDITIONAL ENVIRONMENTAL RECORDS

Local Brownfield lists

US BROWNFIELDS: A Listing of Brownfields Sites

Brownfields are real property, the expansion, redevelopment, or reuse of which may be complicated by the presence or potential presence of a hazardous substance, pollutant, or contaminant. Cleaning up and reinvesting in these properties takes development pressures off of undeveloped, open land, and both improves and protects the environment. Assessment, Cleanup and Redevelopment Exchange System (ACRES) stores information reported by EPA Brownfields grant recipients on brownfields properties assessed or cleaned up with grant funding as well as information on Targeted Brownfields Assessments performed by EPA Regions. A listing of ACRES Brownfield sites is obtained from Cleanups in My Community. Cleanups in My Community provides information on Brownfields properties for which information is reported back to EPA, as well as areas served by Brownfields grant programs.

Date of Government Version: 09/24/2013
Date Data Arrived at EDR: 09/24/2013
Date Made Active in Reports: 12/06/2013
Number of Days to Update: 73

Source: Environmental Protection Agency
Telephone: 202-566-2777
Last EDR Contact: 02/25/2014
Next Scheduled EDR Contact: 04/07/2014
Data Release Frequency: Semi-Annually

Local Lists of Landfill / Solid Waste Disposal Sites

DEBRIS REGION 9: Torres Martinez Reservation Illegal Dump Site Locations

A listing of illegal dump sites location on the Torres Martinez Indian Reservation located in eastern Riverside County and northern Imperial County, California.

Date of Government Version: 01/12/2009
Date Data Arrived at EDR: 05/07/2009
Date Made Active in Reports: 09/21/2009
Number of Days to Update: 137

Source: EPA, Region 9
Telephone: 415-947-4219
Last EDR Contact: 01/27/2014
Next Scheduled EDR Contact: 05/12/2014
Data Release Frequency: No Update Planned

ODI: Open Dump Inventory

An open dump is defined as a disposal facility that does not comply with one or more of the Part 257 or Part 258 Subtitle D Criteria.

Date of Government Version: 06/30/1985
Date Data Arrived at EDR: 08/09/2004
Date Made Active in Reports: 09/17/2004
Number of Days to Update: 39

Source: Environmental Protection Agency
Telephone: 800-424-9346
Last EDR Contact: 06/09/2004
Next Scheduled EDR Contact: N/A
Data Release Frequency: No Update Planned

GOVERNMENT RECORDS SEARCHED / DATA CURRENCY TRACKING

INDIAN ODI: Report on the Status of Open Dumps on Indian Lands

Location of open dumps on Indian land.

Date of Government Version: 12/31/1998
Date Data Arrived at EDR: 12/03/2007
Date Made Active in Reports: 01/24/2008
Number of Days to Update: 52

Source: Environmental Protection Agency
Telephone: 703-308-8245
Last EDR Contact: 11/04/2013
Next Scheduled EDR Contact: 02/17/2014
Data Release Frequency: Varies

Local Lists of Hazardous waste / Contaminated Sites

US CDL: Clandestine Drug Labs

A listing of clandestine drug lab locations. The U.S. Department of Justice ("the Department") provides this web site as a public service. It contains addresses of some locations where law enforcement agencies reported they found chemicals or other items that indicated the presence of either clandestine drug laboratories or dumpsites. In most cases, the source of the entries is not the Department, and the Department has not verified the entry and does not guarantee its accuracy. Members of the public must verify the accuracy of all entries by, for example, contacting local law enforcement and local health departments.

Date of Government Version: 12/04/2013
Date Data Arrived at EDR: 12/10/2013
Date Made Active in Reports: 02/13/2014
Number of Days to Update: 65

Source: Drug Enforcement Administration
Telephone: 202-307-1000
Last EDR Contact: 03/04/2014
Next Scheduled EDR Contact: 06/16/2014
Data Release Frequency: Quarterly

CDL: Clandestine Drug Lab Listing

A listing of clandestine drug lab site locations.

Date of Government Version: 08/04/2010
Date Data Arrived at EDR: 09/10/2010
Date Made Active in Reports: 10/22/2010
Number of Days to Update: 42

Source: Department of Health
Telephone: 808-586-4249
Last EDR Contact: 03/03/2014
Next Scheduled EDR Contact: 06/16/2014
Data Release Frequency: Varies

US HIST CDL: National Clandestine Laboratory Register

A listing of clandestine drug lab locations. The U.S. Department of Justice ("the Department") provides this web site as a public service. It contains addresses of some locations where law enforcement agencies reported they found chemicals or other items that indicated the presence of either clandestine drug laboratories or dumpsites. In most cases, the source of the entries is not the Department, and the Department has not verified the entry and does not guarantee its accuracy. Members of the public must verify the accuracy of all entries by, for example, contacting local law enforcement and local health departments.

Date of Government Version: 09/01/2007
Date Data Arrived at EDR: 11/19/2008
Date Made Active in Reports: 03/30/2009
Number of Days to Update: 131

Source: Drug Enforcement Administration
Telephone: 202-307-1000
Last EDR Contact: 03/04/2014
Next Scheduled EDR Contact: 06/16/2014
Data Release Frequency: No Update Planned

Local Land Records

LIENS 2: CERCLA Lien Information

A Federal CERCLA ("Superfund") lien can exist by operation of law at any site or property at which EPA has spent Superfund monies. These monies are spent to investigate and address releases and threatened releases of contamination. CERCLIS provides information as to the identity of these sites and properties.

Date of Government Version: 02/06/2013
Date Data Arrived at EDR: 04/25/2013
Date Made Active in Reports: 05/10/2013
Number of Days to Update: 15

Source: Environmental Protection Agency
Telephone: 202-564-6023
Last EDR Contact: 01/27/2014
Next Scheduled EDR Contact: 05/12/2014
Data Release Frequency: Varies

GOVERNMENT RECORDS SEARCHED / DATA CURRENCY TRACKING

Records of Emergency Release Reports

HMIRS: Hazardous Materials Information Reporting System

Hazardous Materials Incident Report System. HMIRS contains hazardous material spill incidents reported to DOT.

Date of Government Version: 12/31/2013	Source: U.S. Department of Transportation
Date Data Arrived at EDR: 01/03/2014	Telephone: 202-366-4555
Date Made Active in Reports: 02/24/2014	Last EDR Contact: 01/03/2014
Number of Days to Update: 52	Next Scheduled EDR Contact: 01/13/2014
	Data Release Frequency: Annually

SPILLS: Release Notifications

Releases of hazardous substances to the environment reported to the Office of Hazard Evaluation and Emergency Response since 1988.

Date of Government Version: 01/04/2014	Source: Department of Health
Date Data Arrived at EDR: 02/26/2014	Telephone: 808-586-4249
Date Made Active in Reports: 03/10/2014	Last EDR Contact: 02/26/2014
Number of Days to Update: 12	Next Scheduled EDR Contact: 06/09/2014
	Data Release Frequency: Varies

SPILLS 90: SPILLS90 data from FirstSearch

Spills 90 includes those spill and release records available exclusively from FirstSearch databases. Typically, they may include chemical, oil and/or hazardous substance spills recorded after 1990. Duplicate records that are already included in EDR incident and release records are not included in Spills 90.

Date of Government Version: 03/10/2012	Source: FirstSearch
Date Data Arrived at EDR: 01/03/2013	Telephone: N/A
Date Made Active in Reports: 02/11/2013	Last EDR Contact: 01/03/2013
Number of Days to Update: 39	Next Scheduled EDR Contact: N/A
	Data Release Frequency: No Update Planned

Other Ascertainable Records

RCRA NonGen / NLR: RCRA - Non Generators

RCRAInfo is EPA's comprehensive information system, providing access to data supporting the Resource Conservation and Recovery Act (RCRA) of 1976 and the Hazardous and Solid Waste Amendments (HSWA) of 1984. The database includes selective information on sites which generate, transport, store, treat and/or dispose of hazardous waste as defined by the Resource Conservation and Recovery Act (RCRA). Non-Generators do not presently generate hazardous waste.

Date of Government Version: 09/10/2013	Source: Environmental Protection Agency
Date Data Arrived at EDR: 10/02/2013	Telephone: (415) 495-8895
Date Made Active in Reports: 12/16/2013	Last EDR Contact: 01/02/2014
Number of Days to Update: 75	Next Scheduled EDR Contact: 04/14/2014
	Data Release Frequency: Varies

DOT OPS: Incident and Accident Data

Department of Transportation, Office of Pipeline Safety Incident and Accident data.

Date of Government Version: 07/31/2012	Source: Department of Transportation, Office of Pipeline Safety
Date Data Arrived at EDR: 08/07/2012	Telephone: 202-366-4595
Date Made Active in Reports: 09/18/2012	Last EDR Contact: 02/06/2014
Number of Days to Update: 42	Next Scheduled EDR Contact: 05/19/2014
	Data Release Frequency: Varies

DOD: Department of Defense Sites

This data set consists of federally owned or administered lands, administered by the Department of Defense, that have any area equal to or greater than 640 acres of the United States, Puerto Rico, and the U.S. Virgin Islands.

GOVERNMENT RECORDS SEARCHED / DATA CURRENCY TRACKING

Date of Government Version: 12/31/2005
Date Data Arrived at EDR: 11/10/2006
Date Made Active in Reports: 01/11/2007
Number of Days to Update: 62

Source: USGS
Telephone: 888-275-8747
Last EDR Contact: 01/15/2014
Next Scheduled EDR Contact: 04/28/2014
Data Release Frequency: Semi-Annually

FUDS: Formerly Used Defense Sites

The listing includes locations of Formerly Used Defense Sites properties where the US Army Corps of Engineers is actively working or will take necessary cleanup actions.

Date of Government Version: 12/31/2011
Date Data Arrived at EDR: 02/26/2013
Date Made Active in Reports: 03/13/2013
Number of Days to Update: 15

Source: U.S. Army Corps of Engineers
Telephone: 202-528-4285
Last EDR Contact: 02/28/2014
Next Scheduled EDR Contact: 03/24/2014
Data Release Frequency: Varies

CONSENT: Superfund (CERCLA) Consent Decrees

Major legal settlements that establish responsibility and standards for cleanup at NPL (Superfund) sites. Released periodically by United States District Courts after settlement by parties to litigation matters.

Date of Government Version: 12/31/2013
Date Data Arrived at EDR: 01/24/2014
Date Made Active in Reports: 02/24/2014
Number of Days to Update: 31

Source: Department of Justice, Consent Decree Library
Telephone: Varies
Last EDR Contact: 12/26/2013
Next Scheduled EDR Contact: 04/14/2014
Data Release Frequency: Varies

ROD: Records Of Decision

Record of Decision. ROD documents mandate a permanent remedy at an NPL (Superfund) site containing technical and health information to aid in the cleanup.

Date of Government Version: 11/25/2013
Date Data Arrived at EDR: 12/12/2013
Date Made Active in Reports: 02/24/2014
Number of Days to Update: 74

Source: EPA
Telephone: 703-416-0223
Last EDR Contact: 12/12/2013
Next Scheduled EDR Contact: 03/24/2014
Data Release Frequency: Annually

UMTRA: Uranium Mill Tailings Sites

Uranium ore was mined by private companies for federal government use in national defense programs. When the mills shut down, large piles of the sand-like material (mill tailings) remain after uranium has been extracted from the ore. Levels of human exposure to radioactive materials from the piles are low, however, in some cases tailings were used as construction materials before the potential health hazards of the tailings were recognized.

Date of Government Version: 09/14/2010
Date Data Arrived at EDR: 10/07/2011
Date Made Active in Reports: 03/01/2012
Number of Days to Update: 146

Source: Department of Energy
Telephone: 505-845-0011
Last EDR Contact: 02/25/2014
Next Scheduled EDR Contact: 06/09/2014
Data Release Frequency: Varies

US MINES: Mines Master Index File

Contains all mine identification numbers issued for mines active or opened since 1971. The data also includes violation information.

Date of Government Version: 08/01/2013
Date Data Arrived at EDR: 09/05/2013
Date Made Active in Reports: 10/03/2013
Number of Days to Update: 28

Source: Department of Labor, Mine Safety and Health Administration
Telephone: 303-231-5959
Last EDR Contact: 03/05/2014
Next Scheduled EDR Contact: 06/16/2014
Data Release Frequency: Semi-Annually

TRIS: Toxic Chemical Release Inventory System

Toxic Release Inventory System. TRIS identifies facilities which release toxic chemicals to the air, water and land in reportable quantities under SARA Title III Section 313.

GOVERNMENT RECORDS SEARCHED / DATA CURRENCY TRACKING

Date of Government Version: 12/31/2011
 Date Data Arrived at EDR: 07/31/2013
 Date Made Active in Reports: 09/13/2013
 Number of Days to Update: 44

Source: EPA
 Telephone: 202-566-0250
 Last EDR Contact: 02/26/2014
 Next Scheduled EDR Contact: 06/09/2014
 Data Release Frequency: Annually

TSCA: Toxic Substances Control Act

Toxic Substances Control Act. TSCA identifies manufacturers and importers of chemical substances included on the TSCA Chemical Substance Inventory list. It includes data on the production volume of these substances by plant site.

Date of Government Version: 12/31/2006
 Date Data Arrived at EDR: 09/29/2010
 Date Made Active in Reports: 12/02/2010
 Number of Days to Update: 64

Source: EPA
 Telephone: 202-260-5521
 Last EDR Contact: 12/26/2013
 Next Scheduled EDR Contact: 04/07/2014
 Data Release Frequency: Every 4 Years

FTTS: FIFRA/ TSCA Tracking System - FIFRA (Federal Insecticide, Fungicide, & Rodenticide Act)/TSCA (Toxic Substances Control Act)

FTTS tracks administrative cases and pesticide enforcement actions and compliance activities related to FIFRA, TSCA and EPCRA (Emergency Planning and Community Right-to-Know Act). To maintain currency, EDR contacts the Agency on a quarterly basis.

Date of Government Version: 04/09/2009
 Date Data Arrived at EDR: 04/16/2009
 Date Made Active in Reports: 05/11/2009
 Number of Days to Update: 25

Source: EPA/Office of Prevention, Pesticides and Toxic Substances
 Telephone: 202-566-1667
 Last EDR Contact: 02/24/2014
 Next Scheduled EDR Contact: 06/09/2014
 Data Release Frequency: Quarterly

FTTS INSP: FIFRA/ TSCA Tracking System - FIFRA (Federal Insecticide, Fungicide, & Rodenticide Act)/TSCA (Toxic Substances Control Act)

A listing of FIFRA/TSCA Tracking System (FTTS) inspections and enforcements.

Date of Government Version: 04/09/2009
 Date Data Arrived at EDR: 04/16/2009
 Date Made Active in Reports: 05/11/2009
 Number of Days to Update: 25

Source: EPA
 Telephone: 202-566-1667
 Last EDR Contact: 02/24/2014
 Next Scheduled EDR Contact: 06/09/2014
 Data Release Frequency: Quarterly

HIST FTTS: FIFRA/TSCA Tracking System Administrative Case Listing

A complete administrative case listing from the FIFRA/TSCA Tracking System (FTTS) for all ten EPA regions. The information was obtained from the National Compliance Database (NCDB). NCDB supports the implementation of FIFRA (Federal Insecticide, Fungicide, and Rodenticide Act) and TSCA (Toxic Substances Control Act). Some EPA regions are now closing out records. Because of that, and the fact that some EPA regions are not providing EPA Headquarters with updated records, it was decided to create a HIST FTTS database. It included records that may not be included in the newer FTTS database updates. This database is no longer updated.

Date of Government Version: 10/19/2006
 Date Data Arrived at EDR: 03/01/2007
 Date Made Active in Reports: 04/10/2007
 Number of Days to Update: 40

Source: Environmental Protection Agency
 Telephone: 202-564-2501
 Last EDR Contact: 12/17/2007
 Next Scheduled EDR Contact: 03/17/2008
 Data Release Frequency: No Update Planned

HIST FTTS INSP: FIFRA/TSCA Tracking System Inspection & Enforcement Case Listing

A complete inspection and enforcement case listing from the FIFRA/TSCA Tracking System (FTTS) for all ten EPA regions. The information was obtained from the National Compliance Database (NCDB). NCDB supports the implementation of FIFRA (Federal Insecticide, Fungicide, and Rodenticide Act) and TSCA (Toxic Substances Control Act). Some EPA regions are now closing out records. Because of that, and the fact that some EPA regions are not providing EPA Headquarters with updated records, it was decided to create a HIST FTTS database. It included records that may not be included in the newer FTTS database updates. This database is no longer updated.

GOVERNMENT RECORDS SEARCHED / DATA CURRENCY TRACKING

Date of Government Version: 10/19/2006
 Date Data Arrived at EDR: 03/01/2007
 Date Made Active in Reports: 04/10/2007
 Number of Days to Update: 40

Source: Environmental Protection Agency
 Telephone: 202-564-2501
 Last EDR Contact: 12/17/2008
 Next Scheduled EDR Contact: 03/17/2008
 Data Release Frequency: No Update Planned

SSTS: Section 7 Tracking Systems

Section 7 of the Federal Insecticide, Fungicide and Rodenticide Act, as amended (92 Stat. 829) requires all registered pesticide-producing establishments to submit a report to the Environmental Protection Agency by March 1st each year. Each establishment must report the types and amounts of pesticides, active ingredients and devices being produced, and those having been produced and sold or distributed in the past year.

Date of Government Version: 12/31/2009
 Date Data Arrived at EDR: 12/10/2010
 Date Made Active in Reports: 02/25/2011
 Number of Days to Update: 77

Source: EPA
 Telephone: 202-564-4203
 Last EDR Contact: 01/28/2014
 Next Scheduled EDR Contact: 05/12/2014
 Data Release Frequency: Annually

ICIS: Integrated Compliance Information System

The Integrated Compliance Information System (ICIS) supports the information needs of the national enforcement and compliance program as well as the unique needs of the National Pollutant Discharge Elimination System (NPDES) program.

Date of Government Version: 07/20/2011
 Date Data Arrived at EDR: 11/10/2011
 Date Made Active in Reports: 11/09/2012
 Number of Days to Update: 61

Source: Environmental Protection Agency
 Telephone: 202-564-5088
 Last EDR Contact: 01/09/2014
 Next Scheduled EDR Contact: 04/28/2014
 Data Release Frequency: Quarterly

PADS: PCB Activity Database System

PCB Activity Database. PADS identifies generators, transporters, commercial storers and/or brokers and disposers of PCB's who are required to notify the EPA of such activities.

Date of Government Version: 06/01/2013
 Date Data Arrived at EDR: 07/17/2013
 Date Made Active in Reports: 11/01/2013
 Number of Days to Update: 107

Source: EPA
 Telephone: 202-566-0500
 Last EDR Contact: 01/28/2014
 Next Scheduled EDR Contact: 04/28/2014
 Data Release Frequency: Annually

MLTS: Material Licensing Tracking System

MLTS is maintained by the Nuclear Regulatory Commission and contains a list of approximately 8,100 sites which possess or use radioactive materials and which are subject to NRC licensing requirements. To maintain currency, EDR contacts the Agency on a quarterly basis.

Date of Government Version: 07/22/2013
 Date Data Arrived at EDR: 08/02/2013
 Date Made Active in Reports: 11/01/2013
 Number of Days to Update: 91

Source: Nuclear Regulatory Commission
 Telephone: 301-415-7169
 Last EDR Contact: 12/09/2013
 Next Scheduled EDR Contact: 03/24/2014
 Data Release Frequency: Quarterly

RADINFO: Radiation Information Database

The Radiation Information Database (RADINFO) contains information about facilities that are regulated by U.S. Environmental Protection Agency (EPA) regulations for radiation and radioactivity.

Date of Government Version: 09/30/2013
 Date Data Arrived at EDR: 10/09/2013
 Date Made Active in Reports: 11/01/2013
 Number of Days to Update: 23

Source: Environmental Protection Agency
 Telephone: 202-343-9775
 Last EDR Contact: 01/10/2014
 Next Scheduled EDR Contact: 04/21/2014
 Data Release Frequency: Quarterly

GOVERNMENT RECORDS SEARCHED / DATA CURRENCY TRACKING

FINDS: Facility Index System/Facility Registry System

Facility Index System, FINDS contains both facility information and 'pointers' to other sources that contain more detail. EDR includes the following FINDS databases in this report: PCS (Permit Compliance System), AIRS (Aerometric Information Retrieval System), DOCKET (Enforcement Docket used to manage and track information on civil judicial enforcement cases for all environmental statutes), FURS (Federal Underground Injection Control), C-DOCKET (Criminal Docket System used to track criminal enforcement actions for all environmental statutes), FFIS (Federal Facilities Information System), STATE (State Environmental Laws and Statutes), and PADS (PCB Activity Data System).

Date of Government Version: 03/08/2013	Source: EPA
Date Data Arrived at EDR: 03/21/2013	Telephone: (415) 947-8000
Date Made Active in Reports: 07/10/2013	Last EDR Contact: 12/10/2013
Number of Days to Update: 111	Next Scheduled EDR Contact: 03/24/2014
	Data Release Frequency: Quarterly

RAATS: RCRA Administrative Action Tracking System

RCRA Administration Action Tracking System. RAATS contains records based on enforcement actions issued under RCRA pertaining to major violators and includes administrative and civil actions brought by the EPA. For administration actions after September 30, 1995, data entry in the RAATS database was discontinued. EPA will retain a copy of the database for historical records. It was necessary to terminate RAATS because a decrease in agency resources made it impossible to continue to update the information contained in the database.

Date of Government Version: 04/17/1995	Source: EPA
Date Data Arrived at EDR: 07/03/1995	Telephone: 202-564-4104
Date Made Active in Reports: 08/07/1995	Last EDR Contact: 06/02/2008
Number of Days to Update: 35	Next Scheduled EDR Contact: 09/01/2008
	Data Release Frequency: No Update Planned

RMP: Risk Management Plans

When Congress passed the Clean Air Act Amendments of 1990, it required EPA to publish regulations and guidance for chemical accident prevention at facilities using extremely hazardous substances. The Risk Management Program Rule (RMP Rule) was written to implement Section 112(r) of these amendments. The rule, which built upon existing industry codes and standards, requires companies of all sizes that use certain flammable and toxic substances to develop a Risk Management Program, which includes a(n): Hazard assessment that details the potential effects of an accidental release, an accident history of the last five years, and an evaluation of worst-case and alternative accidental releases; Prevention program that includes safety precautions and maintenance, monitoring, and employee training measures; and Emergency response program that spells out emergency health care, employee training measures and procedures for informing the public and response agencies (e.g the fire department) should an accident occur.

Date of Government Version: 11/01/2013	Source: Environmental Protection Agency
Date Data Arrived at EDR: 12/12/2013	Telephone: 202-564-8600
Date Made Active in Reports: 02/13/2014	Last EDR Contact: 01/27/2014
Number of Days to Update: 63	Next Scheduled EDR Contact: 05/12/2014
	Data Release Frequency: Varies

BRS: Biennial Reporting System

The Biennial Reporting System is a national system administered by the EPA that collects data on the generation and management of hazardous waste. BRS captures detailed data from two groups: Large Quantity Generators (LQG) and Treatment, Storage, and Disposal Facilities.

Date of Government Version: 12/31/2011	Source: EPA/NTIS
Date Data Arrived at EDR: 02/26/2013	Telephone: 800-424-9346
Date Made Active in Reports: 04/19/2013	Last EDR Contact: 02/28/2014
Number of Days to Update: 52	Next Scheduled EDR Contact: 06/09/2014
	Data Release Frequency: Biennially

UIC: Underground Injection Wells Listing

A listing of underground injection well locations.

Date of Government Version: 02/07/2013	Source: Department of Health
Date Data Arrived at EDR: 02/12/2013	Telephone: 808-586-4258
Date Made Active in Reports: 04/09/2013	Last EDR Contact: 03/03/2014
Number of Days to Update: 56	Next Scheduled EDR Contact: 06/16/2014
	Data Release Frequency: Varies

GOVERNMENT RECORDS SEARCHED / DATA CURRENCY TRACKING

DRYCLEANERS: Permitted Drycleaner Facility Listing

A listing of permitted drycleaner facilities in the state.

Date of Government Version: 01/01/2014	Source: Department of Health
Date Data Arrived at EDR: 02/21/2014	Telephone: 808-586-4200
Date Made Active in Reports: 03/07/2014	Last EDR Contact: 01/03/2014
Number of Days to Update: 14	Next Scheduled EDR Contact: 04/21/2014
	Data Release Frequency: Varies

AIRS: List of Permitted Facilities

A listing of permitted facilities in the state.

Date of Government Version: 01/01/2014	Source: Department of Health
Date Data Arrived at EDR: 02/21/2014	Telephone: 808-586-4200
Date Made Active in Reports: 03/07/2014	Last EDR Contact: 01/03/2014
Number of Days to Update: 14	Next Scheduled EDR Contact: 04/21/2014
	Data Release Frequency: Varies

INDIAN RESERV: Indian Reservations

This map layer portrays Indian administered lands of the United States that have any area equal to or greater than 640 acres.

Date of Government Version: 12/31/2005	Source: USGS
Date Data Arrived at EDR: 12/08/2006	Telephone: 202-208-3710
Date Made Active in Reports: 01/11/2007	Last EDR Contact: 01/15/2014
Number of Days to Update: 34	Next Scheduled EDR Contact: 04/28/2014
	Data Release Frequency: Semi-Annually

SCRD DRYCLEANERS: State Coalition for Remediation of Drycleaners Listing

The State Coalition for Remediation of Drycleaners was established in 1998, with support from the U.S. EPA Office of Superfund Remediation and Technology Innovation. It is comprised of representatives of states with established drycleaner remediation programs. Currently the member states are Alabama, Connecticut, Florida, Illinois, Kansas, Minnesota, Missouri, North Carolina, Oregon, South Carolina, Tennessee, Texas, and Wisconsin.

Date of Government Version: 03/07/2011	Source: Environmental Protection Agency
Date Data Arrived at EDR: 03/09/2011	Telephone: 615-532-8599
Date Made Active in Reports: 05/02/2011	Last EDR Contact: 01/20/2014
Number of Days to Update: 54	Next Scheduled EDR Contact: 05/05/2014
	Data Release Frequency: Varies

COAL ASH DOE: Steam-Electric Plan Operation Data

A listing of power plants that store ash in surface ponds.

Date of Government Version: 12/31/2005	Source: Department of Energy
Date Data Arrived at EDR: 08/07/2009	Telephone: 202-586-8719
Date Made Active in Reports: 10/22/2009	Last EDR Contact: 01/13/2014
Number of Days to Update: 76	Next Scheduled EDR Contact: 04/28/2014
	Data Release Frequency: Varies

EPA WATCH LIST: EPA WATCH LIST

EPA maintains a "Watch List" to facilitate dialogue between EPA, state and local environmental agencies on enforcement matters relating to facilities with alleged violations identified as either significant or high priority. Being on the Watch List does not mean that the facility has actually violated the law only that an investigation by EPA or a state or local environmental agency has led those organizations to allege that an unproven violation has in fact occurred. Being on the Watch List does not represent a higher level of concern regarding the alleged violations that were detected, but instead indicates cases requiring additional dialogue between EPA, state and local agencies - primarily because of the length of time the alleged violation has gone unaddressed or unresolved.

Date of Government Version: 06/30/2013	Source: Environmental Protection Agency
Date Data Arrived at EDR: 08/13/2013	Telephone: 617-520-3000
Date Made Active in Reports: 09/13/2013	Last EDR Contact: 02/10/2014
Number of Days to Update: 31	Next Scheduled EDR Contact: 05/26/2014
	Data Release Frequency: Quarterly

GOVERNMENT RECORDS SEARCHED / DATA CURRENCY TRACKING

PRP: Potentially Responsible Parties

A listing of verified Potentially Responsible Parties

Date of Government Version: 04/15/2013	Source: EPA
Date Data Arrived at EDR: 07/03/2013	Telephone: 202-564-5962
Date Made Active in Reports: 09/13/2013	Last EDR Contact: 01/02/2014
Number of Days to Update: 72	Next Scheduled EDR Contact: 04/14/2014
	Data Release Frequency: Quarterly

2020 COR ACTION: 2020 Corrective Action Program List

The EPA has set ambitious goals for the RCRA Corrective Action program by creating the 2020 Corrective Action Universe. This RCRA cleanup baseline includes facilities expected to need corrective action. The 2020 universe contains a wide variety of sites. Some properties are heavily contaminated while others were contaminated but have since been cleaned up. Still others have not been fully investigated yet, and may require little or no remediation. Inclusion in the 2020 Universe does not necessarily imply failure on the part of a facility to meet its RCRA obligations.

Date of Government Version: 11/11/2011	Source: Environmental Protection Agency
Date Data Arrived at EDR: 05/18/2012	Telephone: 703-308-4044
Date Made Active in Reports: 05/25/2012	Last EDR Contact: 02/14/2014
Number of Days to Update: 7	Next Scheduled EDR Contact: 05/26/2014
	Data Release Frequency: Varies

LEAD SMELTER 1: Lead Smelter Sites

A listing of former lead smelter site locations.

Date of Government Version: 01/29/2013	Source: Environmental Protection Agency
Date Data Arrived at EDR: 02/14/2013	Telephone: 703-603-8787
Date Made Active in Reports: 02/27/2013	Last EDR Contact: 01/03/2014
Number of Days to Update: 13	Next Scheduled EDR Contact: 04/21/2014
	Data Release Frequency: Varies

FEDLAND: Federal and Indian Lands

Federally and Indian administrated lands of the United States. Lands included are administrated by: Army Corps of Engineers, Bureau of Reclamation, National Wild and Scenic River, National Wildlife Refuge, Public Domain Land, Wilderness, Wilderness Study Area, Wildlife Management Area, Bureau of Indian Affairs, Bureau of Land Management, Department of Justice, Forest Service, Fish and Wildlife Service, National Park Service.

Date of Government Version: 12/31/2005	Source: U.S. Geological Survey
Date Data Arrived at EDR: 02/06/2006	Telephone: 888-275-8747
Date Made Active in Reports: 01/11/2007	Last EDR Contact: 01/15/2014
Number of Days to Update: 339	Next Scheduled EDR Contact: 04/28/2014
	Data Release Frequency: N/A

LEAD SMELTER 2: Lead Smelter Sites

A list of several hundred sites in the U.S. where secondary lead smelting was done from 1931 and 1964. These sites may pose a threat to public health through ingestion or inhalation of contaminated soil or dust

Date of Government Version: 04/05/2001	Source: American Journal of Public Health
Date Data Arrived at EDR: 10/27/2010	Telephone: 703-305-6451
Date Made Active in Reports: 12/02/2010	Last EDR Contact: 12/02/2009
Number of Days to Update: 36	Next Scheduled EDR Contact: N/A
	Data Release Frequency: No Update Planned

US AIRS (AFS): Aerometric Information Retrieval System Facility Subsystem (AFS)

The database is a sub-system of Aerometric Information Retrieval System (AIRS). AFS contains compliance data on air pollution point sources regulated by the U.S. EPA and/or state and local air regulatory agencies. This information comes from source reports by various stationary sources of air pollution, such as electric power plants, steel mills, factories, and universities, and provides information about the air pollutants they produce. Action, air program, air program pollutant, and general level plant data. It is used to track emissions and compliance data from industrial plants.

GOVERNMENT RECORDS SEARCHED / DATA CURRENCY TRACKING

Date of Government Version: 10/23/2013	Source: EPA
Date Data Arrived at EDR: 11/06/2013	Telephone: 202-564-5962
Date Made Active in Reports: 12/06/2013	Last EDR Contact: 12/26/2013
Number of Days to Update: 30	Next Scheduled EDR Contact: 04/14/2014
	Data Release Frequency: Annually

US AIRS MINOR: Air Facility System Data

A listing of minor source facilities.

Date of Government Version: 10/23/2013	Source: EPA
Date Data Arrived at EDR: 11/06/2013	Telephone: 202-564-5962
Date Made Active in Reports: 12/06/2013	Last EDR Contact: 12/26/2013
Number of Days to Update: 30	Next Scheduled EDR Contact: 04/14/2014
	Data Release Frequency: Annually

Financial Assurance: Financial Assurance Information Listing

A listing of financial assurance information for underground storage tank facilities. Financial assurance is intended to ensure that resources are available to pay for the cost of closure, post-closure care, and corrective measures if the owner or operator of a regulated facility is unable or unwilling to pay.

Date of Government Version: 01/23/2014	Source: Department of Health
Date Data Arrived at EDR: 01/24/2014	Telephone: 808-586-4226
Date Made Active in Reports: 03/07/2014	Last EDR Contact: 01/13/2014
Number of Days to Update: 42	Next Scheduled EDR Contact: 03/31/2014
	Data Release Frequency: Varies

US FIN ASSUR: Financial Assurance Information

All owners and operators of facilities that treat, store, or dispose of hazardous waste are required to provide proof that they will have sufficient funds to pay for the clean up, closure, and post-closure care of their facilities.

Date of Government Version: 11/20/2013	Source: Environmental Protection Agency
Date Data Arrived at EDR: 12/03/2013	Telephone: 202-566-1917
Date Made Active in Reports: 02/13/2014	Last EDR Contact: 02/14/2014
Number of Days to Update: 72	Next Scheduled EDR Contact: 06/02/2014
	Data Release Frequency: Quarterly

COAL ASH EPA: Coal Combustion Residues Surface Impoundments List

A listing of coal combustion residues surface impoundments with high hazard potential ratings.

Date of Government Version: 08/17/2010	Source: Environmental Protection Agency
Date Data Arrived at EDR: 01/03/2011	Telephone: N/A
Date Made Active in Reports: 03/21/2011	Last EDR Contact: 12/13/2013
Number of Days to Update: 77	Next Scheduled EDR Contact: 03/24/2014
	Data Release Frequency: Varies

PCB TRANSFORMER: PCB Transformer Registration Database

The database of PCB transformer registrations that includes all PCB registration submittals.

Date of Government Version: 02/01/2011	Source: Environmental Protection Agency
Date Data Arrived at EDR: 10/19/2011	Telephone: 202-566-0517
Date Made Active in Reports: 01/10/2012	Last EDR Contact: 01/30/2014
Number of Days to Update: 83	Next Scheduled EDR Contact: 05/12/2014
	Data Release Frequency: Varies

EDR HIGH RISK HISTORICAL RECORDS

EDR Exclusive Records

EDR MGP: EDR Proprietary Manufactured Gas Plants

The EDR Proprietary Manufactured Gas Plant Database includes records of coal gas plants (manufactured gas plants) compiled by EDR's researchers. Manufactured gas sites were used in the United States from the 1800's to 1950's to produce a gas that could be distributed and used as fuel. These plants used whale oil, rosin, coal, or a mixture of coal, oil, and water that also produced a significant amount of waste. Many of the byproducts of the gas production, such as coal tar (oil waste containing volatile and non-volatile chemicals), sludges, oils and other compounds are potentially hazardous to human health and the environment. The byproduct from this process was frequently disposed of directly at the plant site and can remain or spread slowly, serving as a continuous source of soil and groundwater contamination.

GOVERNMENT RECORDS SEARCHED / DATA CURRENCY TRACKING

Date of Government Version: N/A
Date Data Arrived at EDR: N/A
Date Made Active in Reports: N/A
Number of Days to Update: N/A

Source: EDR, Inc.
Telephone: N/A
Last EDR Contact: N/A
Next Scheduled EDR Contact: N/A
Data Release Frequency: No Update Planned

EDR US Hist Auto Stat: EDR Exclusive Historic Gas Stations

EDR has searched selected national collections of business directories and has collected listings of potential gas station/filling station/service station sites that were available to EDR researchers. EDR's review was limited to those categories of sources that might, in EDR's opinion, include gas station/filling station/service station establishments. The categories reviewed included, but were not limited to gas, gas station, gasoline station, filling station, auto, automobile repair, auto service station, service station, etc. This database falls within a category of information EDR classifies as "High Risk Historical Records", or HRHR. EDR's HRHR effort presents unique and sometimes proprietary data about past sites and operations that typically create environmental concerns, but may not show up in current government records searches.

Date of Government Version: N/A
Date Data Arrived at EDR: N/A
Date Made Active in Reports: N/A
Number of Days to Update: N/A

Source: EDR, Inc.
Telephone: N/A
Last EDR Contact: N/A
Next Scheduled EDR Contact: N/A
Data Release Frequency: Varies

EDR US Hist Cleaners: EDR Exclusive Historic Dry Cleaners

EDR has searched selected national collections of business directories and has collected listings of potential dry cleaner sites that were available to EDR researchers. EDR's review was limited to those categories of sources that might, in EDR's opinion, include dry cleaning establishments. The categories reviewed included, but were not limited to dry cleaners, cleaners, laundry, laundromat, cleaning/laundry, wash & dry etc. This database falls within a category of information EDR classifies as "High Risk Historical Records", or HRHR. EDR's HRHR effort presents unique and sometimes proprietary data about past sites and operations that typically create environmental concerns, but may not show up in current government records searches.

Date of Government Version: N/A
Date Data Arrived at EDR: N/A
Date Made Active in Reports: N/A
Number of Days to Update: N/A

Source: EDR, Inc.
Telephone: N/A
Last EDR Contact: N/A
Next Scheduled EDR Contact: N/A
Data Release Frequency: Varies

EDR US Hist Cleaners: EDR Proprietary Historic Dry Cleaners - Cole

Date of Government Version: N/A
Date Data Arrived at EDR: N/A
Date Made Active in Reports: N/A
Number of Days to Update: N/A

Source: N/A
Telephone: N/A
Last EDR Contact: N/A
Next Scheduled EDR Contact: N/A
Data Release Frequency: Varies

EDR US Hist Auto Stat: EDR Proprietary Historic Gas Stations - Cole

Date of Government Version: N/A
Date Data Arrived at EDR: N/A
Date Made Active in Reports: N/A
Number of Days to Update: N/A

Source: N/A
Telephone: N/A
Last EDR Contact: N/A
Next Scheduled EDR Contact: N/A
Data Release Frequency: Varies

EDR RECOVERED GOVERNMENT ARCHIVES

Exclusive Recovered Govt. Archives

RGALF: Recovered Government Archive Solid Waste Facilities List

The EDR Recovered Government Archive Landfill database provides a list of landfills derived from historical databases and includes many records that no longer appear in current government lists. Compiled from Records formerly available from the Department of Health in Hawaii.

GOVERNMENT RECORDS SEARCHED / DATA CURRENCY TRACKING

Date of Government Version: N/A
Date Data Arrived at EDR: 07/01/2013
Date Made Active in Reports: 01/17/2014
Number of Days to Update: 200

Source: Department of Health
Telephone: N/A
Last EDR Contact: 06/01/2012
Next Scheduled EDR Contact: N/A
Data Release Frequency: Varies

RGALUST: Recovered Government Archive Leaking Underground Storage Tank

The EDR Recovered Government Archive Leaking Underground Storage Tank database provides a list of LUST incidents derived from historical databases and includes many records that no longer appear in current government lists. Compiled from Records formerly available from the Department of Health in Hawaii.

Date of Government Version: N/A
Date Data Arrived at EDR: 07/01/2013
Date Made Active in Reports: 01/03/2014
Number of Days to Update: 186

Source: Department of Health
Telephone: N/A
Last EDR Contact: 06/01/2012
Next Scheduled EDR Contact: N/A
Data Release Frequency: Varies

RGASHWS: Recovered Government Archive State Hazardous Waste Facilities List

The EDR Recovered Government Archive State Hazardous Waste database provides a list of SHWS incidents derived from historical databases and includes many records that no longer appear in current government lists. Compiled from Records formerly available from the Department of Health in Hawaii.

Date of Government Version: N/A
Date Data Arrived at EDR: 07/01/2013
Date Made Active in Reports: 01/08/2014
Number of Days to Update: 191

Source: Department of Health
Telephone: N/A
Last EDR Contact: 06/01/2012
Next Scheduled EDR Contact: N/A
Data Release Frequency: Varies

OTHER DATABASE(S)

Depending on the geographic area covered by this report, the data provided in these specialty databases may or may not be complete. For example, the existence of wetlands information data in a specific report does not mean that all wetlands in the area covered by the report are included. Moreover, the absence of any reported wetlands information does not necessarily mean that wetlands do not exist in the area covered by the report.

Oil/Gas Pipelines: This data was obtained by EDR from the USGS in 1994. It is referred to by USGS as GeoData Digital Line Graphs from 1:100,000-Scale Maps. It was extracted from the transportation category including some oil, but primarily gas pipelines.

Electric Power Transmission Line Data

Source: Rextag Strategies Corp.
Telephone: (281) 769-2247
U.S. Electric Transmission and Power Plants Systems Digital GIS Data

Sensitive Receptors: There are individuals deemed sensitive receptors due to their fragile immune systems and special sensitivity to environmental discharges. These sensitive receptors typically include the elderly, the sick, and children. While the location of all sensitive receptors cannot be determined, EDR indicates those buildings and facilities - schools, daycares, hospitals, medical centers, and nursing homes - where individuals who are sensitive receptors are likely to be located.

AHA Hospitals:

Source: American Hospital Association, Inc.
Telephone: 312-280-5991
The database includes a listing of hospitals based on the American Hospital Association's annual survey of hospitals.

Medical Centers: Provider of Services Listing

Source: Centers for Medicare & Medicaid Services
Telephone: 410-786-3000

A listing of hospitals with Medicare provider number, produced by Centers of Medicare & Medicaid Services, a federal agency within the U.S. Department of Health and Human Services.

Nursing Homes

Source: National Institutes of Health
Telephone: 301-594-6248
Information on Medicare and Medicaid certified nursing homes in the United States.

GOVERNMENT RECORDS SEARCHED / DATA CURRENCY TRACKING

Public Schools

Source: National Center for Education Statistics

Telephone: 202-502-7300

The National Center for Education Statistics' primary database on elementary and secondary public education in the United States. It is a comprehensive, annual, national statistical database of all public elementary and secondary schools and school districts, which contains data that are comparable across all states.

Private Schools

Source: National Center for Education Statistics

Telephone: 202-502-7300

The National Center for Education Statistics' primary database on private school locations in the United States.

Flood Zone Data: This data, available in select counties across the country, was obtained by EDR in 2003 & 2011 from the Federal Emergency Management Agency (FEMA). Data depicts 100-year and 500-year flood zones as defined by FEMA.

NWI: National Wetlands Inventory. This data, available in select counties across the country, was obtained by EDR in 2002, 2005 and 2010 from the U.S. Fish and Wildlife Service.

Scanned Digital USGS 7.5' Topographic Map (DRG)

Source: United States Geologic Survey

A digital raster graphic (DRG) is a scanned image of a U.S. Geological Survey topographic map. The map images are made by scanning published paper maps on high-resolution scanners. The raster image is georeferenced and fit to the Universal Transverse Mercator (UTM) projection.

STREET AND ADDRESS INFORMATION

© 2010 Tele Atlas North America, Inc. All rights reserved. This material is proprietary and the subject of copyright protection and other intellectual property rights owned by or licensed to Tele Atlas North America, Inc. The use of this material is subject to the terms of a license agreement. You will be held liable for any unauthorized copying or disclosure of this material.

GEOCHECK®- PHYSICAL SETTING SOURCE ADDENDUM

TARGET PROPERTY ADDRESS

MIKI BASIN - 200 ACRE INDUSTRIAL SITE
MIKI ROAD & KAUMALAPAU HIGHWAY
LANAI CITY, HI 96763

TARGET PROPERTY COORDINATES

Latitude (North):	20.7904 - 20° 47' 25.44"
Longitude (West):	156.9375 - 156° 56' 15.00"
Universal Transverse Mercator:	Zone 4
UTM X (Meters):	714689.2
UTM Y (Meters):	2300187.0
Elevation:	1247 ft. above sea level

USGS TOPOGRAPHIC MAP

Target Property Map:	20156-G8 ISLAND OF LANAI OE NW, HI
Most Recent Revision:	Not reported

EDR's GeoCheck Physical Setting Source Addendum is provided to assist the environmental professional in forming an opinion about the impact of potential contaminant migration.

Assessment of the impact of contaminant migration generally has two principal investigative components:

1. Groundwater flow direction, and
2. Groundwater flow velocity.

Groundwater flow direction may be impacted by surface topography, hydrology, hydrogeology, characteristics of the soil, and nearby wells. Groundwater flow velocity is generally impacted by the nature of the geologic strata.

GEOCHECK® - PHYSICAL SETTING SOURCE SUMMARY

GROUNDWATER FLOW DIRECTION INFORMATION

Groundwater flow direction for a particular site is best determined by a qualified environmental professional using site-specific well data. If such data is not reasonably ascertainable, it may be necessary to rely on other sources of information, such as surface topographic information, hydrologic information, hydrogeologic data collected on nearby properties, and regional groundwater flow information (from deep aquifers).

TOPOGRAPHIC INFORMATION

Surface topography may be indicative of the direction of surficial groundwater flow. This information can be used to assist the environmental professional in forming an opinion about the impact of nearby contaminated properties or, should contamination exist on the target property, what downgradient sites might be impacted.

TARGET PROPERTY TOPOGRAPHY

General Topographic Gradient: General SSE

SURROUNDING TOPOGRAPHY: ELEVATION PROFILES

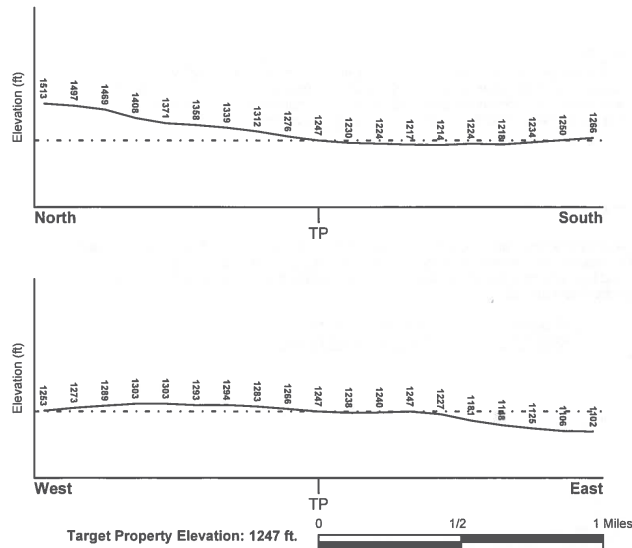

Source: Topography has been determined from the USGS 7.5' Digital Elevation Model and should be evaluated on a relative (not an absolute) basis. Relative elevation information between sites of close proximity should be field verified.

GEOCHECK® - PHYSICAL SETTING SOURCE SUMMARY

HYDROLOGIC INFORMATION

Surface water can act as a hydrologic barrier to groundwater flow. Such hydrologic information can be used to assist the environmental professional in forming an opinion about the impact of nearby contaminated properties or, should contamination exist on the target property, what downgradient sites might be impacted.

Refer to the Physical Setting Source Map following this summary for hydrologic information (major waterways and bodies of water).

FEMA FLOOD ZONE

Target Property County
MAUI, HI

FEMA Flood
Electronic Data
YES - refer to the Overview Map and Detail Map

Flood Plain Panel at Target Property:

Not Reported

Additional Panels in search area:

Not Reported

NATIONAL WETLAND INVENTORY

NWI Quad at Target Property
NOT AVAILABLE

NWI Electronic
Data Coverage
YES - refer to the Overview Map and Detail Map

HYDROGEOLOGIC INFORMATION

Hydrogeologic information obtained by installation of wells on a specific site can often be an indicator of groundwater flow direction in the immediate area. Such hydrogeologic information can be used to assist the environmental professional in forming an opinion about the impact of nearby contaminated properties or, should contamination exist on the target property, what downgradient sites might be impacted.

AQUIFLOW®

Search Radius: 1.000 Mile.

EDR has developed the AQUIFLOW Information System to provide data on the general direction of groundwater flow at specific points. EDR has reviewed reports submitted by environmental professionals to regulatory authorities at select sites and has extracted the date of the report, groundwater flow direction as determined hydrogeologically, and the depth to water table.

MAP ID
Not Reported

LOCATION
FROM TP

GENERAL DIRECTION
GROUNDWATER FLOW

GEOCHECK® - PHYSICAL SETTING SOURCE SUMMARY

GROUNDWATER FLOW VELOCITY INFORMATION

Groundwater flow velocity information for a particular site is best determined by a qualified environmental professional using site specific geologic and soil strata data. If such data are not reasonably ascertainable, it may be necessary to rely on other sources of information, including geologic age identification, rock stratigraphic unit and soil characteristics data collected on nearby properties and regional soil information. In general, contaminant plumes move more quickly through sandy-gravelly types of soils than silty-clayey types of soils.

GEOLOGIC INFORMATION IN GENERAL AREA OF TARGET PROPERTY

Geologic information can be used by the environmental professional in forming an opinion about the relative speed at which contaminant migration may be occurring.

ROCK STRATIGRAPHIC UNIT

Era: -
System: -
Series: -
Code: N/A (decoded above as Era, System & Series)

GEOLOGIC AGE IDENTIFICATION

Category: -

Geologic Age and Rock Stratigraphic Unit Source: P.G. Schruben, R.E. Arndt and W.J. Bawiec, Geology of the Conterminous U.S. at 1:2,500,000 Scale - a digital representation of the 1974 P.B. King and H.M. Beikman Map, USGS Digital Data Series DDS - 11 (1994).

SSURGO SOIL MAP - 3875991.2s

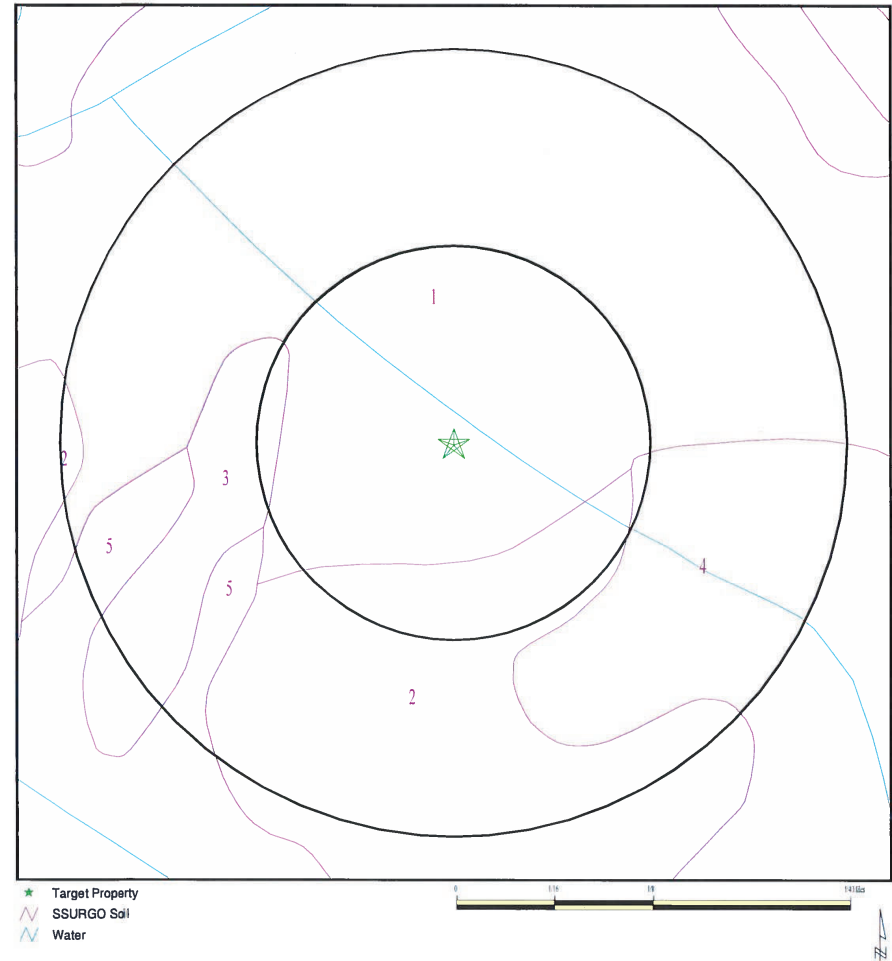

SITE NAME: Miki Basin - 200 Acre Industrial Site
ADDRESS: Miki Road & Kaunapali Highway
Lanai City HI 96763
LAT/LONG: 20.7904 / 156.9375

CLIENT: TRC
CONTACT: Ron Landolt
INQUIRY #: 3875991.2s
DATE: March 10, 2014 5:26 pm

Copyright © 2014 EOR, Inc. © 2010 Tele Atlas Rel. 07/2009.

GEOCHECK® - PHYSICAL SETTING SOURCE SUMMARY

DOMINANT SOIL COMPOSITION IN GENERAL AREA OF TARGET PROPERTY

The U.S. Department of Agriculture's (USDA) Soil Conservation Service (SCS) leads the National Cooperative Soil Survey (NCSS) and is responsible for collecting, storing, maintaining and distributing soil survey information for privately owned lands in the United States. A soil map in a soil survey is a representation of soil patterns in a landscape. The following information is based on Soil Conservation Service SSURGO data.

Soil Map ID: 1

Soil Component Name: Molokai

Soil Surface Texture: silty clay loam

Hydrologic Group: Class B - Moderate infiltration rates. Deep and moderately deep, moderately well and well drained soils with moderately coarse textures.

Soil Drainage Class: Well drained

Hydric Status: Unknown

Corrosion Potential - Uncoated Steel: Moderate

Depth to Bedrock Min: > 0 inches

Depth to Watertable Min: > 0 inches

Soil Layer Information							
Layer	Boundary		Soil Texture Class	Classification		Saturated hydraulic conductivity micro m/sec	Soil Reaction (pH)
	Upper	Lower		AASHTO Group	Unified Soil		
1	0 inches	14 inches	silty clay loam	Silt-Clay Materials (more than 35 pct. passing No. 200), Clayey Soils.	CL-K (proposed)	Max: 14 Min: 4.23	Max: 7.8 Min: 6.6
2	14 inches	72 inches	silty clay loam	Silt-Clay Materials (more than 35 pct. passing No. 200), Clayey Soils.	CL-K (proposed)	Max: 14 Min: 4.23	Max: 7.8 Min: 6.6

Soil Map ID: 2

Soil Component Name: Molokai

Soil Surface Texture: silty clay loam

Hydrologic Group: Class B - Moderate infiltration rates. Deep and moderately deep, moderately well and well drained soils with moderately coarse textures.

Soil Drainage Class: Well drained

GEOCHECK® - PHYSICAL SETTING SOURCE SUMMARY

Hydric Status: Unknown

Corrosion Potential - Uncoated Steel: Moderate

Depth to Bedrock Min: > 0 inches

Depth to Watertable Min: > 0 inches

Soil Layer Information							
Layer	Boundary		Soil Texture Class	Classification		Saturated hydraulic conductivity micro m/sec	Soil Reaction (pH)
	Upper	Lower		AASHTO Group	Unified Soil		
1	0 inches	14 inches	silty clay loam	Silt-Clay Materials (more than 35 pct. passing No. 200), Clayey Soils.	CL-K (proposed)	Max: 14 Min: 4.23	Max: 7.8 Min: 6.6
2	14 inches	72 inches	silty clay loam	Silt-Clay Materials (more than 35 pct. passing No. 200), Clayey Soils.	CL-K (proposed)	Max: 14 Min: 4.23	Max: 7.8 Min: 6.6

Soil Map ID: 3

Soil Component Name: Uwala

Soil Surface Texture: silty clay loam

Hydrologic Group: Class B - Moderate infiltration rates. Deep and moderately deep, moderately well and well drained soils with moderately coarse textures.

Soil Drainage Class: Well drained

Hydric Status: Unknown

Corrosion Potential - Uncoated Steel: High

Depth to Bedrock Min: > 0 inches

Depth to Watertable Min: > 0 inches

GEOCHECK® - PHYSICAL SETTING SOURCE SUMMARY

Soil Layer Information							
Layer	Boundary		Soil Texture Class	Classification		Saturated hydraulic conductivity micro m/sec	Soil Reaction (pH)
	Upper	Lower		AASHTO Group	Unified Soil		
1	0 inches	18 inches	silty clay loam	Silt-Clay Materials (more than 35 pct. passing No. 200), Clayey Soils.	CL-K (proposed)	Max: 14 Min: 4.23	Max: 5 Min: 4.5
2	18 inches	57 inches	silty clay loam	Silt-Clay Materials (more than 35 pct. passing No. 200), Clayey Soils.	CL-K (proposed)	Max: 14 Min: 4.23	Max: 6 Min: 5.1
3	57 inches	59 inches	silty clay loam	Silt-Clay Materials (more than 35 pct. passing No. 200), Clayey Soils.	CL-K (proposed)	Max: 14 Min: 4.23	Max: 6 Min: 5.1

Soil Map ID: 4

Soil Component Name: Waikapu

Soil Surface Texture: silty clay loam

Hydrologic Group: Class B - Moderate infiltration rates. Deep and moderately deep, moderately well and well drained soils with moderately coarse textures.

Soil Drainage Class: Well drained

Hydric Status: Unknown

Corrosion Potential - Uncoated Steel: Low

Depth to Bedrock Min: > 0 inches

Depth to Watertable Min: > 0 inches

GEOCHECK® - PHYSICAL SETTING SOURCE SUMMARY

Soil Layer Information							
Layer	Boundary		Soil Texture Class	Classification		Saturated hydraulic conductivity micro m/sec	Soil Reaction (pH)
	Upper	Lower		AASHTO Group	Unified Soil		
1	0 inches	11 inches	silty clay loam	Silt-Clay Materials (more than 35 pct. passing No. 200), Silty Soils.	CL-K (proposed)	Max: 14 Min: 4.23	Max: 7.8 Min: 6.6
2	11 inches	59 inches	silty clay loam	Silt-Clay Materials (more than 35 pct. passing No. 200), Silty Soils.	CL-K (proposed)	Max: 14 Min: 4.23	Max: 7.8 Min: 6.6

Soil Map ID: 5

Soil Component Name: Uwala

Soil Surface Texture: silty clay loam

Hydrologic Group: Class B - Moderate infiltration rates. Deep and moderately deep, moderately well and well drained soils with moderately coarse textures.

Soil Drainage Class: Well drained

Hydric Status: Unknown

Corrosion Potential - Uncoated Steel: High

Depth to Bedrock Min: > 0 inches

Depth to Watertable Min: > 0 inches

Soil Layer Information							
Layer	Boundary		Soil Texture Class	Classification		Saturated hydraulic conductivity micro m/sec	Soil Reaction (pH)
	Upper	Lower		AASHTO Group	Unified Soil		
1	0 inches	18 inches	silty clay loam	Silt-Clay Materials (more than 35 pct. passing No. 200), Clayey Soils.	CL-K (proposed)	Max: 14 Min: 4.23	Max: 5 Min: 4.5

GEOCHECK® - PHYSICAL SETTING SOURCE SUMMARY

Soil Layer Information							
Layer	Boundary		Soil Texture Class	Classification		Saturated hydraulic conductivity micro m/sec	Soil Reaction (pH)
	Upper	Lower		AASHTO Group	Unified Soil		
2	18 inches	57 inches	silty clay loam	Silt-Clay Materials (more than 35 pct. passing No. 200), Clayey Soils.	CL-K (proposed)	Max: 14 Min: 4.23	Max: 6 Min: 5.1
3	57 inches	59 inches	silty clay loam	Silt-Clay Materials (more than 35 pct. passing No. 200), Clayey Soils.	CL-K (proposed)	Max: 14 Min: 4.23	Max: 6 Min: 5.1

LOCAL / REGIONAL WATER AGENCY RECORDS

EDR Local/Regional Water Agency records provide water well information to assist the environmental professional in assessing sources that may impact ground water flow direction, and in forming an opinion about the impact of contaminant migration on nearby drinking water wells.

WELL SEARCH DISTANCE INFORMATION

<u>DATABASE</u>	<u>SEARCH DISTANCE (miles)</u>
Federal USGS	1.000
Federal FRDS PWS	Nearest PWS within 1 mile
State Database	1.000

FEDERAL USGS WELL INFORMATION

MAP ID	WELL ID	LOCATION FROM TP
No Wells Found		

FEDERAL FRDS PUBLIC WATER SUPPLY SYSTEM INFORMATION

MAP ID	WELL ID	LOCATION FROM TP
No PWS System Found		

Note: PWS System location is not always the same as well location.

GEOCHECK® - PHYSICAL SETTING SOURCE SUMMARY

STATE DATABASE WELL INFORMATION

MAP ID	WELL ID	LOCATION FROM TP
No Wells Found		

PHYSICAL SETTING SOURCE MAP - 3875991.2s

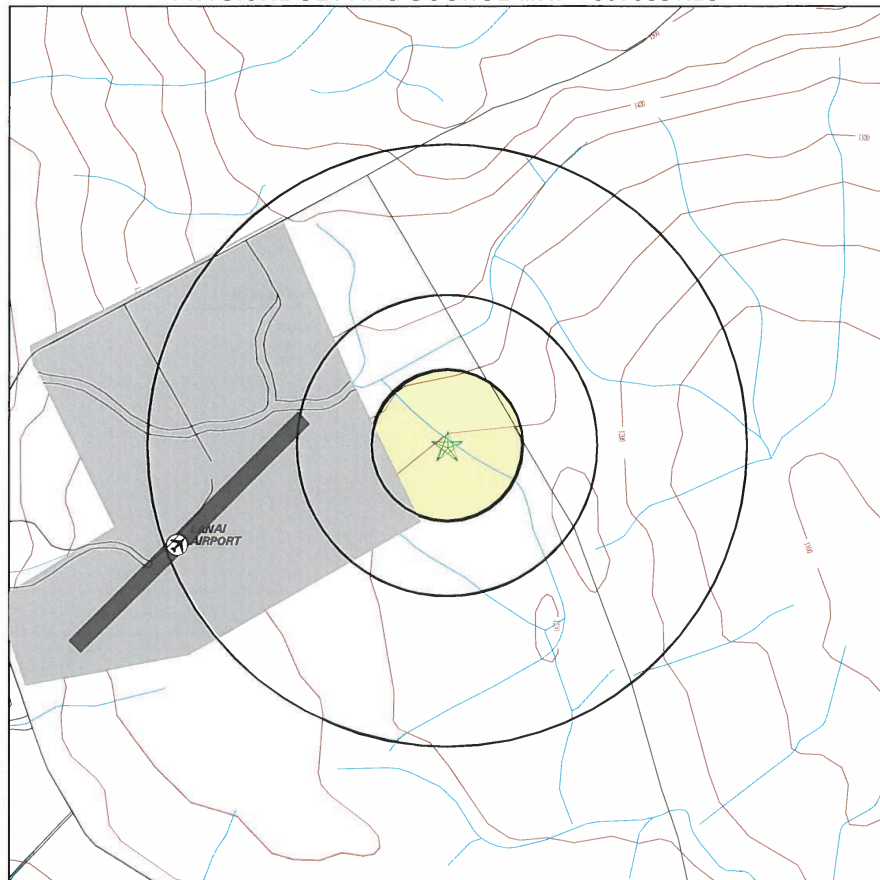

- County Boundary
- Major Roads
- Contour Lines
- Airports
- Earthquake epicenter, Richter 5 or greater
- Water Wells
- Public Water Supply Wells
- Cluster of Multiple Icons
- Groundwater Flow Direction
- Indeterminate Groundwater Flow at Location
- Groundwater Flow Varies at Location

SITE NAME: Miki Basin - 200 Acre Industrial Site
 ADDRESS: Miki Road & Kaunapali Highway
 Lanai City HI 96763
 LAT/LONG: 20.7904 / 156.9375

CLIENT: TRC
 CONTACT: Ron Landolt
 INQUIRY #: 3875991.2s
 DATE: March 10, 2014 5:26 pm

Copyright © 2014 EDR, Inc. © 2010 Tele Atlas Rel. 07/2009

GEOCHECK® - PHYSICAL SETTING SOURCE MAP FINDINGS RADON

AREA RADON INFORMATION

Federal EPA Radon Zone for MAUI County: 3

Note: Zone 1 indoor average level > 4 pCi/L.
 : Zone 2 indoor average level >= 2 pCi/L and <= 4 pCi/L.
 : Zone 3 indoor average level < 2 pCi/L.

Federal Area Radon Information for MAUI COUNTY, HI

Number of sites tested: 70

Area	Average Activity	% <4 pCi/L	% 4-20 pCi/L	% >20 pCi/L
Living Area - 1st Floor	0.057 pCi/L	100%	0%	0%
Living Area - 2nd Floor	0.000 pCi/L	100%	0%	0%
Basement	0.150 pCi/L	100%	0%	0%

PHYSICAL SETTING SOURCE RECORDS SEARCHED

TOPOGRAPHIC INFORMATION

USGS 7.5' Digital Elevation Model (DEM)

Source: United States Geologic Survey

EDR acquired the USGS 7.5' Digital Elevation Model in 2002 and updated it in 2006. The 7.5 minute DEM corresponds to the USGS 1:24,000- and 1:25,000-scale topographic quadrangle maps. The DEM provides elevation data with consistent elevation units and projection.

Scanned Digital USGS 7.5' Topographic Map (DRG)

Source: United States Geologic Survey

A digital raster graphic (DRG) is a scanned image of a U.S. Geological Survey topographic map. The map images are made by scanning published paper maps on high-resolution scanners. The raster image is georeferenced and fit to the Universal Transverse Mercator (UTM) projection.

HYDROLOGIC INFORMATION

Flood Zone Data: This data, available in select counties across the country, was obtained by EDR in 2003 & 2011 from the Federal Emergency Management Agency (FEMA). Data depicts 100-year and 500-year flood zones as defined by FEMA.

NWI: National Wetlands Inventory. This data, available in select counties across the country, was obtained by EDR in 2002, 2005 and 2010 from the U.S. Fish and Wildlife Service.

HYDROGEOLOGIC INFORMATION

AQUIFLOW^R Information System

Source: EDR proprietary database of groundwater flow information

EDR has developed the AQUIFLOW Information System (AIS) to provide data on the general direction of groundwater flow at specific points. EDR has reviewed reports submitted to regulatory authorities at select sites and has extracted the date of the report, hydrogeologically determined groundwater flow direction and depth to water table information.

GEOLOGIC INFORMATION

Geologic Age and Rock Stratigraphic Unit

Source: P.G. Schruben, R.E. Arndt and W.J. Bawiec, Geology of the Conterminous U.S. at 1:2,500,000 Scale - A digital representation of the 1974 P.B. King and H.M. Beikman Map, USGS Digital Data Series DDS - 11 (1994).

STATSGO: State Soil Geographic Database

Source: Department of Agriculture, Natural Resources Conservation Services

The U.S. Department of Agriculture's (USDA) Natural Resources Conservation Service (NRCS) leads the national Conservation Soil Survey (NCSS) and is responsible for collecting, storing, maintaining and distributing soil survey information for privately owned lands in the United States. A soil map in a soil survey is a representation of soil patterns in a landscape. Soil maps for STATSGO are compiled by generalizing more detailed (SSURGO) soil survey maps.

SSURGO: Soil Survey Geographic Database

Source: Department of Agriculture, Natural Resources Conservation Services (NRCS)

Telephone: 800-672-5559

SSURGO is the most detailed level of mapping done by the Natural Resources Conservation Services, mapping scales generally range from 1:12,000 to 1:63,360. Field mapping methods using national standards are used to construct the soil maps in the Soil Survey Geographic (SSURGO) database. SSURGO digitizing duplicates the original soil survey maps. This level of mapping is designed for use by landowners, townships and county natural resource planning and management.

PHYSICAL SETTING SOURCE RECORDS SEARCHED

LOCAL / REGIONAL WATER AGENCY RECORDS

FEDERAL WATER WELLS

PWS: Public Water Systems

Source: EPA/Office of Drinking Water

Telephone: 202-564-3750

Public Water System data from the Federal Reporting Data System. A PWS is any water system which provides water to at least 25 people for at least 60 days annually. PWSs provide water from wells, rivers and other sources.

PWS ENF: Public Water Systems Violation and Enforcement Data

Source: EPA/Office of Drinking Water

Telephone: 202-564-3750

Violation and Enforcement data for Public Water Systems from the Safe Drinking Water Information System (SDWIS) after August 1995. Prior to August 1995, the data came from the Federal Reporting Data System (FRDS).

USGS Water Wells: USGS National Water Inventory System (NWIS)

This database contains descriptive information on sites where the USGS collects or has collected data on surface water and/or groundwater. The groundwater data includes information on wells, springs, and other sources of groundwater.

STATE RECORDS

Well Index Database

Source: Commission on Water Resource Management

Telephone: 808-587-0214

CWRM maintains a Well Index Database to track specific information pertaining to the construction and installation of production wells in Hawaii

OTHER STATE DATABASE INFORMATION

RADON

Area Radon Information

Source: USGS

Telephone: 703-356-4020

The National Radon Database has been developed by the U.S. Environmental Protection Agency (USEPA) and is a compilation of the EPA/State Residential Radon Survey and the National Residential Radon Survey. The study covers the years 1986 - 1992. Where necessary data has been supplemented by information collected at private sources such as universities and research institutions.

EPA Radon Zones

Source: EPA

Telephone: 703-356-4020

Sections 307 & 309 of IRAA directed EPA to list and identify areas of U.S. with the potential for elevated indoor radon levels.

OTHER

Airport Landing Facilities: Private and public use landing facilities

Source: Federal Aviation Administration, 800-457-6656

Epicenters: World earthquake epicenters, Richter 5 or greater

Source: Department of Commerce, National Oceanic and Atmospheric Administration

Earthquake Fault Lines: The fault lines displayed on EDR's Topographic map are digitized quaternary faultlines, prepared in 1975 by the United State Geological Survey

PHYSICAL SETTING SOURCE RECORDS SEARCHED

STREET AND ADDRESS INFORMATION

© 2010 Tele Atlas North America, Inc. All rights reserved. This material is proprietary and the subject of copyright protection and other intellectual property rights owned by or licensed to Tele Atlas North America, Inc. The use of this material is subject to the terms of a license agreement. You will be held liable for any unauthorized copying or disclosure of this material.

MIKI BASIN GENERATING STATION

1001 N MIKI RD
LANAI CITY, HI 96763

Inquiry Number:
March 31, 2014

EDR Site Report™



6 Armstrong Road, 4th floor
Shelton, CT 06484
Toll Free: 800.352.0050
www.edrnet.com

TABLE OF CONTENTS

The EDR-Site Report™ is a comprehensive presentation of government filings on a facility identified in a search of federal, state and local environmental databases. The report is divided into three sections:

Section 1: Facility Summary Page 3

Summary of facility filings including a review of the following areas: waste management, waste disposal, multi-media issues, and Superfund liability.

Section 2: Facility Detail Reports Page 4

All available detailed information from databases where sites are identified.

Section 3: Databases and Update Information. Page 6

Name, source, update dates, contact phone number and description of each of the databases for this report.

Thank you for your business.
Please contact EDR at 1-800-352-0050
with any questions or comments.

Disclaimer - Copyright and Trademark Notice

This report contains information obtained from a variety of public and other sources reasonably available to Environmental Data Resources, Inc. It cannot be concluded from this Report that coverage information for the target and surrounding properties does not exist from other sources. NO WARRANTY EXPRESSED OR IMPLIED, IS MADE WHATSOEVER IN CONNECTION WITH THIS REPORT. ENVIRONMENTAL DATA RESOURCES, INC. SPECIFICALLY DISCLAIMS THE MAKING OF ANY SUCH WARRANTIES, INCLUDING WITHOUT LIMITATION, MERCHANTABILITY OR FITNESS FOR A PARTICULAR USE OR PURPOSE. ALL RISK IS ASSUMED BY THE USER. IN NO EVENT SHALL ENVIRONMENTAL DATA RESOURCES, INC. BE LIABLE TO ANYONE, WHETHER ARISING OUT OF ERRORS OR OMISSIONS, NEGLIGENCE, ACCIDENT OR ANY OTHER CAUSE, FOR ANY LOSS OR DAMAGE, INCLUDING, WITHOUT LIMITATION, SPECIAL, INCIDENTAL, CONSEQUENTIAL, OR EXEMPLARY DAMAGES. ANY LIABILITY ON THE PART OF ENVIRONMENTAL DATA RESOURCES, INC. IS STRICTLY LIMITED TO A REFUND OF THE AMOUNT PAID FOR THIS REPORT. Purchaser accepts this report "AS IS". Any analyses, estimates, ratings, or risk codes provided in this report are provided for illustrative purposes only, and are not intended to provide, nor should they be interpreted as providing any facts regarding, or prediction or forecast of, any environmental risk for any property. Only a Phase I Environmental Site Assessment performed by an environmental professional can produce information regarding the environmental risk for any property. Additionally, the information provided in this Report is not to be construed as legal advice.

Copyright 2008 by Environmental Data Resources, Inc. All rights reserved. Reproduction in any media or format, in whole or in part, of any report or map of Environmental Data Resources, Inc., or its affiliates, is prohibited without prior written permission.

EDR and its logos (including Sanborn and Sanborn Map) are trademarks of Environmental Data Resources, Inc. or its affiliates. All other trademarks used herein are the property of their respective owners.

SECTION 1: FACILITY SUMMARY

FACILITY	FACILITY 1
AREA	MIKI BASIN GENERATING STATION 1001 N MIKI RD LANAI CITY, HI 96763 EDR ID #S107769303
WASTE MANAGEMENT Facility generates hazardous waste (RCRA)	NO
Facility treats, stores, or disposes of hazardous waste on-site (RCRA/TSD)	NO
Facility has received Notices of Violations (RCRA/VIOL)	NO
Facility has been subject to RCRA administrative actions (RAATS)	NO
Facility has been subject to corrective actions (CORRACTS)	NO
Facility handles PCBs (PADS)	NO
Facility uses radioactive materials (MLTS)	NO
Facility manages registered aboveground storage tanks (AST)	NO
Facility manages registered underground storage tanks (UST)	NO
Facility has reported leaking underground storage tank incidents (LUST)	NO
Facility has reported emergency releases to the soil (ERNS)	NO
Facility has reported hazardous material incidents to DOT (HMIRS)	NO
WASTE DISPOSAL Facility is a Superfund Site (NPL)	NO
Facility has a known or suspect abandoned, inactive or uncontrolled hazardous waste site (CERCLIS)	NO
Facility has a reported Superfund Lien on it (LIENS)	NO
Facility is listed as a state hazardous waste site (SHWS)	NO
Facility has disposed of solid waste on-site (SWF/LF)	NO
MULTIMEDIA Facility uses toxic chemicals and has notified EPA under SARA Title III, Section 313 (TRIS)	NO
Facility produces pesticides and has notified EPA under Section 7 of FIFRA (SSTS)	NO
Facility manufactures or imports toxic chemicals on the TSCA list (TSCA)	NO
Facility has inspections under FIFRA, TSCA or EPCRA (FTTS)	NO
Facility is listed in EPA's index system (FINDS)	NO
Facility is listed in other database records (OTHER)	YES - p4
POTENTIAL SUPERFUND LIABILITY Facility has a list of potentially responsible parties PRP	NO
TOTAL (YES)	1

SECTION 2: FACILITY DETAIL REPORTS

MULTIMEDIA

Facility is listed in other database records

DATABASE: Other Database Records (OTHER)

MIKI BASIN GENERATING STATION
1001 N MIKI RD
LANAI CITY, HI 96763
EDR ID #S107769303

HI SPILLS:
Island: Lanai
Supplemental Loc. Text: Not reported
Case Number: 20100524-0912
HID Number: Not reported
Facility Registry Id: Not reported
Lead and Program: HEER EP&R
ER: None
Units: Diesel Generator "EMD 3"
Substances: Lube Oil
Less Or Greater Than: Not reported
Numerical Quantity: 5
Units: Gallons
Activity Type: Response
Activity Lead: Curtis Martin
Assignment End Date: 2010-05-24 00:00:00
Result: SOSOC NFA
File Under: MECO-Lanai City Generating Station

Island: Lanai
Supplemental Loc. Text: Not reported
Case Number: 20070816-1030
HID Number: Not reported
Facility Registry Id: Not reported
Lead and Program: HEER EP&R
ER: No
Units: Diesel Generating Unit 4
Substances: Engine Oil 40SAE
Less Or Greater Than: Not reported
Numerical Quantity: 5
Units: Gallons
Activity Type: Response
Activity Lead: Paul Chong
Assignment End Date: 2007-09-14 00:00:00
Result: SOSOC NFA
File Under: MECO-Lanai City Generating Station

Island: Lanai
Supplemental Loc. Text: Not reported
Case Number: 20121026-1501
HID Number: Not reported
Facility Registry Id: Not reported
Lead and Program: HEER EP&R
ER: None
Units: MECO lub oil release
Substances: Lube Oil
Less Or Greater Than: >
Numerical Quantity: 5
Units: Gallons
Activity Type: Response
Activity Lead: Curtis Martin
Assignment End Date: Not reported
Result: Not reported
File Under: Not reported

AIRS:
Facility ID: 0030-06-C
Island: Lanai
Mailing Address: P.O. Box 398
Locale: Not reported
Mailing City, ST, Zip: Kahului, HI 96732
Business Phone: Not reported
Contact Name: Michael Ribao
Contact Title: Manager, Power Supply Department
Description: Eight (8) Diesel Engine Generators This permit encompasses the following equipment: Attachment IIA: Unit Nos. Description 1-51.0 MW General Motors Electro-Motive Division (EMD) diesel engine generators (DEGs) (model no. 567-C, serial nos. 51-H-164; 54-C-141; 56-F-135; 56-G-13; 56-H-59; and 62-J-72, respectively), fired on fuel oil no. 2

SECTION 2: FACILITY DETAIL REPORTS

...Continued...

and spec used oil Attachment IIB: Unit Nos. Description 7.82-2 MW Caterpillar diesel engine generators (DEGs) (model no. 3608, serial nos. 6MC00475 and 6MC00476 respectively), fired on fuel oil no. 2 and spec used oil

SECTION 3: DATABASES AND UPDATE DATES

To maintain currency of the following federal, state and local databases, EDR contacts the appropriate government agency on a monthly or quarterly basis as required.

Elapsed ASTM days: Provides confirmation that this report meets or exceeds the 90-day updating requirement of the ASTM standard.

DATABASES FOUND IN THIS REPORT

HI SPILLS: Release Notifications

Source: Department of Health

Telephone: 808-586-4249

Releases of hazardous substances to the environment reported to the Office of Hazard Evaluation and Emergency Response since 1988.

Date of Government Version: 01/04/2014

Database Release Frequency: Varies

Date of Last EDR Contact: 02/26/2014

Date of Next Scheduled Update: 06/09/2014

HI AIRS: List of Permitted Facilities

Source: Department of Health

Telephone: 808-586-4200

A listing of permitted facilities in the state.

Date of Government Version: 01/01/2014

Database Release Frequency: Varies

Date of Last EDR Contact: 01/03/2014

Date of Next Scheduled Update: 04/21/2014

MAUI ELECTRIC CO LTD MIKI BASIN
1001 N MIKI RD
LANAI CITY, HI 96763

Inquiry Number:
March 31, 2014

EDR Site Report™



6 Armstrong Road, 4th floor
Shelton, CT 06484
Toll Free: 800.352.0050
www.edrnet.com

TABLE OF CONTENTS

The EDR-Site Report™ is a comprehensive presentation of government filings on a facility identified in a search of federal, state and local environmental databases. The report is divided into three sections:

Section 1: Facility Summary Page 3

Summary of facility filings including a review of the following areas: waste management, waste disposal, multi-media issues, and Superfund liability.

Section 2: Facility Detail Reports Page 4

All available detailed information from databases where sites are identified.

Section 3: Databases and Update Information. Page 6

Name, source, update dates, contact phone number and description of each of the databases for this report.

Thank you for your business.
Please contact EDR at 1-800-352-0050
with any questions or comments.

SECTION 1: FACILITY SUMMARY

FACILITY	FACILITY 1
AREA	MAUI ELECTRIC CO LTD MIKI BASIN POWER PL 1001 N MIKI RD LANAI CITY, HI 96763 EDR ID #S113183480
WASTE MANAGEMENT Facility generates hazardous waste (RCRA)	NO
Facility treats, stores, or disposes of hazardous waste on-site (RCRA/TSDF)	NO
Facility has received Notices of Violations (RCRA/VIOL)	NO
Facility has been subject to RCRA administrative actions (RAATS)	NO
Facility has been subject to corrective actions (CORRACTS)	NO
Facility handles PCBs (PADS)	NO
Facility uses radioactive materials (MLTS)	NO
Facility manages registered aboveground storage tanks (AST)	NO
Facility manages registered underground storage tanks (UST)	NO
Facility has reported leaking underground storage tank incidents (LUST)	NO
Facility has reported emergency releases to the soil (ERNS)	NO
Facility has reported hazardous material incidents to DOT (HMIRS)	NO
WASTE DISPOSAL Facility is a Superfund Site (NPL)	NO
Facility has a known or suspect abandoned, inactive or uncontrolled hazardous waste site (CERCLIS)	NO
Facility has a reported Superfund Lien on it (LIENS)	NO
Facility is listed as a state hazardous waste site (SHWS)	NO
Facility has disposed of solid waste on-site (SWF/LF)	NO
MULTIMEDIA Facility uses toxic chemicals and has notified EPA under SARA Title III, Section 313 (TRIS)	NO
Facility produces pesticides and has notified EPA under Section 7 of FIFRA (SSTS)	NO
Facility manufactures or imports toxic chemicals on the TSCA list (TSCA)	NO
Facility has inspections under FIFRA, TSCA or EPCRA (FTTS)	NO
Facility is listed in EPA's index system (FINDS)	NO
Facility is listed in other database records (OTHER)	YES - p4
POTENTIAL SUPERFUND LIABILITY Facility has a list of potentially responsible parties PRP	NO
TOTAL (YES)	1

Disclaimer - Copyright and Trademark Notice

This report contains information obtained from a variety of public and other sources reasonably available to Environmental Data Resources, Inc. It cannot be concluded from this Report that coverage information for the target and surrounding properties does not exist from other sources. NO WARRANTY EXPRESSED OR IMPLIED, IS MADE WHATSOEVER IN CONNECTION WITH THIS REPORT. ENVIRONMENTAL DATA RESOURCES, INC. SPECIFICALLY DISCLAIMS THE MAKING OF ANY SUCH WARRANTIES, INCLUDING WITHOUT LIMITATION, MERCHANTABILITY OR FITNESS FOR A PARTICULAR USE OR PURPOSE. ALL RISK IS ASSUMED BY THE USER. IN NO EVENT SHALL ENVIRONMENTAL DATA RESOURCES, INC. BE LIABLE TO ANYONE, WHETHER ARISING OUT OF ERRORS OR OMISSIONS, NEGLIGENCE, ACCIDENT OR ANY OTHER CAUSE, FOR ANY LOSS OR DAMAGE, INCLUDING, WITHOUT LIMITATION, SPECIAL, INCIDENTAL, CONSEQUENTIAL, OR EXEMPLARY DAMAGES. ANY LIABILITY ON THE PART OF ENVIRONMENTAL DATA RESOURCES, INC. IS STRICTLY LIMITED TO A REFUND OF THE AMOUNT PAID FOR THIS REPORT. Purchaser accepts this report "AS IS". Any analyses, estimates, ratings, or risk codes provided in this report are provided for illustrative purposes only, and are not intended to provide, nor should they be interpreted as providing any facts regarding, or prediction or forecast of, any environmental risk for any property. Only a Phase I Environmental Site Assessment performed by an environmental professional can produce information regarding the environmental risk for any property. Additionally, the information provided in this Report is not to be construed as legal advice.

Copyright 2008 by Environmental Data Resources, Inc. All rights reserved. Reproduction in any media or format, in whole or in part, of any report or map of Environmental Data Resources, Inc., or its affiliates, is prohibited without prior written permission.

EDR and its logos (including Sanborn and Sanborn Map) are trademarks of Environmental Data Resources, Inc. or its affiliates. All other trademarks used herein are the property of their respective owners.

SECTION 2: FACILITY DETAIL REPORTS

MULTIMEDIA

Facility is listed in other database records

DATABASE: Other Database Records (OTHER)

MAUI ELECTRIC CO LTD MIKI BASIN POWER PL
1001 N MIKI RD
LANAI CITY, HI 96763
EDR ID #S113183480

HAZNET:
Year: 2003
Gepaid: HIR000000141
Contact: ED OYAMA
Telephone: 8085656453
Mailing Name: Not reported
Mailing Address: 1001 N MIKI RD
Mailing City,St,Zip: LANAI CITY, HI 96763
Gen County: Not reported
TSD EPA ID: CAT000646117
TSD County: Not reported
Waste Category: Polychlorinated biphenyls and material containing PCBs
Disposal Method: Transfer Station
Tons: 0.35
Facility County: 99

Year: 2003
Gepaid: HIR000000141
Contact: ED OYAMA
Telephone: 8085656453
Mailing Name: Not reported
Mailing Address: 1001 N MIKI RD
Mailing City,St,Zip: LANAI CITY, HI 96763
Gen County: Not reported
TSD EPA ID: CAT000646117
TSD County: Not reported
Waste Category: Polychlorinated biphenyls and material containing PCBs
Disposal Method: Disposal, Land Fill
Tons: 0.25
Facility County: 99

Year: 2003
Gepaid: HIR000000141
Contact: ED OYAMA
Telephone: 8085656453
Mailing Name: Not reported
Mailing Address: 1001 N MIKI RD
Mailing City,St,Zip: LANAI CITY, HI 96763
Gen County: Not reported
TSD EPA ID: CAT000646117
TSD County: Not reported
Waste Category: Liquids with polychlorinated biphenyls >= 50 Mg/L
Disposal Method: Transfer Station
Tons: 0.14
Facility County: 99

Year: 2002
Gepaid: HIR000000141
Contact: ED OYAMA
Telephone: 8085656453
Mailing Name: Not reported
Mailing Address: 1001 N MIKI RD
Mailing City,St,Zip: LANAI CITY, HI 96763
Gen County: Not reported
TSD EPA ID: CAT000646117
TSD County: Not reported
Waste Category: Polychlorinated biphenyls and material containing PCBs
Disposal Method: Transfer Station
Tons: 2.45
Facility County: 99

Year: 2002
Gepaid: HIR000000141
Contact: ED OYAMA
Telephone: 8085656453
Mailing Name: Not reported
Mailing Address: 1001 N MIKI RD
Mailing City,St,Zip: LANAI CITY, HI 96763
Gen County: Not reported
TSD EPA ID: CAT000646117

SECTION 2: FACILITY DETAIL REPORTS

...Continued...

TSD County: Not reported
Waste Category: Polychlorinated biphenyls and material containing PCBs
Disposal Method: Disposal, Land Fill
Tons: 4.11
Facility County: 99

Year: 2001
Gepaid: HIR000000141
Contact: ED OYAMA
Telephone: 8085656453
Mailing Name: Not reported
Mailing Address: 1001 N MIKI RD
Mailing City,St,Zip: LANAI CITY, HI 96763
Gen County: Not reported
TSD EPA ID: CAT000646117
TSD County: Not reported
Waste Category: Polychlorinated biphenyls and material containing PCBs
Disposal Method: Transfer Station
Tons: 0.15
Facility County: 99

Year: 2001
Gepaid: HIR000000141
Contact: ED OYAMA
Telephone: 8085656453
Mailing Name: Not reported
Mailing Address: 1001 N MIKI RD
Mailing City,St,Zip: LANAI CITY, HI 96763
Gen County: Not reported
TSD EPA ID: CAT000646117
TSD County: Not reported
Waste Category: Polychlorinated biphenyls and material containing PCBs
Disposal Method: Disposal, Land Fill
Tons: 0.07
Facility County: 99

Year: 2000
Gepaid: HIR000000141
Contact: ED OYAMA
Telephone: 8085656453
Mailing Name: Not reported
Mailing Address: 1001 N MIKI RD
Mailing City,St,Zip: LANAI CITY, HI 96763
Gen County: Not reported
TSD EPA ID: CAT000646117
TSD County: Not reported
Waste Category: Polychlorinated biphenyls and material containing PCBs
Disposal Method: Transfer Station
Tons: 0.77
Facility County: 99

Year: 2000
Gepaid: HIR000000141
Contact: ED OYAMA
Telephone: 8085656453
Mailing Name: Not reported
Mailing Address: 1001 N MIKI RD
Mailing City,St,Zip: LANAI CITY, HI 96763
Gen County: Not reported
TSD EPA ID: CAT000646117
TSD County: Not reported
Waste Category: Polychlorinated biphenyls and material containing PCBs
Disposal Method: Disposal, Land Fill
Tons: 0.15
Facility County: 99

SECTION 3: DATABASES AND UPDATE DATES

To maintain currency of the following federal, state and local databases, EDR contacts the appropriate government agency on a monthly or quarterly basis as required.

Elapsed ASTM days: Provides confirmation that this report meets or exceeds the 90-day updating requirement of the ASTM standard.

DATABASES FOUND IN THIS REPORT

CA HAZNET: Facility and Manifest Data

Source: California Environmental Protection Agency
Telephone: 916-255-1136

Facility and Manifest Data. The data is extracted from the copies of hazardous waste manifests received each year by the DTSC. The annual volume of manifests is typically 700,000 - 1,000,000 annually, representing approximately 350,000 - 500,000 shipments. Data are from the manifests submitted without correction, and therefore many contain some invalid values for data elements such as generator ID, TSD ID, waste category, and disposal method.

Date of Government Version: 12/31/2012
Database Release Frequency: Annually

Date of Last EDR Contact: 01/17/2014
Date of Next Scheduled Update: 04/28/2014

MIKI BASIN GENERATING STATION
1001 NORTH MIKI RD.
LANAI CITY, HI 96763

Inquiry Number:
March 31, 2014

EDR Site Report™



6 Armstrong Road, 4th floor
Shelton, CT 06484
Toll Free: 800.352.0050
www.edrnet.com

TABLE OF CONTENTS

The EDR-Site Report™ is a comprehensive presentation of government filings on a facility identified in a search of federal, state and local environmental databases. The report is divided into three sections:

Section 1: Facility Summary Page 3

Summary of facility filings including a review of the following areas: waste management, waste disposal, multi-media issues, and Superfund liability.

Section 2: Facility Detail Reports Page 4

All available detailed information from databases where sites are identified.

Section 3: Databases and Update Information Page 7

Name, source, update dates, contact phone number and description of each of the databases for this report.

Thank you for your business.
Please contact EDR at 1-800-352-0050
with any questions or comments.

Disclaimer - Copyright and Trademark Notice

This report contains information obtained from a variety of public and other sources reasonably available to Environmental Data Resources, Inc. It cannot be concluded from this Report that coverage information for the target and surrounding properties does not exist from other sources. NO WARRANTY EXPRESSED OR IMPLIED, IS MADE WHATSOEVER IN CONNECTION WITH THIS REPORT. ENVIRONMENTAL DATA RESOURCES, INC. SPECIFICALLY DISCLAIMS THE MAKING OF ANY SUCH WARRANTIES, INCLUDING WITHOUT LIMITATION, MERCHANTABILITY OR FITNESS FOR A PARTICULAR USE OR PURPOSE. ALL RISK IS ASSUMED BY THE USER. IN NO EVENT SHALL ENVIRONMENTAL DATA RESOURCES, INC. BE LIABLE TO ANYONE, WHETHER ARISING OUT OF ERRORS OR OMISSIONS, NEGLIGENCE, ACCIDENT OR ANY OTHER CAUSE, FOR ANY LOSS OR DAMAGE, INCLUDING, WITHOUT LIMITATION, SPECIAL, INCIDENTAL, CONSEQUENTIAL, OR EXEMPLARY DAMAGES. ANY LIABILITY ON THE PART OF ENVIRONMENTAL DATA RESOURCES, INC. IS STRICTLY LIMITED TO A REFUND OF THE AMOUNT PAID FOR THIS REPORT. Purchaser accepts this report "AS IS". Any analyses, estimates, ratings, or risk codes provided in this report are provided for illustrative purposes only, and are not intended to provide, nor should they be interpreted as providing any facts regarding, or prediction or forecast of, any environmental risk for any property. Only a Phase I Environmental Site Assessment performed by an environmental professional can produce information regarding the environmental risk for any property. Additionally, the information provided in this Report is not to be construed as legal advice.

Copyright 2008 by Environmental Data Resources, Inc. All rights reserved. Reproduction in any media or format, in whole or in part, of any report or map of Environmental Data Resources, Inc., or its affiliates, is prohibited without prior written permission.

EDR and its logos (including Sanborn and Sanborn Map) are trademarks of Environmental Data Resources, Inc. or its affiliates. All other trademarks used herein are the property of their respective owners.

SECTION 1: FACILITY SUMMARY

FACILITY	FACILITY 1
AREA	MIKI BASIN GENERATING STATION 1001 NORTH MIKI RD. LANAI CITY, HI 96763 EDR ID #1007092130 EPA #H1R000000141
WASTE MANAGEMENT	
Facility generates hazardous waste (RCRA)	YES - p4
Facility treats, stores, or disposes of hazardous waste on-site (RCRA/TSD)	NO
Facility has received Notices of Violations (RCRA/VIOL)	NO
Facility has been subject to RCRA administrative actions (RAATS)	NO
Facility has been subject to corrective actions (CORRACTS)	NO
Facility handles PCBs (PADS)	YES - p6
Facility uses radioactive materials (MLTS)	NO
Facility manages registered aboveground storage tanks (AST)	NO
Facility manages registered underground storage tanks (UST)	NO
Facility has reported leaking underground storage tank incidents (LUST)	NO
Facility has reported emergency releases to the soil (ERNS)	NO
Facility has reported hazardous material incidents to DOT (HMIRS)	NO
WASTE DISPOSAL	
Facility is a Superfund Site (NPL)	NO
Facility has a known or suspect abandoned, inactive or uncontrolled hazardous waste site (CERCLIS)	NO
Facility has a reported Superfund Lien on it (LIENS)	NO
Facility is listed as a state hazardous waste site (SHWS)	NO
Facility has disposed of solid waste on-site (SWF/LF)	NO
MULTIMEDIA	
Facility uses toxic chemicals and has notified EPA under SARA Title III, Section 313 (TRIS)	NO
Facility produces pesticides and has notified EPA under Section 7 of FIFRA (SSTS)	NO
Facility manufactures or imports toxic chemicals on the TSCA list (TSCA)	NO
Facility has inspections under FIFRA, TSCA or EPCRA (FTTS)	NO
Facility is listed in EPA's index system (FINDS)	NO
Facility is listed in other database records (OTHER)	NO
POTENTIAL SUPERFUND LIABILITY	
Facility has a list of potentially responsible parties PRP	NO
TOTAL (YES)	2