



COUNTY OF MAUI
DEPARTMENT OF PUBLIC WORKS
DEVELOPMENT SERVICES ADMINISTRATION
250 SOUTH HIGH STREET
WAILUKU, MAUI, HAWAII 96793

September 30, 2018

Mr. Dominic M. Crosariol, P.E.
DMC ENGINEERING
2138 W. Vineyard Street
Wailuku, Hawaii 96793

SUBJECT: SEPARATE LOT DETERMINATION
TMK: (2) 3-4-032:001

Dear Mr. Crosariol:

This is in reply to the documents we received from April 24, 2018, through September 5, 2018, requesting a separate lot determination for the subject tax map key parcel.

We reviewed the documents submitted and researched our subdivision records and real property tax records.

Based upon our review of the aforementioned information, we recognize forty-five (45) separate lots within TMK: (2) 3-4-032:001. For illustration purposes only, enclosed is a copy of a tax map, not to scale, approximately depicting the following 45 lots:

- LOT 1:** Portion of Land Commission Award No. 436, Apana 1 to Kapau
- LOT 2:** Portion of Land Commission Award No. 9032, Apana 4 to Kikane
- LOT 3:** Portion of Royal Patent Grant 3343 to Claus Spreckels
- LOT 4:** Portion of Land Commission Award No. 406, Apana 4
- LOT 5:** Portion of Land Commission Award No. 3466 & 3473, to Kaiaie
- LOT 6:** Land Commission Award No. 3290, Apana 4 to Mahoe 2
- LOT 7:** Land Commission Award No. 3487, Apana 1 to Kaulii

Mr. Dominic M. Crosariol, P.E.

SUBJECT: SEPARATE LOT DETERMINATION

TMK: (2) 3-4-032:001

September 30, 2018

Page 2 of 4

- LOT 8:** Portion of Land Commission Award No. 3261, Apana 1 to Leoiki
- LOT 9:** Portion of Poalima 91 as described as Parcel "B" in the indenture dated September 12, 1950, between Wailuku Sugar Company and Hymie and Mary Meyer recorded in Liber 2435, Page 320 of approximately 6,727 square feet.
- LOT 10:** Portion of Poalima
- LOT 11:** Portion of Land Commission Award No. 3254, Apana 1 to Hana I
- LOT 12:** Land Commission Award No. 3261, Apana 2 to Leoiki
- LOT 13:** Land Commission Award No. 3487, Apana 2 to Kaulii
- LOT 14:** Land Commission Award No. 3290, Apana 2 to Mahoe 2
- LOT 15:** Portion of Land Commission Award No. 3385, Apana 1 to Pahoa remaining after the exchange deed dated October 20, 1945, between Wailuku Sugar Company and Samuel and Rose Kalawaia recorded in Book 1918, Page 40
- LOT 16:** Portion of Land Commission Award No. 3385, Apana 1 to Pahoa of the exchange deed dated October 20, 1945, between Wailuku Sugar Company and Samuel and Rose Kalawaia recorded in Book 1918, Page 40.
- LOT 17:** Poalima
- LOT 18:** Land Commission Award No. 3290, Apana 3 to Mahoe 2
- LOT 19:** Land Commission Award No. 4452, Apana 7 to H. Kalama
- LOT 20:** Poalima
- LOT 21:** Land Commission Award No. 3465 to Keawe
- LOT 22:** Portion of Land Commission Award No. 3477 to Kekoona
- LOT 23:** Portion of Poalima
- LOT 24:** Portion of Poalima

Mr. Dominic M. Crosariol, P.E.

SUBJECT: SEPARATE LOT DETERMINATION

TMK: (2) 3-4-032:001

September 30, 2018

Page 3 of 4

- LOT 25:** Land Commission Award No. 3475, Apana 4 to Koanaole
 - LOT 26:** Land Commission Award No. 3389, Apana 1 to Pinao
 - LOT 27:** Land Commission Award No. 7742, Apana 5 to Kahale
 - LOT 28:** Poalima
 - LOT 29:** Land Commission Award No. 3217C to Kamaka
 - LOT 30:** Poalima
 - LOT 31:** Poalima
 - LOT 32:** Poalima
 - LOT 33:** Land Commission Award No. 3475, Apana 5 to Koanaole
 - LOT 34:** Portion of Land Commission Award No. 3477 to Kekoona
 - LOT 35:** Poalima
 - LOT 36:** Portion of Land Commission Award No. 3381 to Puniho
 - LOT 37:** Poalima
 - LOT 38:** Land Commission Award No. 3385, Apana 2 to Pahoa
 - LOT 39:** Portion of Royal Patent Grant 3343 to Claus Spreckels
 - LOT 40:** Portion of Land Commission Award No. 3492 to Kanalulu
 - LOT 41:** Land Commission Award No. 3380, Apana 3 to Popoki
 - LOT 42:** Land Commission Award No. 3380, Apana 4 to Popoki
 - LOT 43:** Poalima
 - LOT 44:** Land Commission Award No. 3257B, Apana 3 to Ehu
 - LOT 45:** Land Commission Award No. 3467 to Kenoi
-

Mr. Dominic M. Crosariol, P.E.
SUBJECT: SEPARATE LOT DETERMINATION
TMK: (2) 3-4-032:001

September 30, 2018
Page 4 of 4

Please be advised that our review of this matter was limited to a separate lot determination for TMK: (2) 3-4-032:001. We did not make any determinations or validate any information regarding legal access, ownership, metes and bounds, lot area, legality of existing structures, and building setbacks.

A request for additional tax map key parcel numbers may be made with the Tax Map Section of the Real Property Tax Division, Department of Finance. If you have any questions, please contact the Tax Maps Section at 270-7297.

If you have any questions regarding this letter, please call Ms. Lesli Otani of our Development Services Administration at 270-7252.

Sincerely,



DAVID C. GOODE
Director of Public Works

LL0 S:\DSA\Engr\LL0\Separate Lot Determinations\234032001.docx

Enclosure

- c: Tax Map Section w/enclosure
- Engineering Division w/enclosure

39 During term of
 (Catherine Lane & ref. Inmate
 Margaret Lane & ref. Inmate
 William P. O'Connell - 1945
 - 1946

44 During term of
 (Catherine Lane & ref. Inmate
 Margaret Lane & ref. Inmate
 William P. O'Connell - 1945
 - 1946

45 During term of
 (Catherine Lane & ref. Inmate
 Margaret Lane & ref. Inmate
 William P. O'Connell - 1945
 - 1946

46 During term of
 (Catherine Lane & ref. Inmate
 Margaret Lane & ref. Inmate
 William P. O'Connell - 1945
 - 1946

ZONE 3
 SEC. 3
 PLAT 31

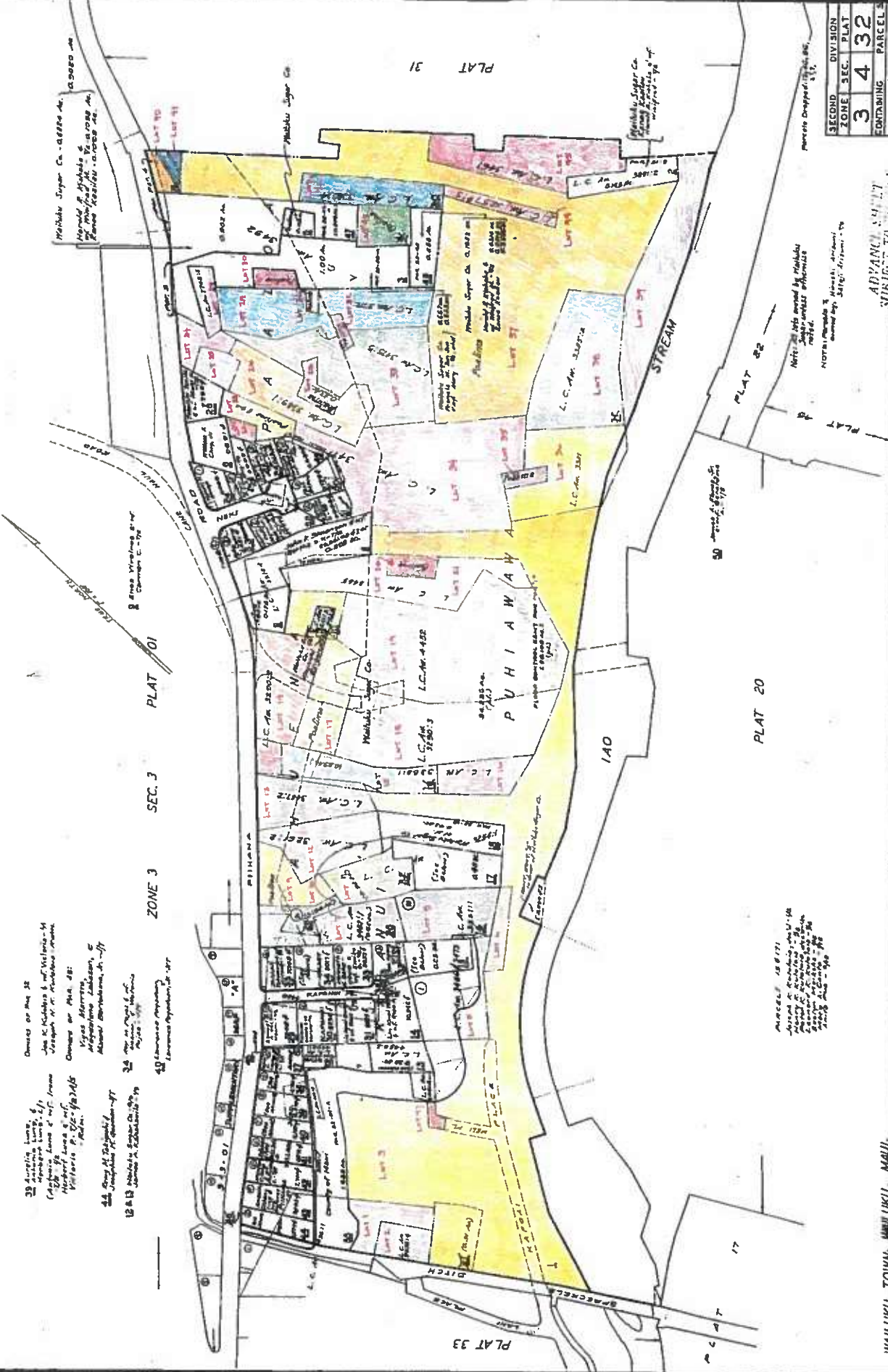

SECOND DIVISION	3
ZONE SEC. PLAT	3 4 32
CONTAINING PARCELS	
SCALE: 1" = 100' X	

NOTES: This plat is subject to the same conditions as the original plat.
 NOTES: This plat is subject to the same conditions as the original plat.

ADVANCED 1947
 SUBJECT TO C.C. 106

HAILUKU TOWN, HAILUKU, MAUI.

DWR: Mr. LANG
 Dg: L.R.H. - B. 1955
 Survey: Dr. Kaya Dwyer