

- LEGEND**
- PROPERTY LINE
 - ADJACENT PROPERTY LINE
 - - - EXISTING EASEMENT
 - - - FENCE LINE
 - - - EXISTING DRIVEWAY (AC, ROCK, DIRT)
 - - - DRIVEWAY
 - ▨ SOLAR RACK

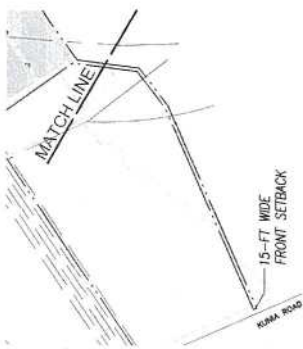
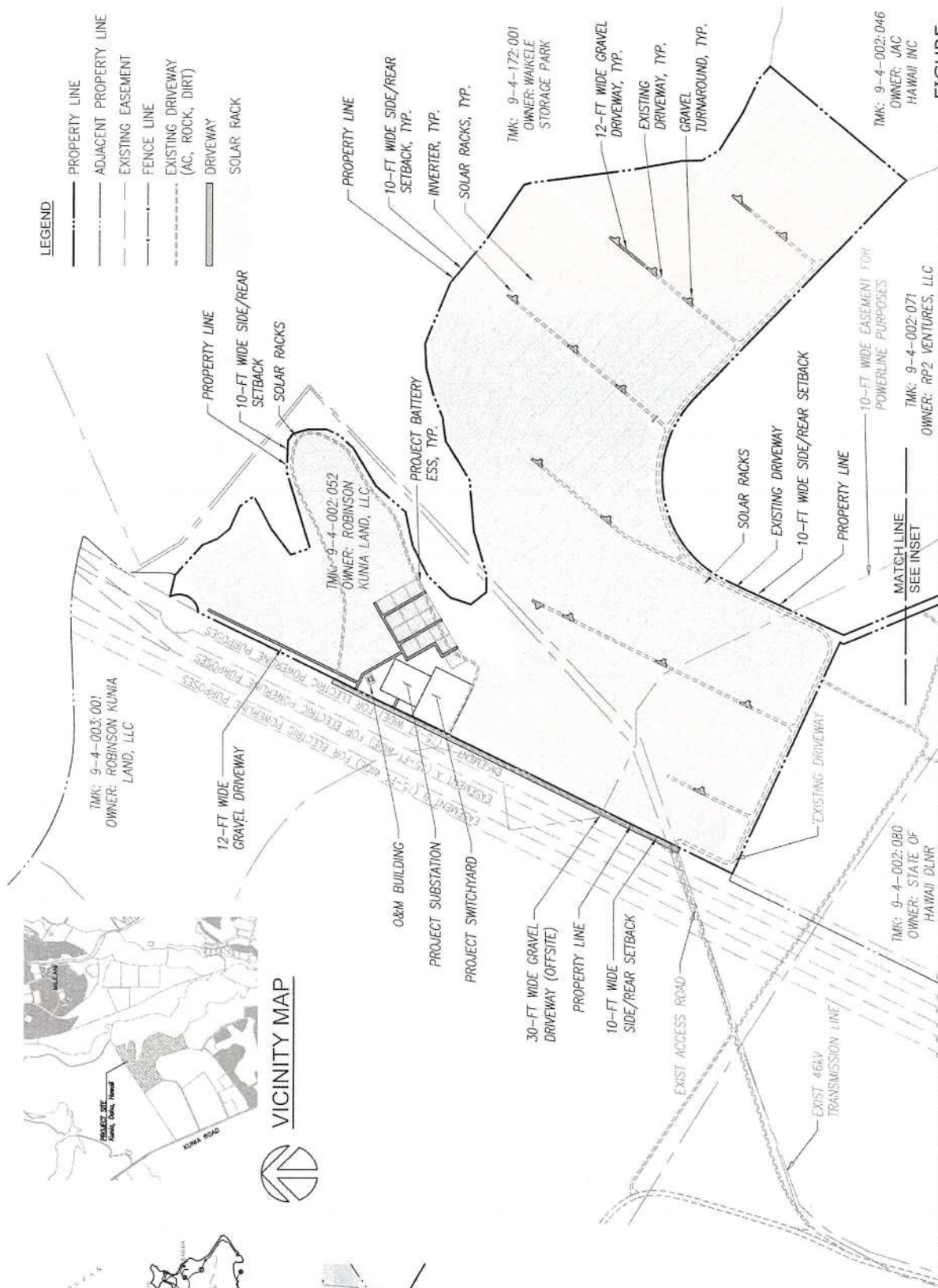

FIGURE 1

OVERALL SITE PLAN

SCALE: 1" = 500'

0 500 1000

TMK: 9-4-002:046
OWNER: JAC HAWAII INC

TMK: 9-4-172:001
OWNER: WAIKELE STORAGE PARK

TMK: 9-4-002:052
OWNER: ROBINSON KUNIA LAND, LLC

TMK: 9-4-002:080
OWNER: STATE OF HAWAII DLNR

TMK: 9-4-002:071
OWNER: RP2 VENTURES, LLC

MATCHLINE SEE INSET

1155 KUMU STREET, SUITE 100
HONOLULU, HAWAII 96813
WWW.G70.COM

HOOHANA SOLAR FARM
CONDITIONAL USE PERMIT