

TRUE NORTH
SCALE: 1 in. = 200ft.

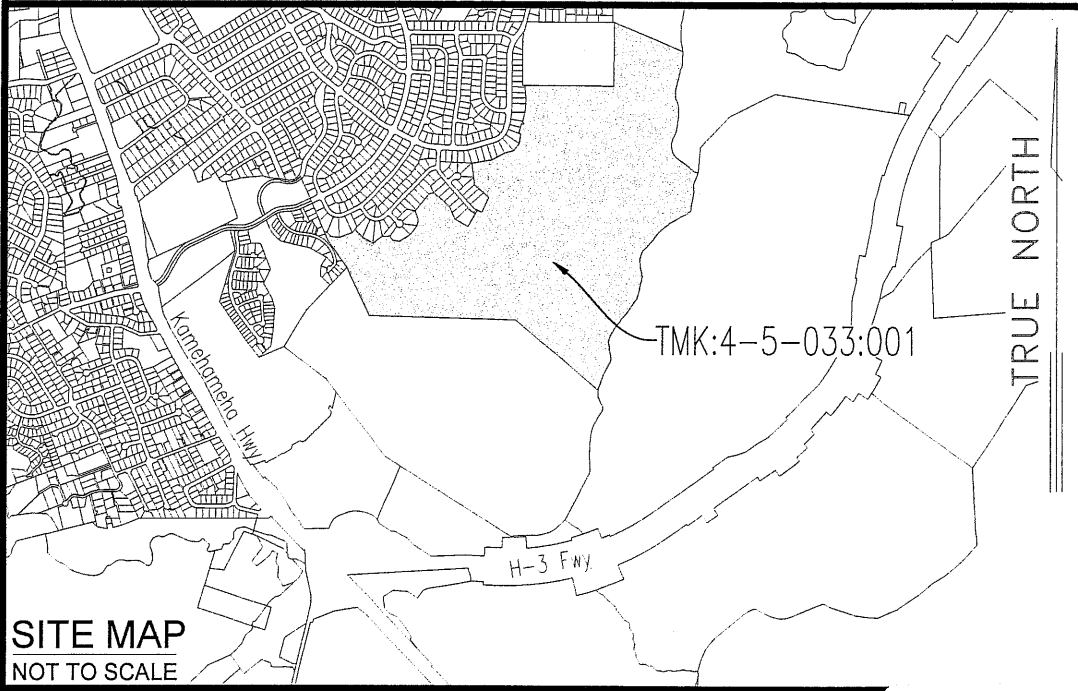

STATE LAND USE URBAN BOUNDARY AFFECTING LOT 1

BEING A PORTION OF ROYAL PATENT 7984,
LAND COMMISSION AWARD 4452, APANA 13 TO H. KALAMA
SITUATE AT KALOKOAI, KAWAEWAE AND HOPENUI
AT KANEOHE, KOOLAUPOKO, ISLAND OF OAHU, HAWAII

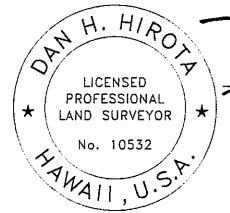

D. Hirota
DAN H. HIROTA
Licensed Professional Land Surveyor
Certificate No. 10532
EXP. 4/30/2018

All azimuths and record coordinates, refers to
Government Survey Triangulation Station "KAILUA" Δ.

OWNER: JAY MORFORD
HAWAIIAN MEMORIAL LIFE PLAN LIMITED
ADDRESS: 45-425 KAMEHAMEHA HWY
KANEOHE, HI 96744

FILE PATH/NAME: X:\PROJECTS\HMF\HMP\DWG\171020_LUC_BOUND\HMP-LUC-REV3.DWG

TMK: 1st Div. 4-5-033:001
OCTOBER 26, 2017

Job No. # 171130
21 in. x 15 in.

EXHIBIT "2"

SAM O. HIROTA, INC.
864 S. Beretania St.
Honolulu, HI 96813

DESCRIPTION

**PARCEL 1
(CONSERVATION TO URBAN)**

Land Situate at Kalokoai, Kawaewae and Hopenui, Kaneohe, Koolaulupoko, Island of Oahu, Hawaii.

Being a portion of Royal Patent 7984, Land Commission Award 4452, Apana 13 to H. Kalama.

Beginning at the Nothwest corner of this parcel of land, the azimuth and distance to the Southeast corner of Lot 140 of Pikoiloa Tract Unit 10 (File Plan 884) being 269°27'50" 22.31 feet, the coordinates of said point of beginning referred to Government Survey Triangulation Station "KAILUA" being 4,046.18 feet North and 4,801.25 feet West thence running by azimuths measured clockwise from true South:

1.	269°	27'	50"	22.31	feet along Lot 140 of Pikoiloa Tract Unit 10 (File Plan 884);
2.	324°	30'		56.14	feet along Lot 139 of Pikoiloa Tract Unit 10 (File Plan 884);
3.	279°	00'		80.00	feet along the same;
4.	237°	30'		138.00	feet along the same;
5.	217°	30'		122.00	feet along Lot 138 of Pikoiloa Tract Unit 10 (File Plan 884);
6.	194°	00'		63.07	feet along Lot 137 of Pikoiloa Tract Unit 10 (File Plan 884);
7.	159°	00'		105.00	feet along the same;
8.	219°	45'		245.68	feet along Lots 133, 132, 131 and 130 of Pikoiloa Tract Unit 10 (File Plan 884);
9.	254°	20'	30"	58.00	feet along Lot 129 of Pikoiloa Tract Unit 10 (File Plan 884);
10.	310°	56'		231.95	feet along Lots 125, 124 and 123 of Pikoiloa Tract Unit 10 (File Plan 884);
11.	335°	46'		157.19	feet along Lots 122 and 121 of Pikoiloa Tract Unit 10 (File Plan 884);
12.	299°	58'		160.03	feet along Lot 120 of Pikoiloa Tract Unit 10 (File Plan 884);
13.	209°	58'		203.08	feet along Lots 120 and F of Pikoiloa Tract Unit 10 (File Plan 884);

Thence along Lot 119 of Pikoiloa Tract Unit 10 (File Plan 884), on a curve to the left with a radius of 278.00 feet, the chord azimuth and distance being:

- 14. 297° 23' 30" 24.98 feet;
- 15. 294° 49' 30.00 feet along Lot 119 of Pikoiloa Tract Unit 10 (File Plan 884);
- 16. 204° 49' 185.00 feet along the same;
- 17. 131° 34' 30" 193.31 feet along Lots 119, 118 and 117 of Pikoiloa Tract Unit 10 (File Plan 884);
- 18. 247° 00' 373.38 feet along the remainder of R.P. 7984, L.C. Aw. 4452, Ap. 13 to H. Kalama;

Thence along the same, on a curve to the right with a radius of 100.00 feet, the chord azimuth and distance being:

- 19. 294° 30' 147.46 feet;
- 20. 342° 00' 101.96 feet along the remainder of R.P. 7984, L.C. Aw. 4452, Ap. 13 to H. Kalama;
- 21. 309° 30' 138.05 feet along the same;
- 22. 241° 44' 224.91 feet along the same;
- 23. 269° 20' 978.75 feet along the same;

Thence along the same on a curve to the right with a radius of 100.00 feet, the chord azimuth and distance being:

- 24. 317° 04' 148.00 feet;
- 25. 4° 48' 326.13 feet along the remainder of R.P. 7984, L.C. Aw. 4452, Ap. 13 to H. Kalama;

Thence along the same on a curve to the right with a radius of 50.00 feet, the chord azimuth and distance being:

- 26. 51° 24' 72.66 feet;
- 27. 98° 00' 473.73 feet along the remainder of R.P. 7984, L.C. Aw. 4452, Ap. 13 to H. Kalama;
- 28. 10° 30' 325.45 feet along the same;

Thence along the same on a curve to the right with a radius of 300.00 feet, the chord azimuth and distance being:

- 29. 36° 00' 258.31 feet;
- 30. 61° 30' 153.02 feet along the remainder of R.P. 7984, L.C. Aw. 4452, Ap. 13 to H. Kalama;
- 31. 116° 30' 271.67 feet along the same;
- 32. 120° 30' 336.65 feet along the same;

Thence along the same on a curve to the left with a radius of 50.00 feet, the chord azimuth and distance being:

- 33. 74° 10' 72.34 feet;
- 34. 27° 50' 344.24 feet along the remainder of R.P. 7984, L.C. Aw. 4452, Ap. 13 to H. Kalama;
- 35. 60° 00' 241.22 feet along the same;
- 36. 20° 25' 179.34 feet along the same;
- 37. 106° 00' 238.26 feet along the same;
- 38. 69° 00' 335.69 feet along the same;

Thence along the same on a curve to the right with a radius of 788.00 feet, the chord azimuth and distance being:

- 39. 139° 34' 15" 561.30 feet;
- 40. 160° 26' 06" 99.34 feet along the remainder of R.P. 7984, L.C. Aw. 4452, Ap. 13 to H. Kalama;

Thence along the same on a curve to the right with a radius of 683.00 feet, the chord azimuth and distance being:

- 41. 180° 29' 12" 301.90 feet to the point of beginning and containing an area of 53.449 Acs.



Description Prepared By:

Dan H. Hirota
Licensed Professional Land Surveyor
Certificate No. 10532
Exp. 4/30/2018

Honolulu, Hawaii
October 26, 2017
TMK: (1) 4-5-033:001
X:\PROJECTS\HHF\HMP\DWG\171020_LUC_Bound\Desc\HMP-LUC.doc