

**SHEET NOTES**  
 1. LOCATIONS SHOWN ARE FOR GENERAL GUIDANCE ONLY. SLOPES OF THE SITE ARE NOT TO BE CONSIDERED. CONDITIONS MUST BE VERIFIED ON SITE BEFORE INSTALLATION.

**REVAMP**  
 ENGINEERING, INC.  
 360 Ly Street, #5  
 San Francisco, CA 94102  
 www.revamp-eng.com

THIS DOCUMENT IS THE PROPERTY OF REVAMP ENGINEERING, INC. AND CONTAINS CONFIDENTIAL INFORMATION. IT IS RETURNED OR DESTROYED UPON REQUEST OR PERMISSION DOES NOT IMPLY DESCRIBE. NO PART IS TO BE REPRODUCED OR TRANSMITTED IN ANY FORM OR BY ANY MEANS, ELECTRONIC OR MECHANICAL, INCLUDING PHOTOCOPYING, RECORDING, OR BY ANY INFORMATION STORAGE AND RETRIEVAL SYSTEM, WITHOUT THE WRITTEN PERMISSION OF REVAMP ENGINEERING, INC.



**PROJECT NAME**  
**WAIPIO SOLAR**

**SITE LOCATION**  
 MILILANI, HI  
 21°27'15.94"N, 157°59'4.25"W

DRAWING ISSUE
06/20/16
1 PRELIMINARY
06/04/2017
10 SURVEYED BOUNDARY
06/10/2017
11 NEW SITE BOUNDARY

**REVISION ISSUE**

DRAWN BY: CB CHECKED BY: KS  
 PROJECT NO.: 16029  
 DRAWING TITLE  
**OVERALL SITE LAYOUT**

**DRAWING NUMBER**  
**E2000**

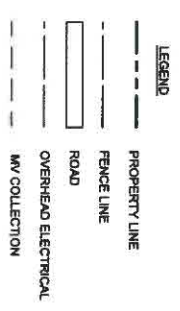

**1 OVERALL SITE LAYOUT**  
 1" = 300'-0"  
 0' 150' 300' 500'

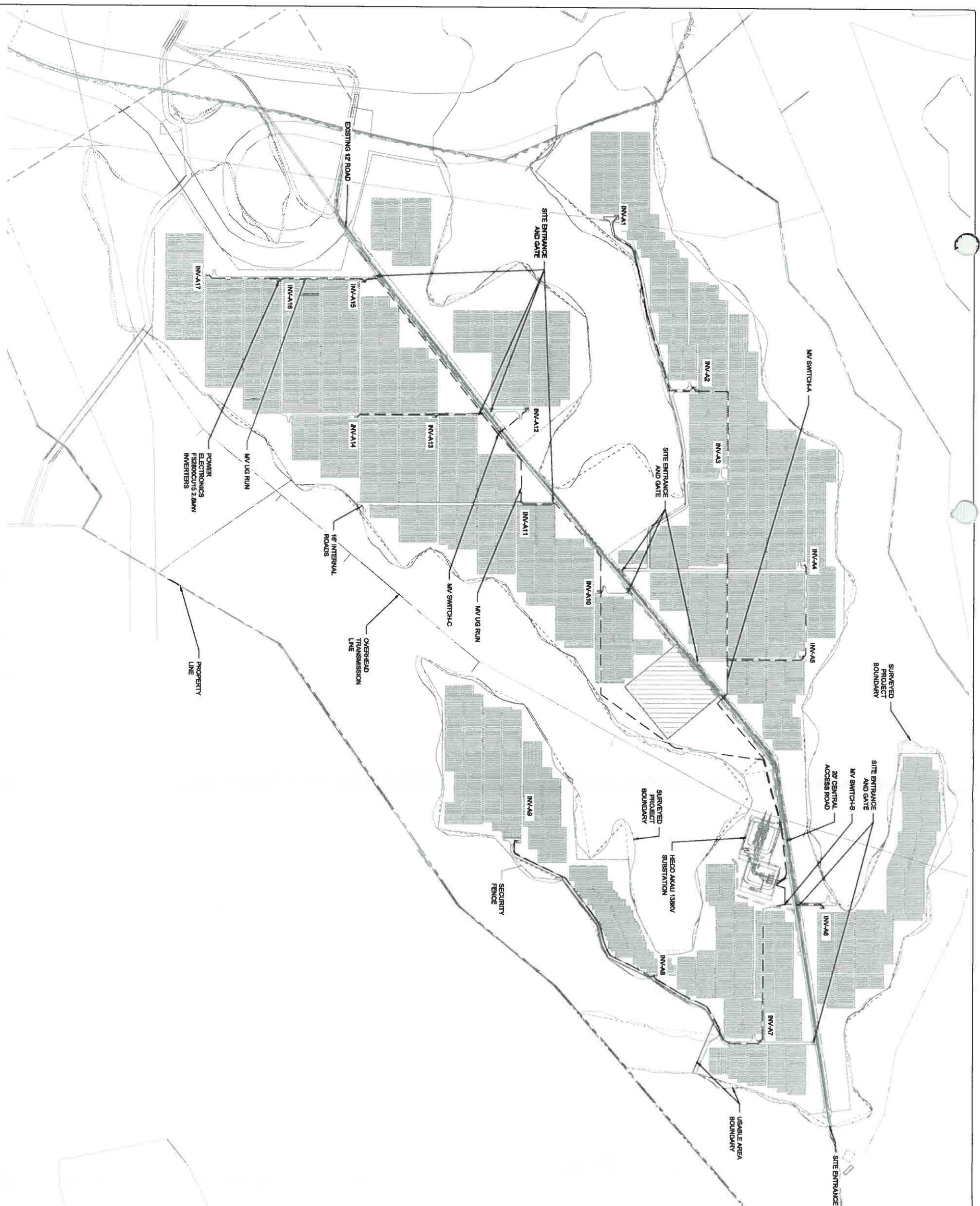

**PRELIMINARY - NOT FOR CONSTRUCTION**