

BENJAMIN M. MATSUBARA
MERVYN M. KOTAKE
CURTIS T. TABATA
WYETH M. MATSUBARA
KOJI KATO

MATSUBARA ■ KOTAKE

Attorneys At Law
A Law Corporation
CHARLES R. KENDALL BUILDING
888 MILILANI STREET, EIGHTH FLOOR
HONOLULU, HAWAII 96813
E-MAIL: ctabata@m-klawyers.com

TELEPHONE
(808) 526-9566

FACSIMILE
(808) 538-3840

January 9, 2013

HAND DELIVERY

Mr. Daniel E. Orodener, Executive Officer
Land Use Commission, State of Hawai'i
235 South Beretania Street
Room 406, Leiopapa A Kamehameha Bldg.
Honolulu, Hawai'i 96813

Re: DR12-48; Grove Farm Company, Incorporated

Dear Mr. Orodener:

Please find attached hereto Petitioner Grove Farm Company, Incorporated's revised Exhibit D-2. The exhibit was revised to adjust the boundaries of the proposed important agricultural lands in relation to the tax map.

Very truly yours,

MATSUBARA - KOTAKE



Curtis T. Tabata

Enclosure

LAND USE COMMISSION
STATE OF HAWAII
2013 JAN -9 P 2:45

- 6 Kumao Fujii & wf. Matsuyo - 4/1
Kiichi Fujii - Rdm.
- 7 Isaac W. Kaku, Jr. & wf. Gladys Y. TIE
- 8 Martin H. Steeles, Jr.
- 9 Alexander G. Ruiz & wf. Yasue F. Tz.
- 11 & 10 Serapion S. Javier & wf. Margaret B. - 4/1
- 13 WILLIAM H. WALLACE & wf. LAURIE JEAN - T/C
CHARLES P. STACK & wf. KATHERINE ELIZABETH
WAHIOHONU FARMS 11,524 Ac.
- 14 Grove Farm Inc.
(McBryde Sugar Co., Ltd.) 1/16
(0.459 Ac.)
- 18 Rae L. Hiramoto
William H. Wallace - J/T
- 19 Yasuo Matsumoto Tr.

Adjust proposed IAL boundary to follow center line of stream / TMK boundary

Adjust proposed IAL boundary to follow edge of field road.

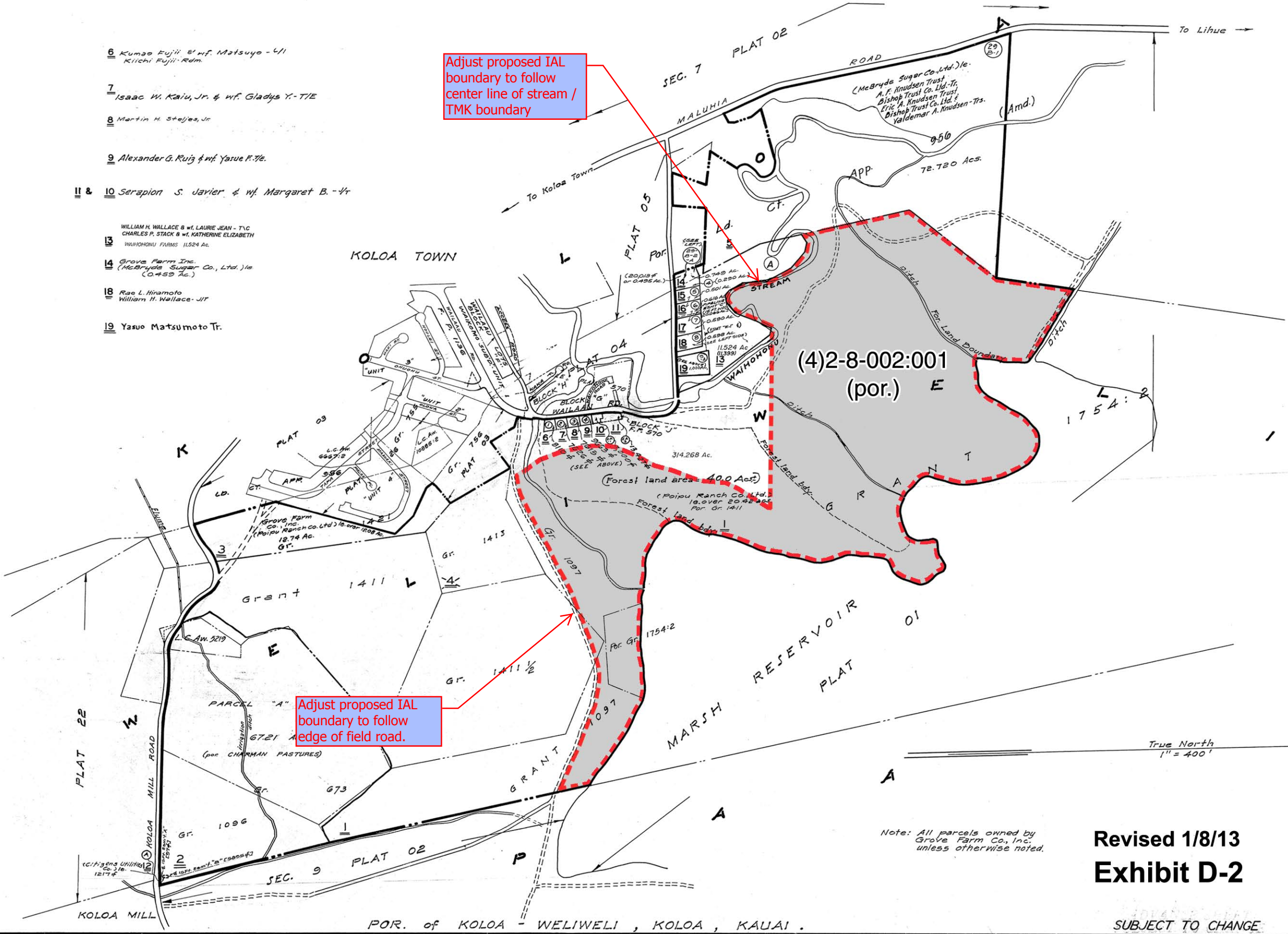

Note: All parcels owned by Grove Farm Co., Inc. unless otherwise noted.

Revised 1/8/13
Exhibit D-2

TAXATION MAPS BUREAU		
TERRITORY OF HAWAII		
TAX MAP		
FOURTH	DIVISION	
2	8	02
CONTAINING 5 PARCELS		
SCALE: 1 in. = 400 ft		

SUBJECT TO CHANGE

POR. of KOLOA - WELIWELI, KOLOA, KAUAI.

Parcels Dropped: 11, 4,